

DO NOT SCALE

IF IN DOUBT ASK



Revisions

Rev	Description	Date	Approved

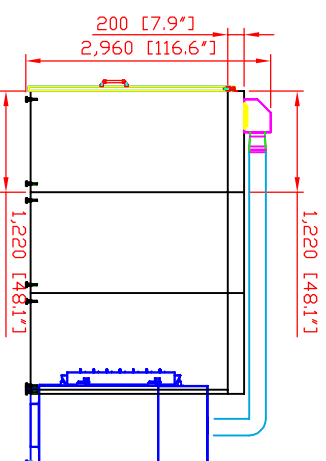
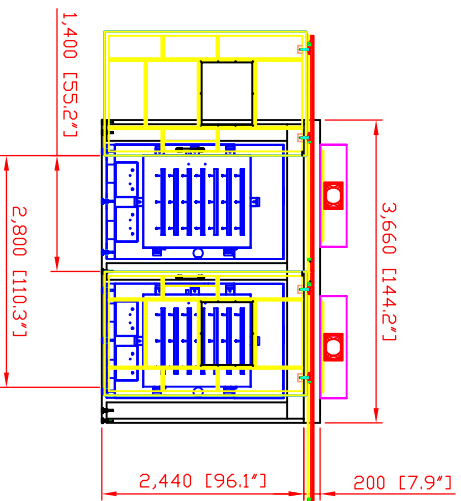
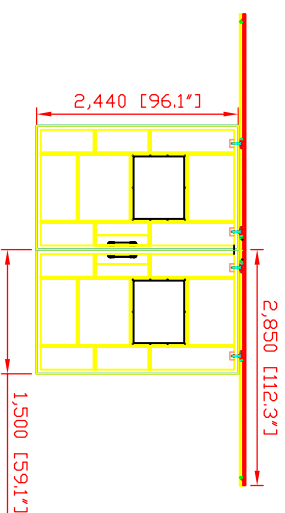
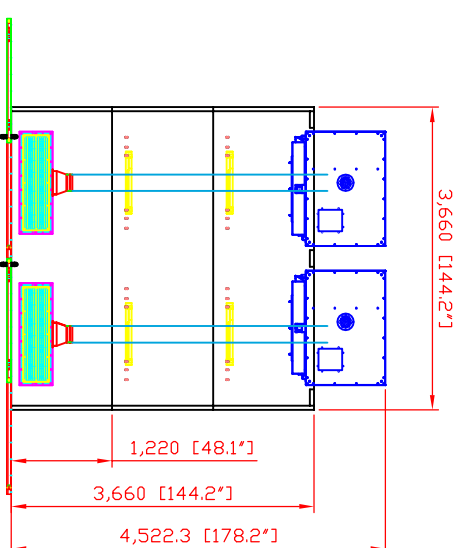
**WB-12x12x8G GRINDING BOOTH SPECIFICATIONS**

- Top Panel Dimensions: 144.2" x 144.2" x 7.9"
- Side Panel Dimensions: (6) 116.6" x 48.1"
- Working Lights: (4) Explosion Proof Lights (110V, Single Phase, 60 Hz, 20W)
- Support Structure: 1 1/2" x 4" steel stock welded
- Panel Construction: 12-gauge welded steel double wall with sound insulation foam.
- Powder Coated: Avani Safety Blue Standard (custom colors available)
- Fifteen Piece Configuration: (6) side panels, (4) back panel, (3) Top hood, (2) Front doors
- Booths can be mounted back-to-back, side-to-side or both options
- Electrical Outlets: (2) 110V Outlets @ (1) Switch (additional single or three phase outlets available)
- Light Switch: For overhead lights
- CO2 or Gas Connection: (additional gas lines or compressed lines available)

OPTIONS

- Welded Nuts: Optional locations for J-Hooks
- Welding Nuts: For wire feeder or welder bracket
- Adjustable Rear Shelf (solid, grated or cutting table)
- Corner Shelves
- Viewing Windows
- Custom Welding Brackets
- Foot Lockers
- Fixtures, Lazy Suzans
- Any option that can fit inside the booth or on the booth

PRELIMINARY

Part Number:

REVISION B

Title:

WB-12x12x8G

Name

Date

2015-04-28

Part Number:

Title:

Size

C

Scale

1 = 35

Drawing Number:

JBT-WOLFTech

Page 1 of 1

Page 1 of 1

AVANI ENVIRONMENTAL INTL. INC. Sales Department
 95 Cypress Drive
 Youngsville, NC 27596

(919) 570-2862
 info@avanienvronmental.com

The drawings, AutoCAD, 3-D Models, and specifications are the property of Avani Environmental Intl. Inc. (AE) and may not be reproduced, distributed, modified, or otherwise used, except provided herein, without the express written permission of AE.