

DO NOT SCALE

IF IN DOUBT ASK

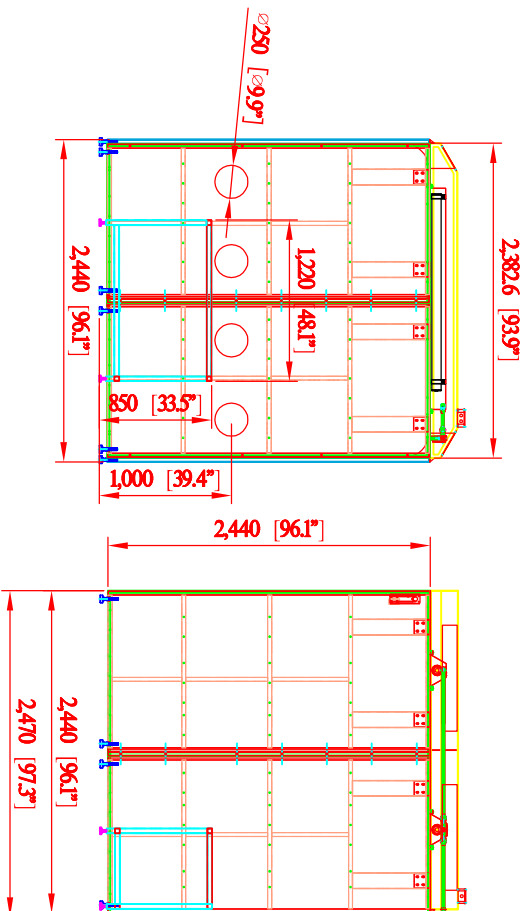

Revisions			
Rev	Description	Date	Approved

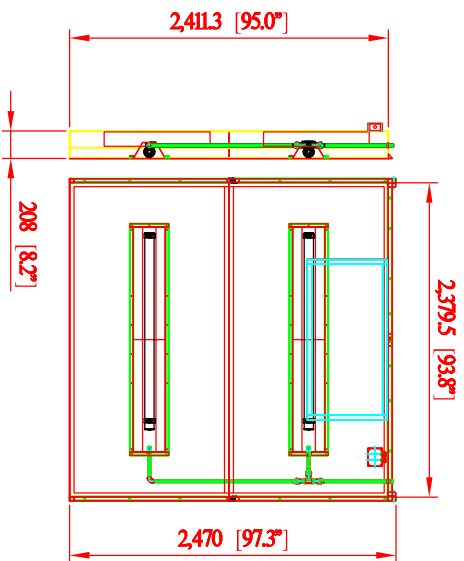

WB-8x8x8 WELDING BOOTH SPECIFICATIONS

- Hood Dimensions: 97.3" x 93.9" x 8.2"
- Back Panel Opening: 10" x 4 ports
- Recessed Lights: (2) Explosion Proof Lights (110V, Single Phase, 60 Hz, 20W)
- Support Structure: 1 1/2" x 4" steel stock welded
- Panel Construction: 12-gauge welded steel single wall with cross and up bracing.
- Rear Support: (2) 12" x 31" 30 degree gussets for overhead piping and accessories.
- Welding Curtain Supports: (2) adjustable welding curtain brackets
- Lifting Lugs: (4) Hood mounted lifting lugs to set and move hood or booth
- Powder Coated: Avani Safety Blue Standard (custom colors available)
- Eight Piece Configuration: (4) side panels, (2) back panel, (2) top hood assembly.
- Booths can be mounted back-to-back, side-by-side or both options
- Electrical Outlets: (2) 110V Outlets @ (1) Switch (additional single or three phase outlets available)
- Light Switch: For overhead lights
- Double Wall Construction (welded)
- (1) Working table

PRELIMINARY

Part Number:

Title:

REVISION A

WB-8X8X8

Date

Name

Part Number:

Title:

Scale

Drawing Number:

Page 1 of 1

Drawn by:

2015.05.08

REVISION A

Scale

1 = 35

Drawing Number:

Page 1 of 1

AVANI ENVIRONMENTAL INTL. INC. Sales Department

95 Cypress Drive

Youngsville, NC 27596

(919) 570-2862

info@avanienviromental.com

The drawings, AutoCAD, 3-D Models, and specifications are the property of Avani Environmental Intl. Inc. (AE) and may not be reproduced, distributed, modified, or otherwise used, except provided herein, without the express written permission of AE.

Size

Scale

1 = 35

Drawing Number:

Page 1 of 1