

DO NOT SCALE

IF IN DOUBT ASK

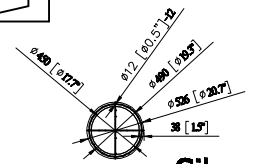

Revisions			
Rev	Description	Date	Approved



Silencer Outlet

PLAN DETAIL

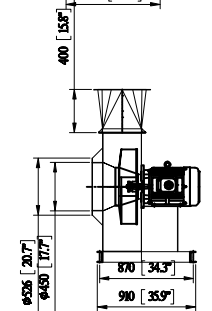
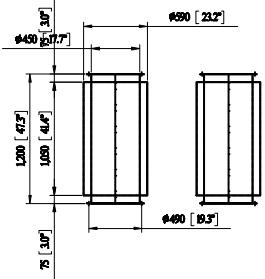
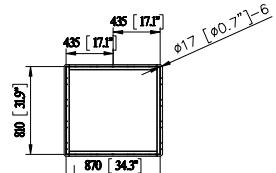

Blower

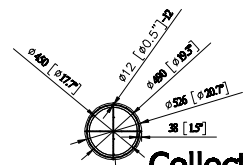
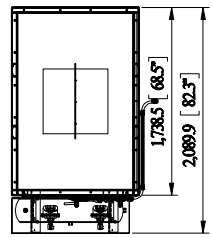
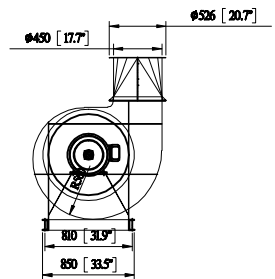

Collector Inlet

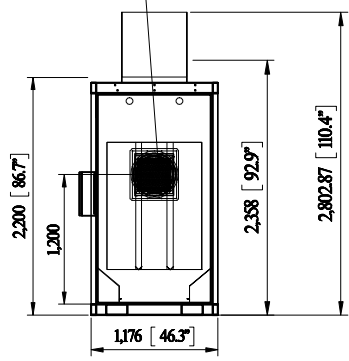
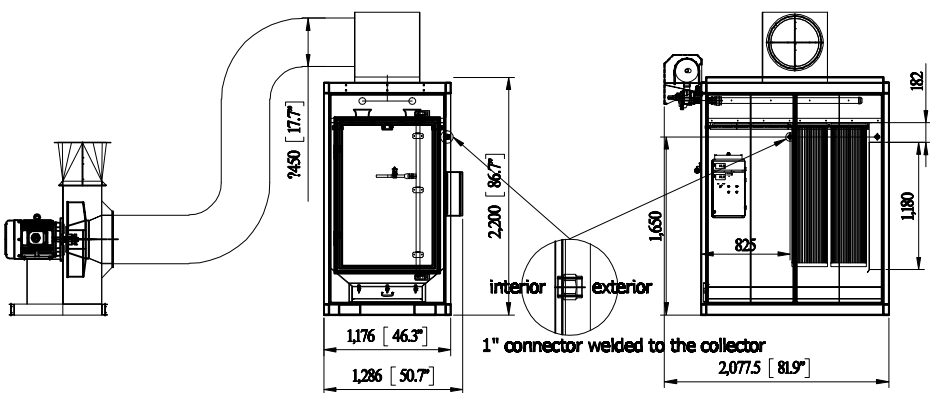

- SDC-20G-8MD SPECIFICATION -

- Direct Drive Blower (on the ground)
- Motor: 20HP x 1 pc
- CFM: 8,000 ft<sup>3</sup>/min @ 6" SP
- Include:
  - UL Individual Control Box for Cartridge Collector and Blower
- \*\*\*Inlet: 450mm (17.7")
- Cartridge Filter: Dia. 325mm x 1320mm x 8pcs (Dia. 12.8" x 52" x 8pcs)
- Material: Polyester with TEFLON coating.
- Filter Area: 19m<sup>2</sup> x 8 = 152m<sup>2</sup> (1635.52 ft<sup>2</sup>)
- Pleat Depth: 48mm
- Horizontal Positioned Filters, Continuous Welded Seams, Gasket and Latched Doors, Powder Coated Paint and Reverse Jet Pulse Cleaning
- Include:
  - Filter Chamber
  - Inlet Square Pipe (need dimensions)
  - Fan/motor combination
- No. of Valves: 2
- Inlet Air: 3/4"
- Compressed Air Requirement: 90 PSI
- Compressed Air Reservoir: 7.9 gallon
- Dimension: 50.7" x 81.9" x 110.4" (1286 x 2077.5 x 2802.87mm)
- Construction: 13 Gauge for panel; 11 Gauge Steel Cabinet
- Max. Operating Temp.: 120 °C
- Paint Color: Blue
- \*\*\*w/ silencer\*\*\*
- \*\*\*(1) control panel controls pulse system and blower.

AVANI ENVIRONMENTAL INTL. INC. Sales Department  
 95 Cypress Drive (919) 570-2862  
 Youngsville, NC 27596 info@avanienvironmental.com

Drawn by:	Date	Name	Part Number:
Checked by:	2011-12-06	***	SDC-20G-8MD

The drawings, AutoCAD, 3-D Models, and specifications are the property of Avani Environmental Intl. Inc. (AE) and may not be reproduced, distributed, modified, or otherwise used, except provided herein, without the express written permission of AE.

Title:		Drawing Number:
Cartridge Collector (mezzanine drawer type)		
Size	Scale	***
A	1 = 45	