

Robotic Cell Airflow details

End View looking at door

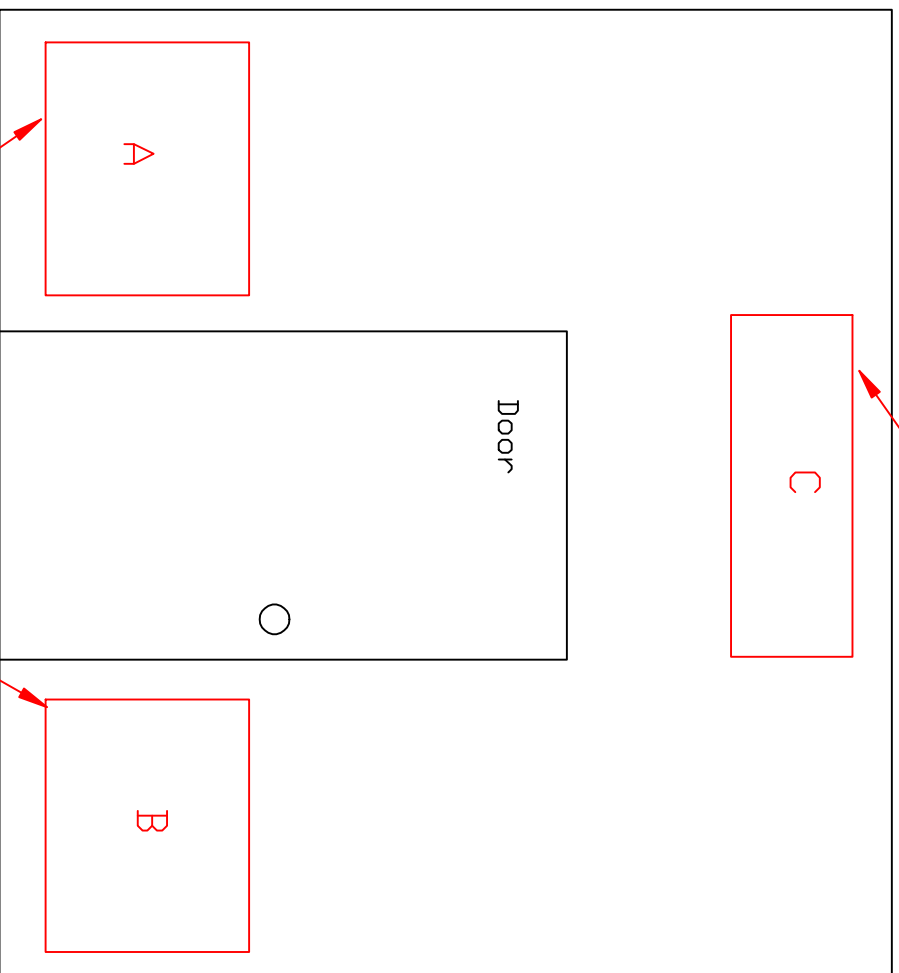

Pick up Point above door,
8" high by 20" wide

Pick up point on floor
20" wide by 20" high

Notes:
A) Dust collector
7500 CFM
B) Roll media before
dust collector to
capture oily smoke
C) Spark Eliminator
before collector to
eliminate sparks.

Avani Environmental Intl. Inc.
95 Cypress Drive 27596
Youngsville, NC
PH 919-570-2862 F# 919-570-2863

Avani

Project: Johnson Controls

Drawing: Test cell layout

Date: 3/13/12 | Drawn by: RAV

Sheet No: 2 of 2