

Oskar Air Products
 Self Supporting Fume Arm
 model: W02011630

Diameter: 6" / 160mm
 Length: 10' / 1970mm
 Weight:

Arm Construction: two galvanized steel tubes, three pieces of flex hose at joints, aluminum external joints, powder coated, aluminum hood, heavy gauge steel swivel base.

Arm Adjustments: externally supported, adjustments quickly done at the joints.
Hood: 12" / 305mm dia round aluminum hood
Damper: Internal with outside adjustment

Finish: powder coated
Hose: rated at 200 degrees F / 95C
Accessories: mounting bracket
Warranty: limited two-year warranty from date of purchase

This shop drawing has been reviewed for general design, arrangements and conformance to the contract documents. Observed discrepancies are noted. All dimensions and suitability for site conditions are the responsibility of the contractor. All electrical characteristics must be coordinated with other trades. This review of the shop drawings shall not, in any way, relieve the contractor from complying with all requirements.

DATE: Nov 7th, 2011
 PROJECT NO. KFR 11028
 SHOP DRAWING NO. KFR 11028-03
 CHECKED BY: MJL
 REVIEWED AS NOTED:
 REVISE AND RESUBMIT:
 KFR ENGINEERING LTD.

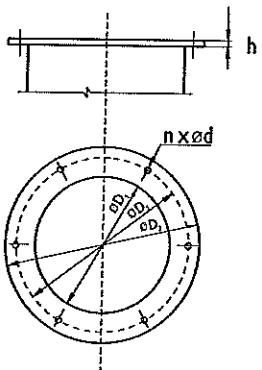
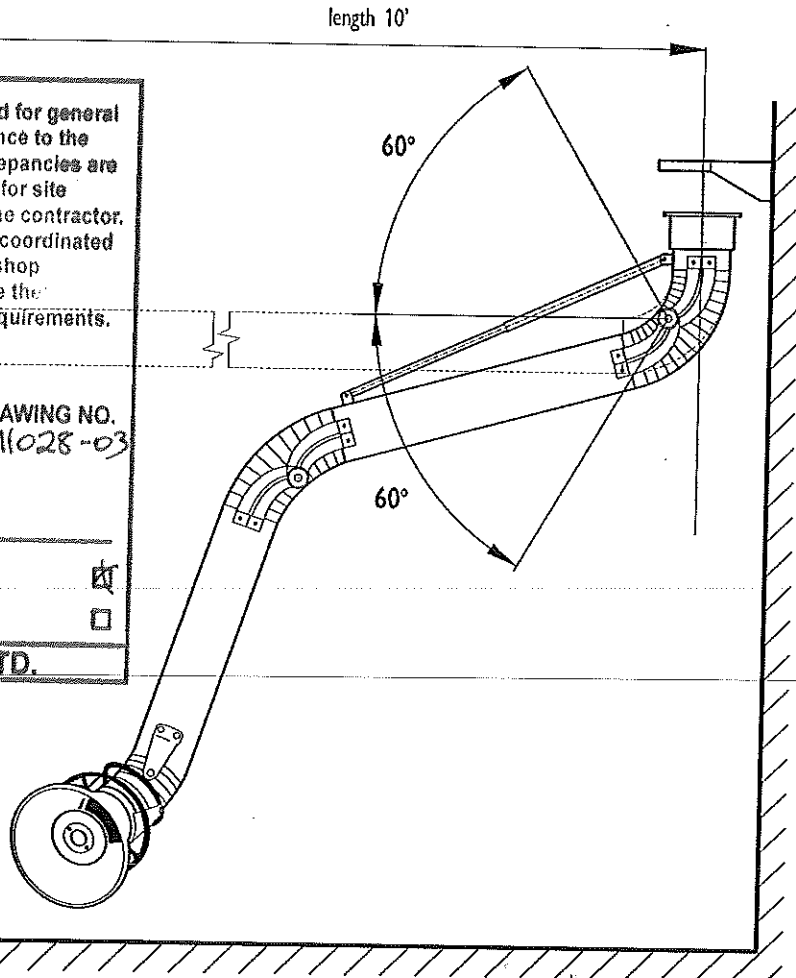

Oskar Fume Arm Mounting Flange

n	d [inch] / [mm]	D1 [inch] / [mm]	D2 [inch] / [mm]	D3 [inch] / [mm]	h [in.] / [mm]
6	0.28 / 7	6.02 / 154	7.68 / 195	8.66 / 220	0.26 / 9



MECHANICAL SERVICES INC.

8047 CORONET ROAD
 EDMONTON, AB T6E 4N7
 PH: (780) 496-9479 FAX: (780) 436-8011

ECOLE MAURICE LAVALLE WELDING LAB
 EDMONTON, ALBERTA
 KFR ENGINEERING
 WEB MECHANICAL SERVICES INC.
 ENERGY TECHNOLOGY PRODUCTS LTD.
 1 OF 1630 FUME ARM AND WSD-160 MOUNTING BRACKET



www.oskarairproducts.com
 info@oskarairproducts.com



Oskar Air Products
www.oskarairproducts.com

Mounting Bracket WSD 160
Cat. #: P07-01-0013

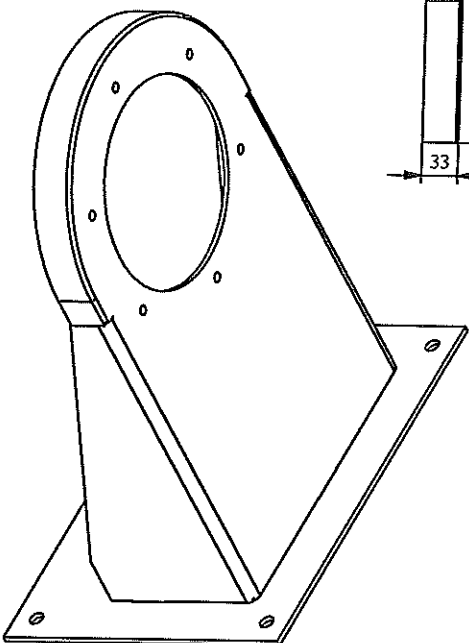
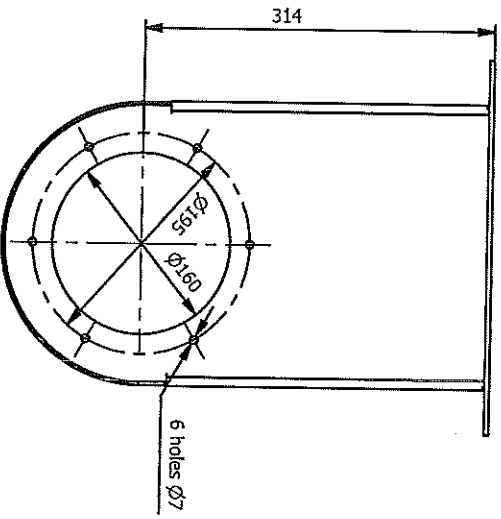
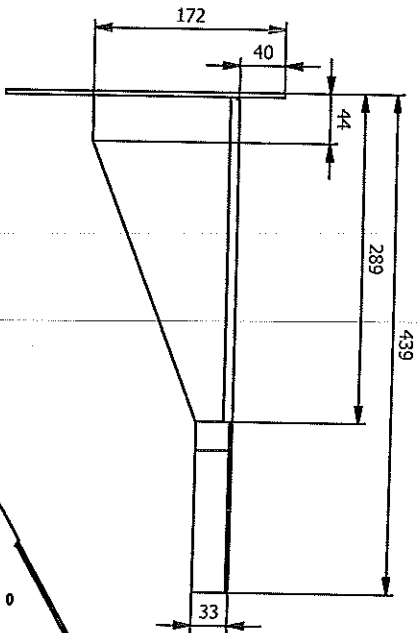
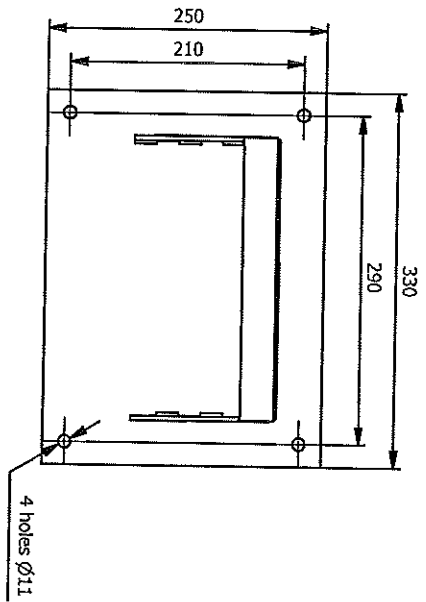

ECOLE MAURICE LAVALLE WELDING LAB
EDMONTON, ALBERTA
KFR ENGINEERING
WEB MECHANICAL SERVICES INC.
ENERGY TECHNOLOGY PRODUCTS LTD.
1 OF 1630 FUME ARM AND WSD-160 MOUNTING BRACKET

DO NOT SCALE IF IN DOUBT ASK

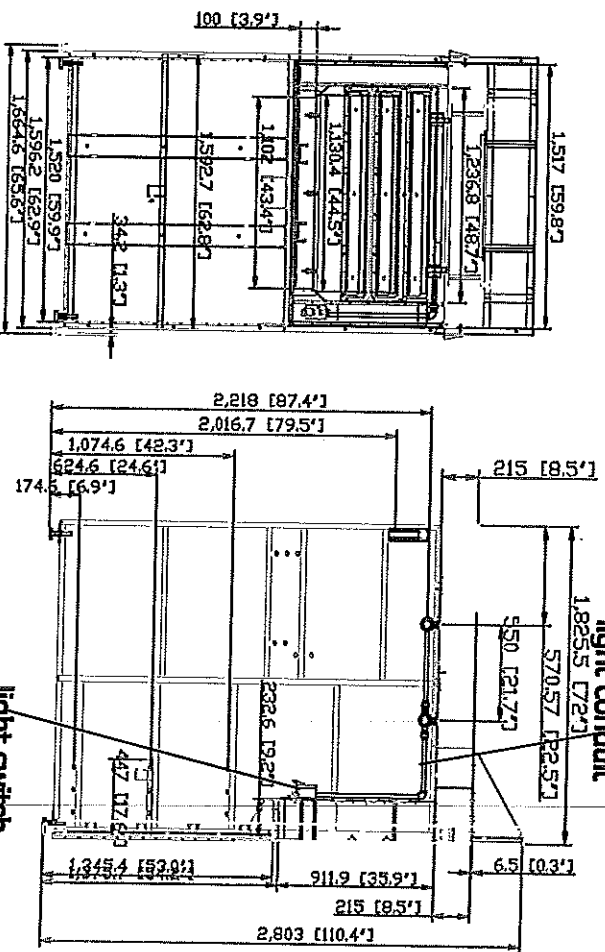
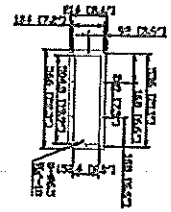
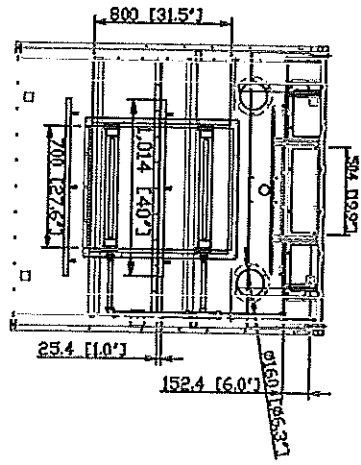

Rev	Description	Date	Approved

- Welding Booth (DW walls) WELDING BOOTH SPECIFICATIONS
- Hood Dimensions: 60" x 72" x 8.5"
- Back Draft Dimensions: 48.7" x 35.9" x 9.2" (incl. clean out drawer)
- Hood Inlet Opening: 6" x 19.9" (119.4 square inches)
- Hood Service Panel: Removable 27.6" x 31.5" service panel
- Back Draft Adjustable Inlet Slot: (3) 1" x 44.5"
- Hood Adjustable Inlet Slot: (2) 1" x 48"
- Overhead Light: (2) Explosion Proof Lights (110V, Single Phase, 60 Hz, 20W, non-arcable)
- Adjustable Hood: (15) 2 1/2" Five Star Ticks
- Clean Out Drawer: 3.9" x 43.4" (11) with (3) hand hole locks
- Adjustable Level System: (6) 2 1/2" Feet (maximum adjustment 5")
- Support Structure: 1 1/2" x 4" steel stock welded
- Panel Construction: 12-gauge welded steel angle wall with cross and up backing
- Rear Support: (2) 12" x 19" 30 degree gusset for overhead piping and accessories
- Welding Cush Support: (2) adjustable welding curtain brackets
- Lifting Lugs: (4) Hood mounted lifting lugs to set and move hood or booth
- Fume Arm Cover Release: (2) cover plates (6 lock pattern) to match optional 60" fume arm
- Fume Arm Cover Safety Release Standard (Custom colors available)
- Fume Arm Configuration: (2) side panels, (1) back panel, (2) backdraft assembly, (2) hooddraft assembly.
- Booths can be mounted back-to-back, side-by-side or both options
- Adjustable Weld Construction (welded)
- Adjustable Back Shaker: 62.7" W x 12.6" D x 1.1" H (with 2 1/2" Five Star Ticks)
- Light Conduit
- Light Switch

No Hole

Job: Ecole Maurice LaVallee Welding Lab
 Location: Edmonton, Alberta
 Engineer: KFR Engineering
 Contra: Web Mechanical Services Inc.
 Supplier: Energy Technology Products LTD

AVANI ENVIRONMENTAL INTL. INC. Sales Department
 95 Cypress Drive
 Youngsville, NC 27596
 (919) 570-2862
 info@avanientl.com

Date	Name
11 / 31 / 2011	RAV

Title: WB-5056 (DW walls)
 Scale: 1 = 35
 Drawing Number: WB-5-6 standard
 The drawings, AutoCAD, 3D Models, and specifications are the property of Avani Environmental Int'l. Inc. (AE) and may not be reproduced, distributed, modified, or otherwise used, except provided herein, without the express written permission of AE.

DO NOT SCALE

IF IN DOUBT ASK



Revisions		
Rev	Description	Appr'd

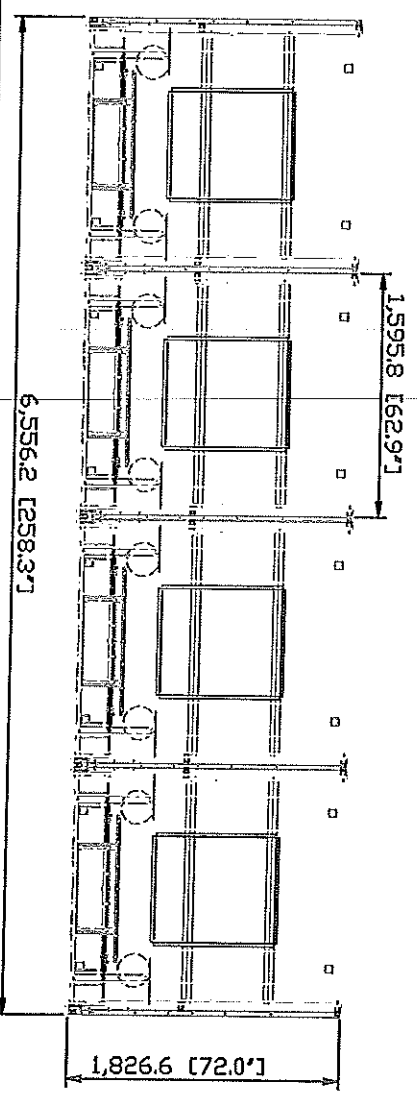
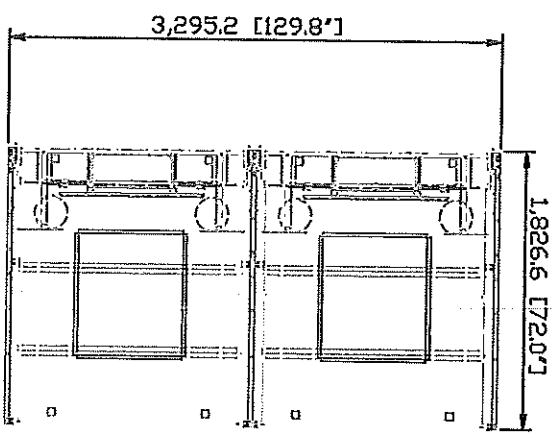

Job: Ecoke Maurice LaVallee Welding Lab
 Location: Edmonton, Alberta
 Engineer: KFR Engineering
 Contra: Web Mechanical Services Inc.
 Supplier: Energy Technology Products LTD

AVANI ENVIRONMENTAL INTL. INC. Sales Department
 95 Cypress Drive
 Youngsville, NC 27596
 (919) 570-2862
 Info@avanienvironmental.com

Date	Name
11 / 3 / 2011	***

Drawn by: RAV
 Checked by: RAV
 Title: **

Size: A
 Scale: 1 = 40
 Drawing Number: WB-5056 (DW walls)

The drawings, AutoCAD, 3-D Models, and specifications are the property of Avani Environmental Int'l. Inc. (A/E) and may not be reproduced, distributed, modified, or otherwise used, except provided herein, without the express written permission of A/E.

WB-5-6 standard