



Date: May 13, 2015

To: Carrigan

Project:

Attn:

Recommended Equipment:

- (17) WB-1066 welding booth (side by side)
- (17) Backdraft hoods: 5' x 4.5'
- (1) Fan: DBN300 w/ 12,000 CFM
- (1) Fan: DBN400 w/ 15,000 CFM

- (1) Torch track Downdraft table: SST-5TPx2
- (1) ECO-2000 Drawer type dust collector
- (1) Plasma CAM system: PS-150 w/ RM-150E and DP66

- (1) Grinding room: GR-17x15x8
- (2) SAU-X5 Ambient Cartridge collector

Avani Environmental Intl. Inc.
95 Cypress Drive
Youngsville, NC 27596
www.avanienvironmental.com

Phone: (919) 570-2862
Fax: (919) 570-2863
Email: info@avanienvironmental.com
www.weldingbooths.com

The drawings, AutoCAD, 3-D Models, and specifications are the property of Avani Environmental Intl. Inc. (AE) and may not be reproduced, distributed, modified, or otherwise used, except provided herein, without the express written permission of AE.

Revisions			
Rev	Description	Date	Approved

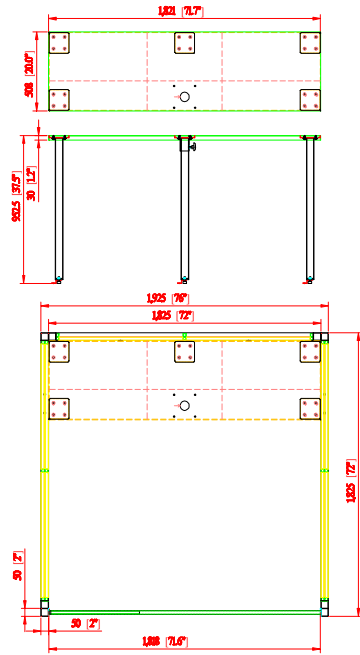

- WB-1066 WELDING BOOTH SPECIFICATIONS**
- Adjustable Level System: (4) dia. 2.36" Feet
 - Panel Construction: 11-gauge welded steel
 - Welding Curtain Supports: (1) set welding curtain bar
 - Fume Arm Base Supports: (1) to match an optional bracket (6 bolt pattern) and an optional dia. 6" fume arm
 - Powder Coated: Avani Safety Blue Standard (custom colors available)
 - Three Piece Configuration: (2) side panels, (1) back panel.
 - Booths can be mounted back-to-back, side-by-side or both options
 - Non-adjustable Working table: 71.7"W x 20"D x 37.5"H

- OPTIONS**
- Welded Nuts: Optional locations for J-Hooks
 - Welding Nuts: For wire feeder or welder bracket

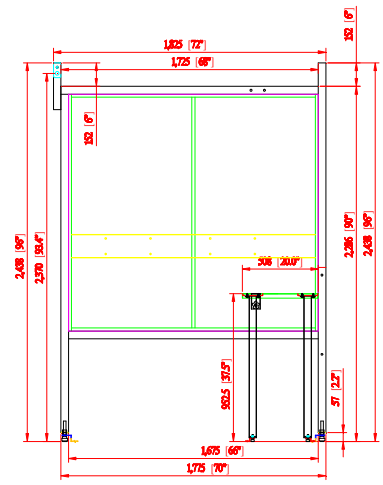
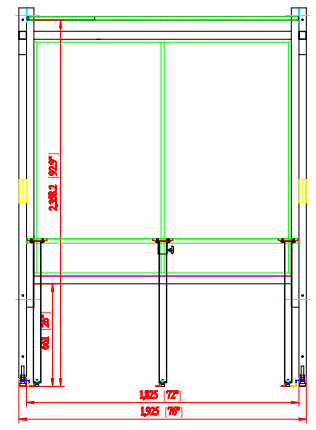

PRELIMINARY

AVANI ENVIRONMENTAL INTL. INC. Sales Department
 95 Cypress Drive
 Youngsville, NC 27596
 (919) 570-2862
 info@avanienvironmental.com

Drawn by:	Date:	Name:	Part Number:
Checked by:	2015-04-17	***	REVISION A

Title: WB-1066 Welding Booth

The drawings, AutoCAD, 3-D Models, and specifications are the property of Avani Environmental Intl. Inc. (AE) and may not be reproduced, distributed, modified, or otherwise used, except provided herein, without the express written permission of AE.	Size: A	Scale: 1 = 25	Drawing Number: CCC WB-1066 Page 1 of 1
--	---------	---------------	--

DO NOT SCALE

IF IN DOUBT ASK



Revisions			
Rev	Description	Date	Approved

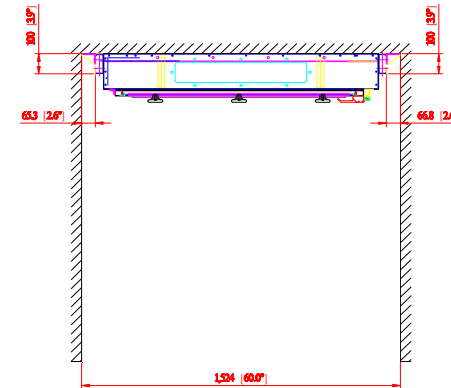
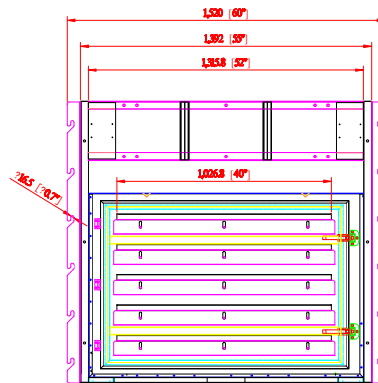
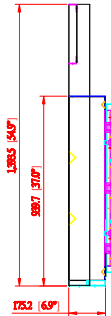
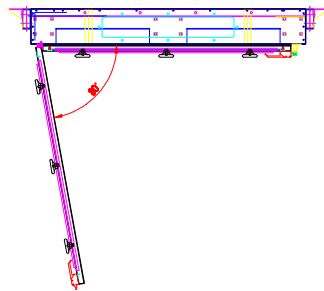
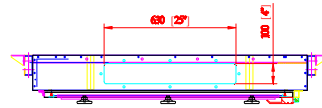
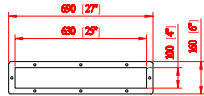

PRELIMINARY

AVANI ENVIRONMENTAL INTL. INC. Sales Department
 95 Cypress Drive (919) 570-2862
 Youngsville, NC 27596 info@avanienvironmental.com

Drawn by:	Date	Name	Part Number:
Checked by:	2015-04-17	***	REVISION A

The drawings, AutoCAD, 3-D Models, and specifications are the property of Avani Environmental Intl. Inc. (AE) and may not be reproduced, distributed, modified, or otherwise used, except provided herein, without the express written permission of AE.

Title:		Backdraft Hood: 5' x 4.5'
Size	Scale	Drawing Number:
A	1 = 15	CCC WB-5-4.5-IBB Page 1 of 1

DO NOT SCALE

IF IN DOUBT ASK

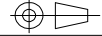

Revisions			
Rev	Description	Date	Approved

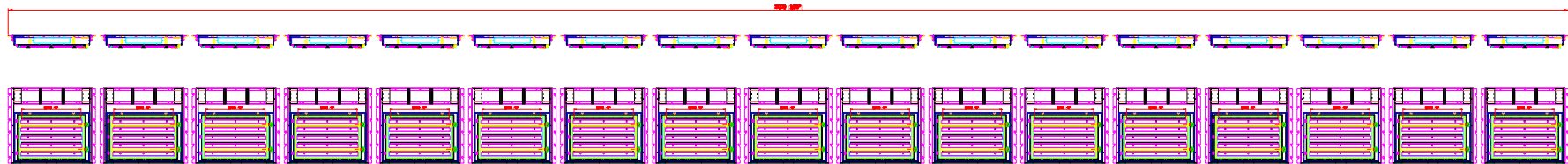

PRELIMINARY

AVANI ENVIRONMENTAL INTL. INC. Sales Department 95 Cypress Drive Youngsville, NC 27596 info@avanienvironmental.com	Date 2015-04-17	Name ***	Part Number: REVISION A	Title: Backdraft Hood: 5' x 4.5' Layout	
	Drawn by:	Checked by:		Size A	Scale 1 = 15
	The drawings, AutoCAD, 3-D Models, and specifications are the property of Avani Environmental Intl. Inc. (AE) and may not be reproduced, distributed, modified, or otherwise used, except provided herein, without the express written permission of AE.				

DO NOT SCALE

IF IN DOUBT ASK

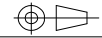

Revisions

Rev	Description	Date	Approved

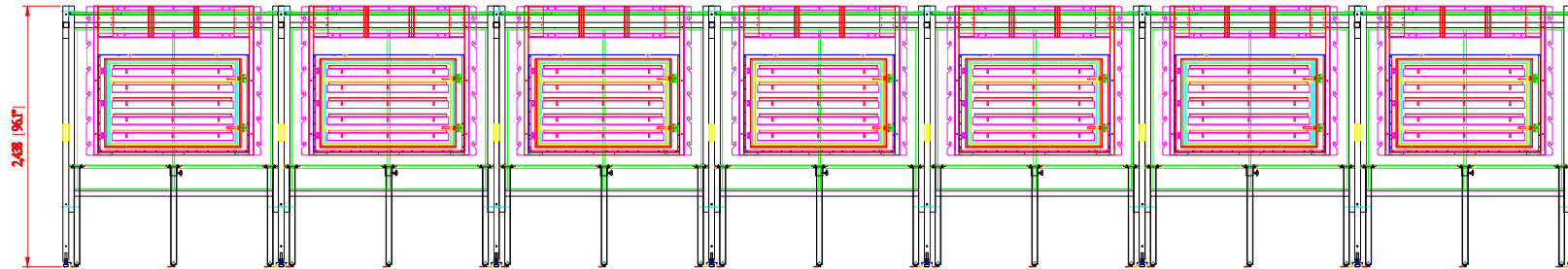
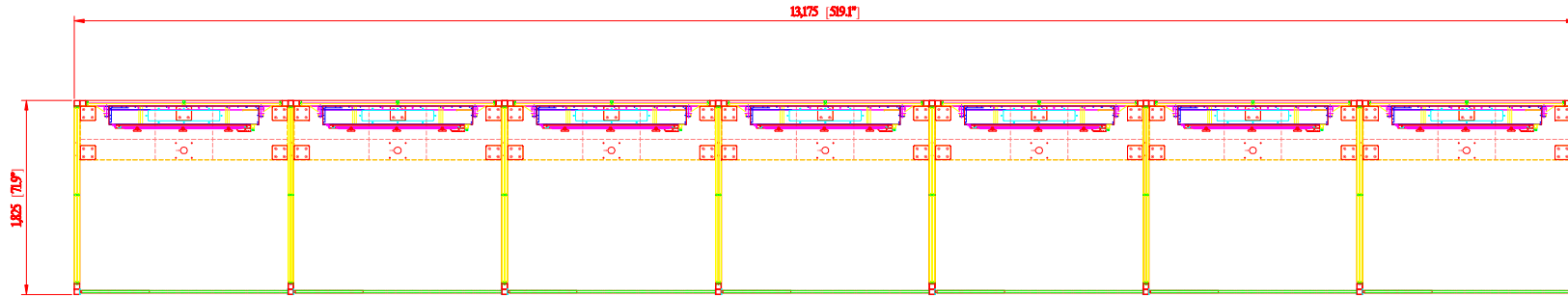

PRELIMINARY

AVANI ENVIRONMENTAL INTL. INC. Sales Department
 95 Cypress Drive
 Youngsville, NC 27596
 (919) 570-2862
 info@avanienvironmental.com

Drawn by:	Date	Name	Part Number: REVISION A
Checked by:	2015-04-17	***	

The drawings, AutoCAD, 3-D Models, and specifications are the property of Avani Environmental Intl. Inc. (AE) and may not be reproduced, distributed, modified, or otherwise used, except provided herein, without the express written permission of AE.

Title:
**CCC WB-1066 w/Backdraft Layout
 7 booths (side-by-side)**

Size A	Scale 1 = xx	Drawing Number: CCC WB-1066 w/Backdraft Layout Page 1 of 2
------------------	-----------------	--

DO NOT SCALE

IF IN DOUBT ASK

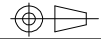

Revisions			
Rev	Description	Date	Approved

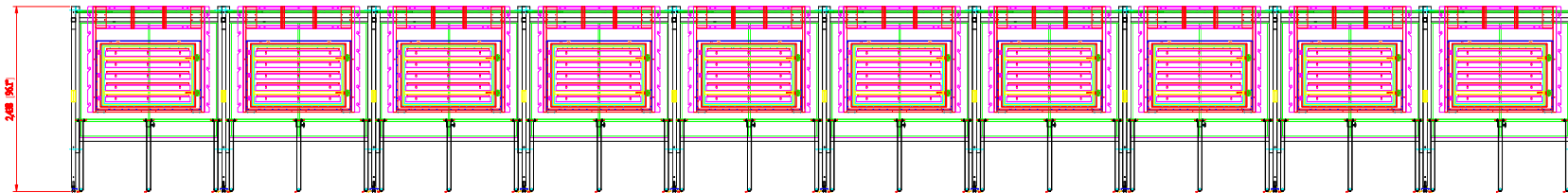
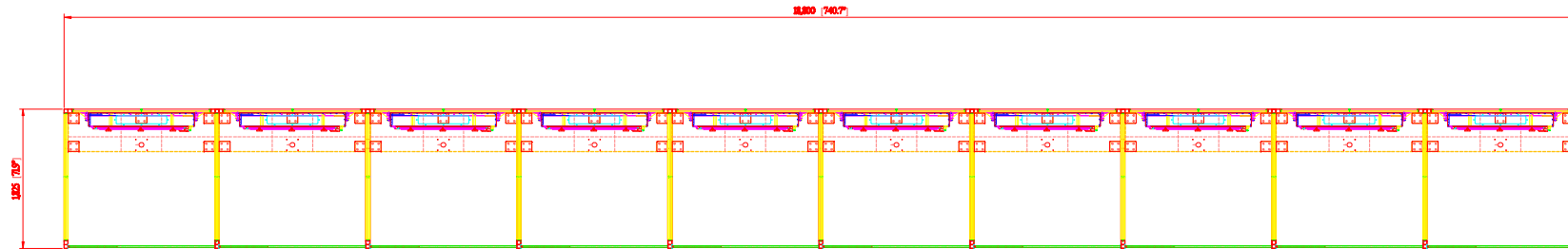

PRELIMINARY

AVANI ENVIRONMENTAL INTL. INC. Sales Department
 95 Cypress Drive
 Youngsville, NC 27596

(919) 570-2862
 info@avanienvironmental.com

Drawn by:	Date	Name	Part Number: REVISION A
Checked by:	2015-04-17	***	

The drawings, AutoCAD, 3-D Models, and specifications are the property of Avani Environmental Intl. Inc. (AE) and may not be reproduced, distributed, modified, or otherwise used, except provided herein, without the express written permission of AE.

Title:
**CCC WB-1066 w/Backdraft Layout
 10 booths (side-by-side)**

Size A	Scale 1 = xx	Drawing Number: CCC WB-1066 w/Backdraft Layout Page 2 of 2
------------------	-----------------	--

DO NOT SCALE

IF IN DOUBT ASK

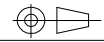

Revisions			
Rev	Description	Date	Approved

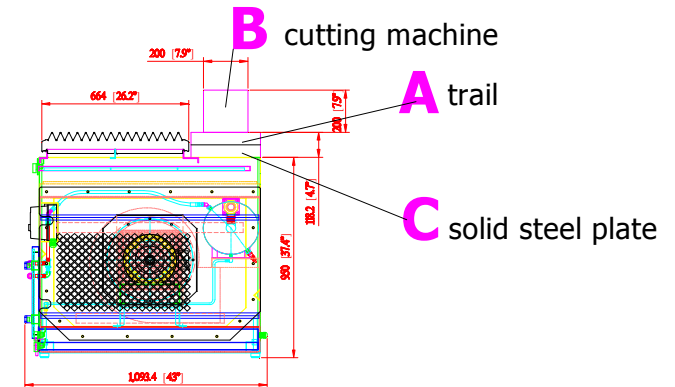
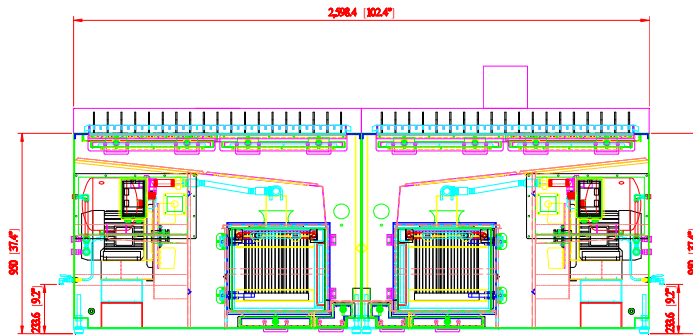
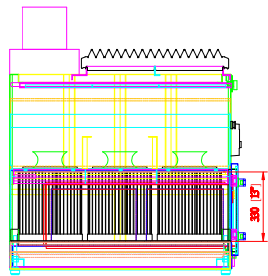
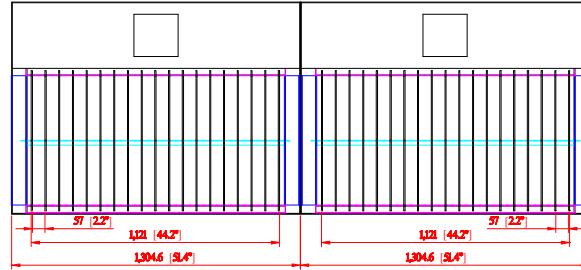

PRELIMINARY

AVANI ENVIRONMENTAL INTL. INC. Sales Department
 95 Cypress Drive
 Youngsville, NC 27596
 (919) 570-2862
 info@avanienvironmental.com

	Date	Name	Part Number:	Title:
Drawn by:	2015-04-17	***	REVISION A	SST-5TPx2 Plasma Downdraft table
Checked by:				
The drawings, AutoCAD, 3-D Models, and specifications are the property of Avani Environmental Intl. Inc. (AE) and may not be reproduced, distributed, modified, or otherwise used, except provided herein, without the express written permission of AE.				

Size	Scale	Drawing Number:
A	1 = 25	CCC SST-5TPx2 Page 1 of 1

DO NOT SCALE

IF IN DOUBT ASK

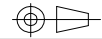

Revisions			
Rev	Description	Date	Approved

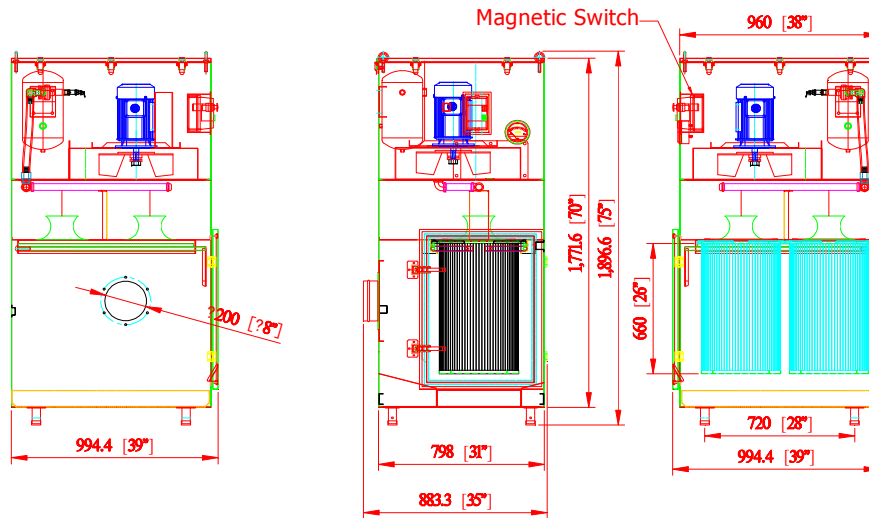
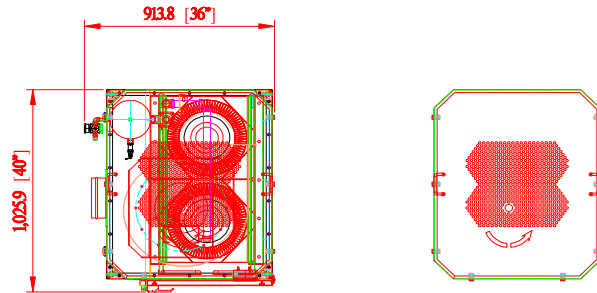

**SDC-ECO-2000 DRAWER TYPE
ECONOMY DUST COLLECTOR SPECIFICATIONS**

- Motor: 3HP
- ***NEMA Motor
- ***Aluminum Impeller

- Electric Spec: 230/460V / 60Hz / 3Ph (wired at 460V)
- Airflow: 1500 CFM (2547 m3/hr)

Filtration Stages:

1. Cartridge Filter: DIA. 380 x 660mm x 2 pcs
 - spec: dia. 380 x 660mmL (15" x 26"L)
 - filtering area: 15m² x 2 = 30m² (322.8 ft²)
 - Material: Polyester Spun Bond with TEFLON treatment & coating

- No. of Valves: 1
- Compressed Air Requirement: 90 PSI
- Compressed Air Reservoir: 2.63 gallon
- Dimension: main machine: 40" x 39" x 75"
(1025.9 x 994.4 x 1896.6mm)

- Construction: 14 gauge steel
- Max. Operating Temp.: 120°C
- Paint Color: powder coated Blue
- Inlet Port: dia. 200 mm / 8" x 1 hole

Standard Accessory:

- Reverse jet pulse system
- Door locker: compression latch
- Top quick access door for easy maintenance
- Magnetic switch - sunken in
- **gauge hole pre-drilled.

Optional Accessory:

- Arm Base
- Wall Bracket
- Spark Trap
- HEPA

PRELIMINARY

AVANI ENVIRONMENTAL INTL. INC. Sales Department
95 Cypress Drive
Youngsville, NC 27596

(919) 570-2862
info@avanienvironmental.com

Date	Name	Part Number: REVISION A
Drawn by:	***	
Checked by:		

Title:
SDC-ECO-2000 Economy Dust Collector
(Drawer Type)

The drawings, AutoCAD, 3-D Models, and specifications are the property of Avani Environmental Intl. Inc. (AE) and may not be reproduced, distributed, modified, or otherwise used, except provided herein, without the express written permission of AE.

Size B	Scale 1 = 20	Drawing Number: CCC SDC-ECO-2000 Page 1 of 1
------------------	-----------------	--

DO NOT SCALE

IF IN DOUBT ASK

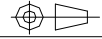

Revisions			
Rev	Description	Date	Approved

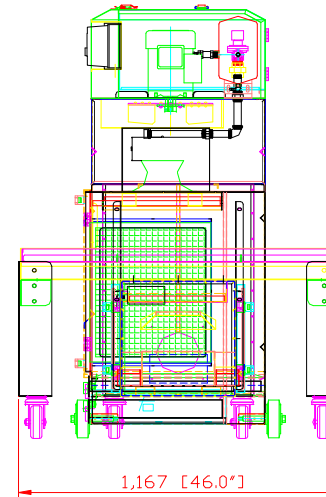
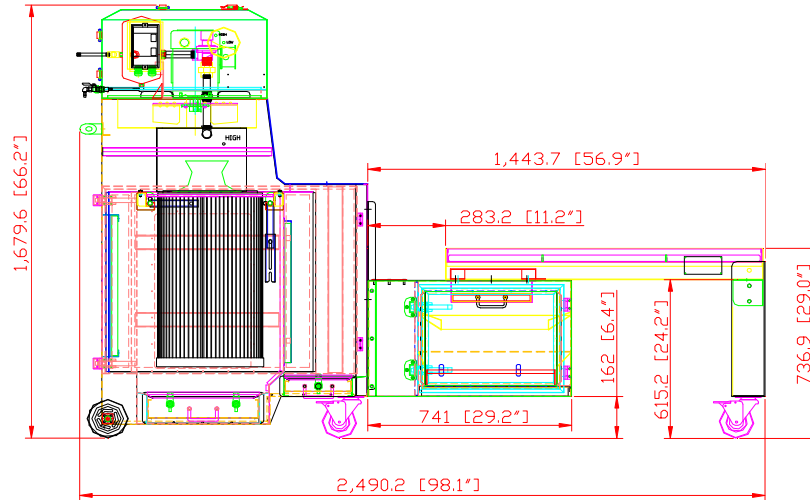
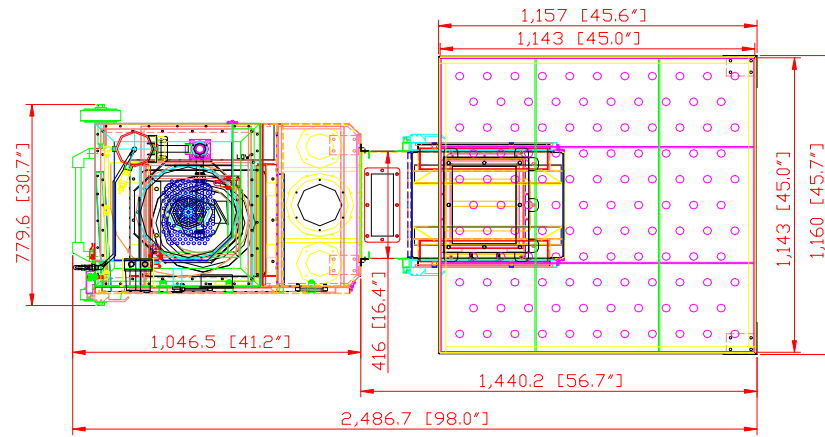

PRELIMINARY

AVANI ENVIRONMENTAL INTL. INC.
 95 Cypress Drive
 Youngsville, NC 27596

Sales Department
 (919) 570-2862

info@avanienvironmental.com

	Date	Name
Drawn by:	2015-04-17	***
Checked by:		

Part Number:
REVISION A

Title: **PLASMA CAM COLLECTOR
 SPC-2000+DP66+RM-150E**

The drawings, AutoCAD, 3-D Models, and specifications are the property of Avani Environmental Intl. Inc. (AE) and may not be reproduced, distributed, modified, or otherwise used, except provided herein, without the express written permission of AE.

Size
A

Scale
 1 = 22

Drawing Number:
 CCC Plasma Cam Collector
 Page 1 of 3

DO NOT SCALE

IF IN DOUBT ASK



Revisions

Rev	Description	Date	Approved

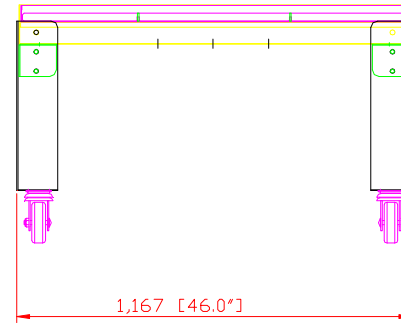
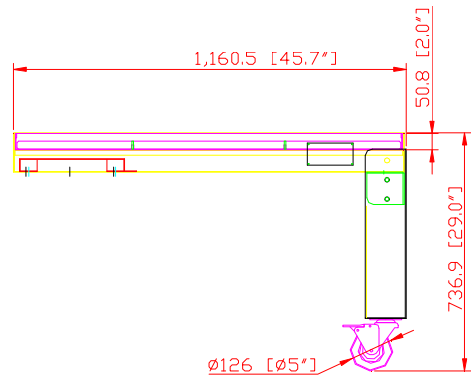
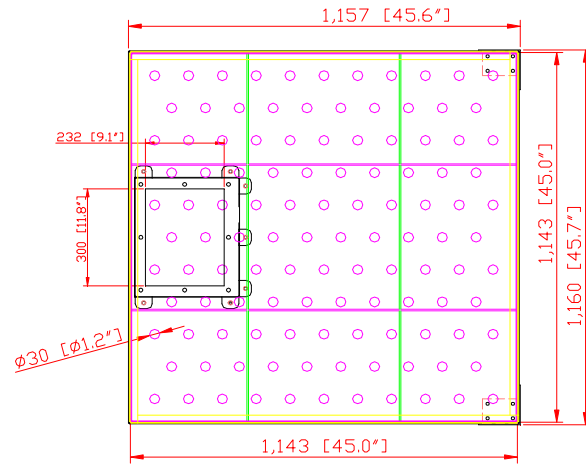

PRELIMINARY

AVANI ENVIRONMENTAL INTL. INC.
 95 Cypress Drive
 Youngsville, NC 27596

Sales Department
 (919) 570-2862
 info@avanienvironmental.com

Date	Name	Part Number:
2015-04-17	***	REVISION A

Title: Plasma Cam Collector DP66

The drawings, AutoCAD, 3-D Models, and specifications are the property of Avani Environmental Intl. Inc. (AE) and may not be reproduced, distributed, modified, or otherwise used, except provided herein, without the express written permission of AE.

Size
A

Scale
1 = 15

Drawing Number:
CCC Plasma Cam Collector DP66
Page 2 of 3

DO NOT SCALE

IF IN DOUBT ASK



Revisions			
Rev	Description	Date	Approved

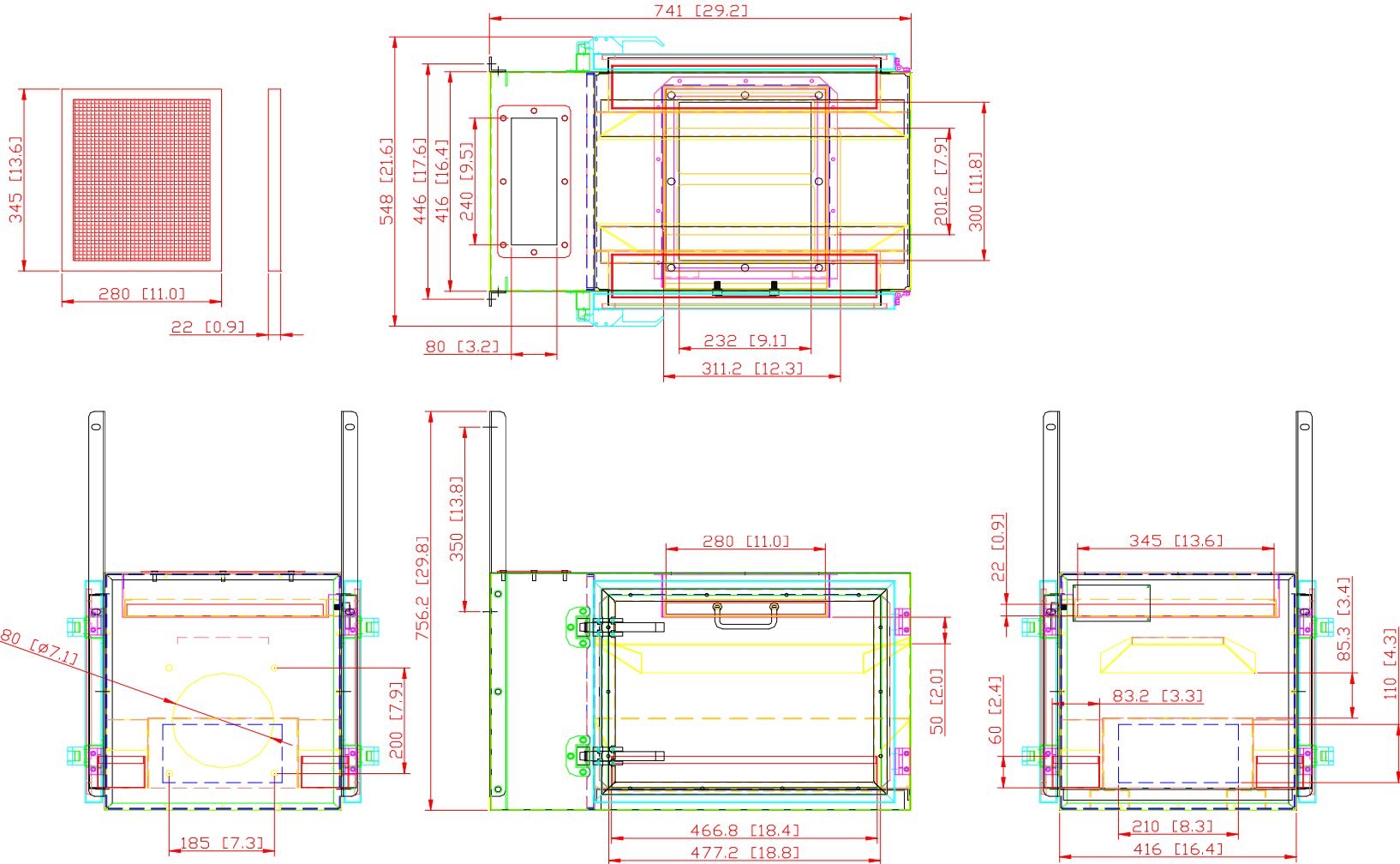

PRELIMINARY

AVANI ENVIRONMENTAL INTL. INC. Sales Department
 95 Cypress Drive (919) 570-2862
 Youngsville, NC 27596 info@avanienvironmental.com

Date	Name	Part Number:
2015-04-17	***	REVISION A
Drawn by:	Checked by:	

Title: Plasma Cam Collector RM-150E

The drawings, AutoCAD, 3-D Models, and specifications are the property of Avani Environmental Intl. Inc. (AE) and may not be reproduced, distributed, modified, or otherwise used, except provided herein, without the express written permission of AE.

Size	Scale	Drawing Number:
A	1 = 10	CCC Plasma Cam Collector RM-150E Page 3 of 3

DO NOT SCALE

IF IN DOUBT ASK



Revisions			
Rev	Description	Date	Approved

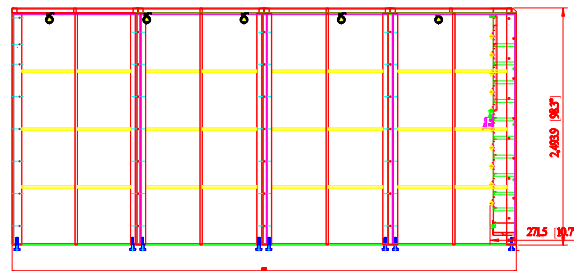
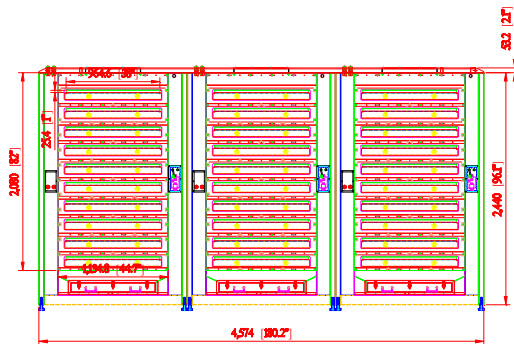
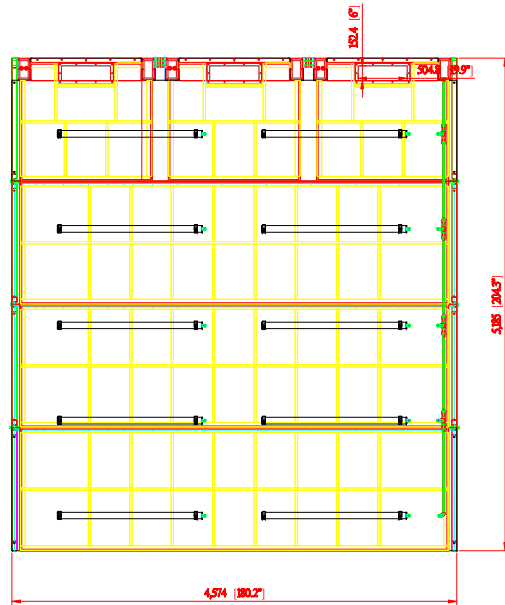

PRELIMINARY

GB-17x15x8 GRINDING BOOTH SPECIFICATIONS

- Top Panel Dimensions: 204.3" x 180.2" x 2.1"
- Back Draft Dimensions: 82" x 44.7" x 10.7" (**NOT** incl. clean out drawer)
- Unit Outlet Connection: 19.9" x 6"
- Back Draft Adjustable Inlet Slots: (10) 1" x 38" @ 3sets
- Side Panel Dimensions: (8) 53" x 96.1"
- Working Lights: (10) Explosion Proof Lights (110V, Single Phase, 60 Hz, 20W)
- Adjustable Knobs: (60) 2 ? " Five Star Twists
- Support Structure: 1 ? " x 4" steel stock welded
- Panel Construction: Double wall of 2, 12-gauge, seam welded steel panels insulated with high density fiber, 3 pounds per cubic foot,
- Powder Coated: Avani Safety Blue Standard (custom colors available)
- Booths can be mounted back-to-back, side-to-side or both options
- Electrical Outlets: (3) 110V Outlets @ (1) Switch (additional single or three phase outlets available)
- Light Switch: For overhead lights
- CO2 or Gas Connection: (additional gas lines or compressed lines available)
- Double Wall Construction (welded)

OPTIONS

- Welded Nuts: Optional locations for J-Hooks
- Welding Nuts: For wire feeder or welder bracket
- Adjustable Rear Shelf (solid, grated or cutting table)
- Corner Shelves
- Custom Welding Brackets
- Foot Lockers
- Fixtures, Lazy Suzans
- Any option that can fit inside the booth or on the booth

AVANI ENVIRONMENTAL INTL. INC. Sales Department
 95 Cypress Drive
 Youngsville, NC 27596
 (919) 570-2862
 info@avanienvironmental.com

Drawn by:	Date	Name	Part Number:
Checked by:	2015-04-17	***	REVISION A

Title:
GR-17x15x8 Grinding Room

The drawings, AutoCAD, 3-D Models, and specifications are the property of Avani Environmental Intl. Inc. (AE) and may not be reproduced, distributed, modified, or otherwise used, except provided herein, without the express written permission of AE.

Size B	Scale 1 = 35	Drawing Number: CCC GR-17x15x8 Page 1 of 1
------------------	-----------------	--

DO NOT SCALE

IF IN DOUBT ASK

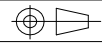

Revisions

Rev	Description	Date	Approved
-----	-------------	------	----------

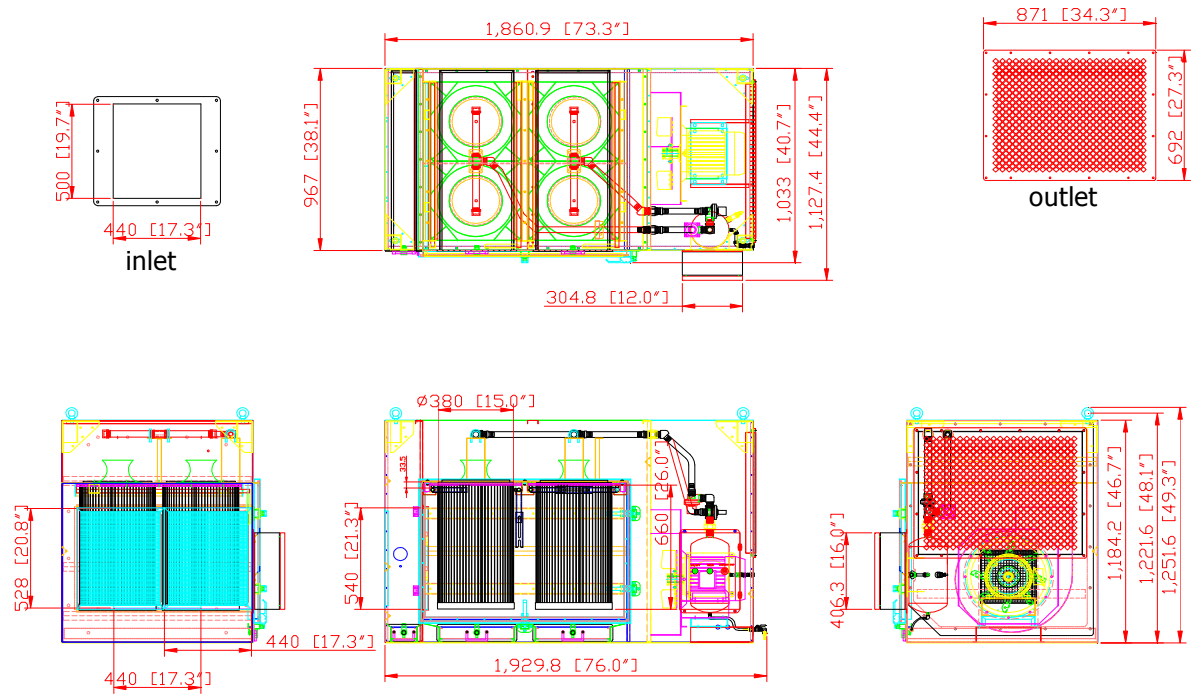

SAU-X5 Ambient Cartridge Collector SPECIFICATIONS	
Motor:	5 HP NEMA
Airflow:	2340 ft3/min 3973.32 m3/hr
Filtration Stages:	1st - aluminum mesh x (2) pcs Spec: 440 x 540 x 22mm (17.4" x 21.3" x 0.87") 2nd - cartridge filter x (4) pcs Spec: Dia. 380 x 660mmL (dia. 15" x 26"L) Filtering area: 15M2 x 4 = 60M2 (645.6 FT2)
Polyester Spun bond:	Polyester with TEFLON treatment & coating
No. of Valves:	2
Compressed Air Requirement:	90 PSI
Compressed Air Reservoir:	2.63 gallon
Inlet Opening:	440 x 500 mm (17.3" x 19.7")
Outlet Opening:	864 x 685 mm (34" x 27")
Dimension:	192.98 x 112.74 x 125.16 cm (76 x 44.4 x 49.3 inch)
Construction:	8 gauge steel to 14 gauge steel
Max. Operating Temp.:	120°C
Paint Color:	Blue
Control Box:	- UL Control Panel: timer and air pulse jet cleaning
Standard Accessories:	inlet & exhaust outlet with screen

PRELIMINARY

AVANI ENVIRONMENTAL INTL. INC. Sales Department
 95 Cypress Drive
 Youngsville, NC 27596
 (919) 570-2862
 info@avanienvironmental.com

Date	Name	Part Number:	Title:
2015-05-13	***	REVISION A	SAU-X5 (standard ambient)
Drawn by:	Checked by:	The drawings, AutoCAD, 3-D Models, and specifications are the property of Avani Environmental Intl. Inc. (AE) and may not be reproduced, distributed, modified, or otherwise used, except provided herein, without the express written permission of AE.	

Size	Scale	Drawing Number:
A	1 = 30	ACC-5 (standard) A02-01-ACC-5