

DO NOT SCALE

IF IN DOUBT ASK

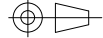

Revisions			
Rev	Description	Date	Approved

**WB-7078G w/SDT-81 GRINDING BOOTH w/Downdraft table SPECIFICATIONS**

- Top Panel Dimensions: 84.2" x 84.2" x 2.1"
- Side Panel Dimensions: (2) 84.2" x 96.1"
- Working Lights: (2) Explosion Proof Lights (110V, Single Phase, 60 Hz, 20W)
- Support Structure: 1 1/2" x 4" steel stock welded
- Panel Construction: 12-gauge welded steel single wall with cross and up bracing
- Powder Coated: Avani Safety Blue Standard (custom colors available)
- Four Piece Configuration: (2) side panels, (1) back panel, (1) Top hood
- Booths can be mounted back-to-back, side-to-side or both options
- Electrical Outlets: (2) 110V Outlets @ (1) Switch (additional single or three phase outlets available)
- Light Switch: For overhead lights
- Compressed Air Connection
- CO2 or Gas Connection: (additional gas lines or compressed lines available)
- 4 light light-bar per drop
- adjustable legs with mounting brackets
- cross-member under deposit hole

**OPTIONS**

- Welded Nuts: Optional locations for J-Hooks
- Welding Nuts: For wire feeder or welder bracket
- Adjustable Rear Shelf (solid, grated or cutting table)
- Corner Shelves
- Viewing Windows
- Custom Welding Brackets
- Foot Lockers
- Fixtures, Lazy Suzans
- Any option that can fit inside the booth or on the booth

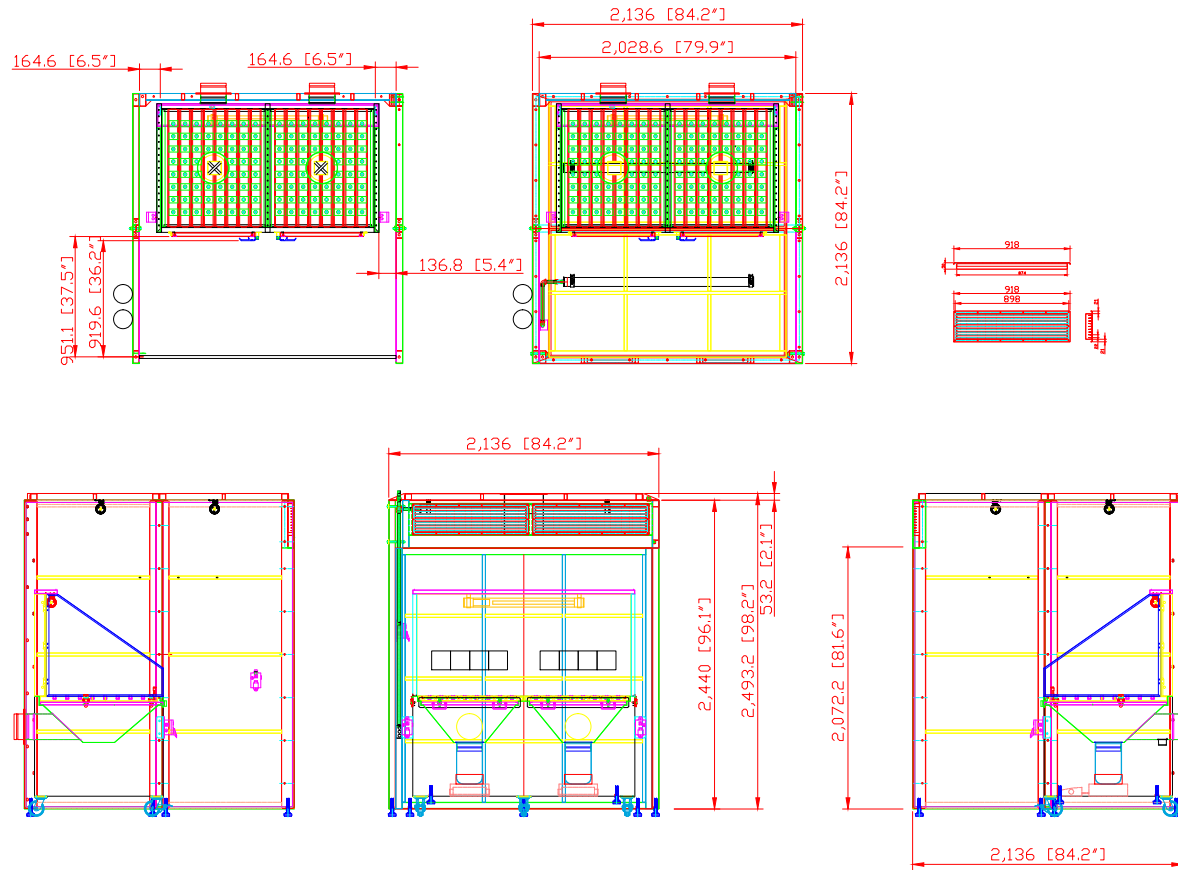

AVANI ENVIRONMENTAL INTL. INC. Sales Department  
 95 Cypress Drive  
 Youngsville, NC 27596  
 (919) 570-2862  
 info@avanienvironmental.com

Drawn by:	2014.07.14	Name	***	Part Number:	Title: <b>WB-7X7X8 with Curtain(Bloom) w/SDT-81</b>	
Checked by:				<b>Bloom</b>		
The drawings, AutoCAD, 3-D Models, and specifications are the property of Avani Environmental Intl. Inc. (AE) and may not be reproduced, distributed, modified, or otherwise used, except provided herein, without the express written permission of AE.				Size	Scale	Drawing Number:
				<b>C</b>	1 = 35	<b>WB-7-7P-G (Bloom)</b>