

DO NOT SCALE

IF IN DOUBT ASK

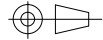

Revisions

Rev	Description	Date	Approved
-----	-------------	------	----------

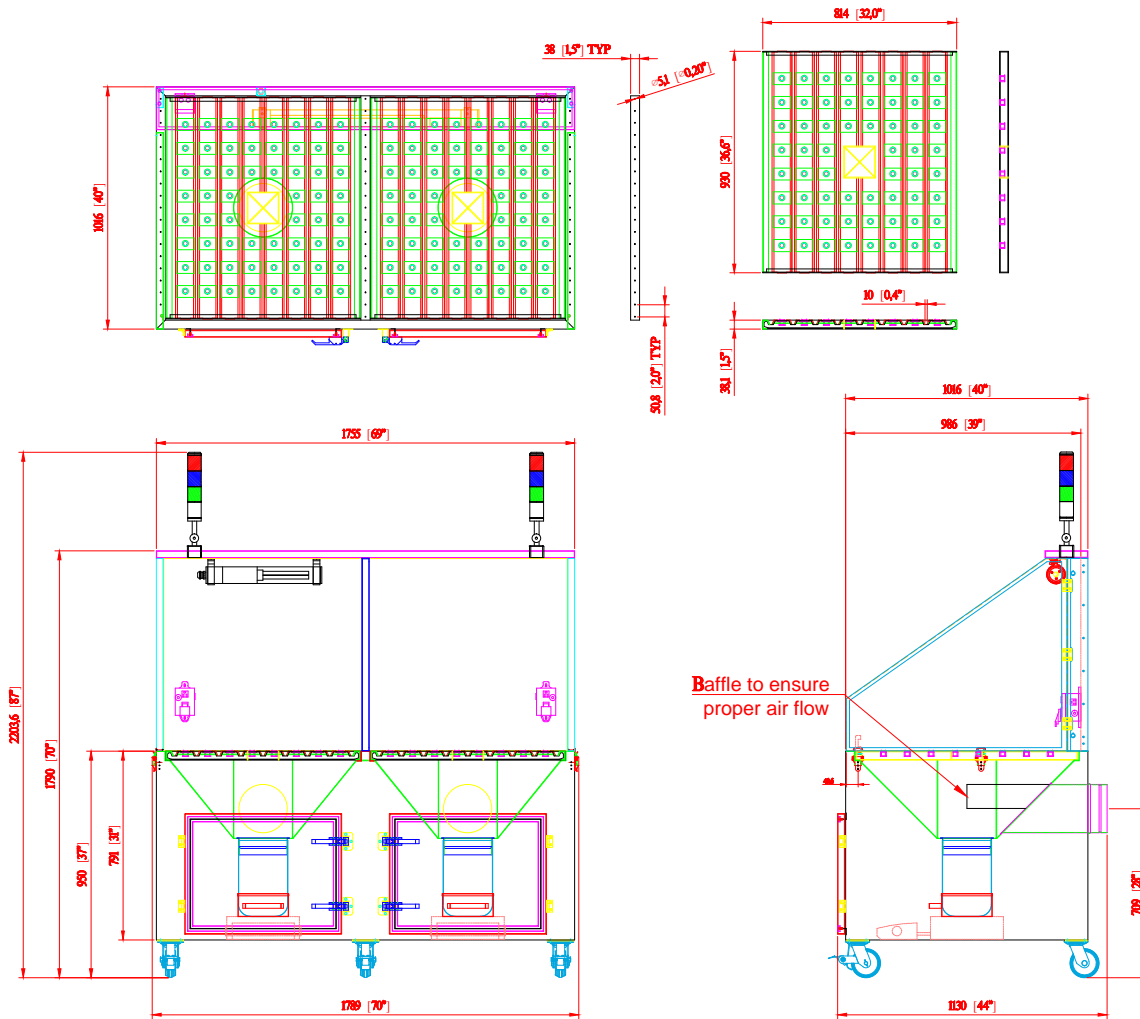

- SDT-8x3-D Downdraft table w/Drawer SPECIFICATION -

- Motor: N/A
- Filtration Stages: N/A
- Outlet: Dia. 8" (203mm) x 2
- Dimension: 76" x 47" x 87"
(1925 x 1204 x 2203.6mm)
- Construction: 14 Gauge
- Max. Operating Temp.: 120°C
- Paint Color: powder coated Blue
- Shallow boxes built into scales (5" walls with front hinged)
- Baffle installed to ensure proper air flow/prevent larger waste material from extraction
- fully assembled
- paint color: powder coated Blue
- Custom flange on sides
- ***Electrical Outlets: (2) 110V Outlets @ (1) Switch
- ***Light Switch: (1) For overhead lights
- ***Overhead Lights: (1) Explosion Proof Lights (110V, Single Phase, 60 Hz, 20W, non-recessed)
- ***Stacked indicator lights (2) (green/blue/red)
- *** 100% downdraft
- *** full grated table top with dia. 16mm fixture holes drilled
- *** casters underneath the machine

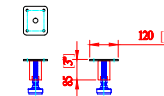

AVANI ENVIRONMENTAL INTL. INC. Sales Department
 95 Cypress Drive (919) 570-2862
 Youngsville, NC 27596 info@avanienvironmental.com

Drawn by:	Date: 2014-08-08	Name: ***	Part Number: Bloom Energy	Title: SDT-8x3-D with collection drawer		
Checked by:				Size: D	Scale: 1 = 25	Drawing Number: ***
The drawings, AutoCAD, 3-D Models, and specifications are the property of Avani Environmental Intl. Inc. (AE) and may not be reproduced, distributed, modified, or otherwise used, except provided herein, without the express written permission of AE.						