



AMUNDSEN ASSOCIATES

SUBMITTAL TRANSMITTAL

ARCHITECTURE • PLANNING • INTERIOR DESIGN

212 East 2nd Street
Phone: (307) 234-9999

office@amundsenassociates.com

Casper, Wyoming 82601
Fax: (307) 234-4542

To: David Jaeger

Date: 3/5/15

Company: AP Wyoming

Project Name: NCHS

From: Karen Nilsson

Project No.: 11113

Submittal No: 233514-128-01

Description: Special Exhaust System

We are sending you via:

Federal Express UPS EMAIL U.S. Mail Other PickUp _____
 FAX Pages including cover _____ FAX # _____ Original.. Will Will not be sent

If enclosures are not as noted, please inform us immediately.

FOR YOUR REVIEW AND COMMENT

PLEASE SEE ARCHITECT OF RECORD AND/OR CONSULTANT'S REVIEW COMMENTS ATTACHED.

Copies to:

Final Copy Distribution

David Jaeger-AP
Gabe Madsen-AP
Eric Kimmelshue-AP
John Haass-AP
Kyle Rigdon-AP
Zac Byard-AP
Cody Jensen-AP
Doug Tunison-NCSD
Ray Scott-CP
Josh Vogt-CP
Kristian Kicinski-BA
Peter Watson-BA
Suzanne Odgers -BA
Calvin Finnesand - BA
James Moehring - BA
Paul Syverson-SFD

Consultant Copy Distribution

PCS, Structural Solutions
 WSP-Flack + Kurtz
 Swift Co.
 WLC
 Sparling
 JLR Design Group
 Adams Consulting & Estimating
 PLA Design, Inc.



SUBMITTAL REVIEW TRANSMITTAL

Project Natrona County HS **Date** 3/5/15
Project No. 11855.00 **Reviewed by** WSP Building Systems
From Bassetti Architects
Submittal No. 233514 128 01
Section No. 233514 - Special Exhaust System

Deliver to

- Attn: Ron Shosh
and Karen Nilsson
Amundsen Associates LLC
212 E Second St
Casper, WY 82601
rshosh@amundsenassociates.com
knilsson@amundsenassociates.com

If enclosures are not as noted, please inform us immediately.

We transmit herewith **Via email** **For your use**

With the following review

A = No Exception Taken R = Rejected FAC = Furnish as Corrected R&R = Revise & Resubmit SSI = Submit Specific Item

This review is only for general conformance with design concept of the project and general compliance with the information given in the Contract documents. Corrections or comments made on the shop drawings during this review do not relieve contractor from compliance with the requirements of the plans and specifications. Approval of a specific item shall not include approval of an assembly of which the item is a component. Contractor is responsible for dimensions to be confirmed and correlated at the jobsite; information that pertains solely to the fabrication processes or to the means, methods, techniques, sequences and procedures of construction; coordination of his or her Work with that of all other trades; and for performing all work in a safe and satisfactory manner.

Section	Paragraph	Description	Comments	Action
233514	1.3 A	Product Data	See attached transmittal by WSP.	FAC, R&R

Project File (1)

WSP Building Systems--Seattle

WSP Submittal # **M-29.1**

SUBMITTAL REVIEW COMMENTS

Project Name: **Natrona County High School**

<u>WSP Project #</u>	<u>Contractor Submittal #</u>	<u>Date Received</u>
W1213000.000	0128-233514-1	2/27/15

Description: Special Exhaust Systems

Action: **NO EXCEPTIONS NOTED**

Fabrication, manufacture, or construction may proceed providing submittal complies with the Contract Documents.

NO EXCEPTIONS NOTED	X
EXCEPTIONS NOTED [] RESUBMIT FOR RECORD [] NO RESUBMISSION REQUIRED	
REVISE AND RESUBMIT	
REVIEWED FOR INFORMATION ONLY	
UNREVIEWED	
<small>Corrections or comments made on the shop drawings during this review do not relieve contractor from compliance with requirements of the drawings and specifications. This check is only for review of general conformance with the design concept of this part of the project and general compliance with the information given in the contract documents. The contractor is responsible for providing all information necessary for this review: confirming and correlating all quantities and dimensions; selecting fabrication processes, techniques and sequences of construction; coordinating work with that of other trades and performing work in a safe and satisfactory manner. Notations on this drawing do not authorize changes to the contract documents without written authorization from the owner's representatives.</small>	
WSP Building Systems -Mechanical	
Adam Leingang	3/4/2015

Additional Reviews by:

Comments

- 1) Furnish as corrected.
- 2) Grinding Booth shall include 3-HP fan and filter sections per spec section 233514 2.5 C

END OF COMMENTS

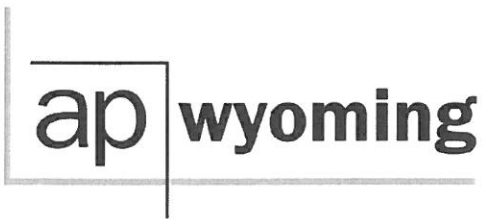

Submittal Transmittal

6673 - Natrona County High School
 930 S Elm Street
 Casper, WY 82601

Project # 6673
 Tel: 307-426-4242 Fax: 307-426-4245

Date: 2/26/2015 **Reference Number:** 0332

Transmitted To: Ron Shosh Amundsen Associates, Inc. 212 East 2nd St. Casper, WY 82601 Tel: 307-234-9999	Transmitted By: John Haass AP Wyoming, LLC 1800 Carey Avenue, 4th Floor Cheyenne, WY 82001 Tel: 307-426-4242 Fax: 307-426-4245
--	--

Qty	Package Number	Description	Due Date
1	0128 - 233514 - 1	Special Exhaust Systems Product Data and shop drawings for Welding and Gringinf Booths	3/19/2015

Transmitted For	Delivered Via	Tracking Number
Approval	Email	

Qty	Spec. Section	Reg. #	Description	Group/Bid Package	Item Action
1	233514 - 1.3A - 0	00861	Special Exhaust Systems Product Data		Not Received

Cc: Company Name	Contact Name	Copies	Fax:	Notes

Remarks
 Please see the attached submittal package for the Grinding and Welding Booths.

Reviewed

Contractor's review of and revisions to this submittal are for the purpose of ensuring general conformance only and in no way will relieve any subcontractors, suppliers or other parties from responsibility to fully comply with the terms conditions and provisions contained in the applicable contract documents, plans, specifications and drawings.

Signed by: John Haass at 02/26/2015 1:49:37 PM

AP Wyoming, LLC

Signature Signed Date

DO NOT SCALE IF IN DOUBT ASK



Revisions

Rev	Description	Date	Approved

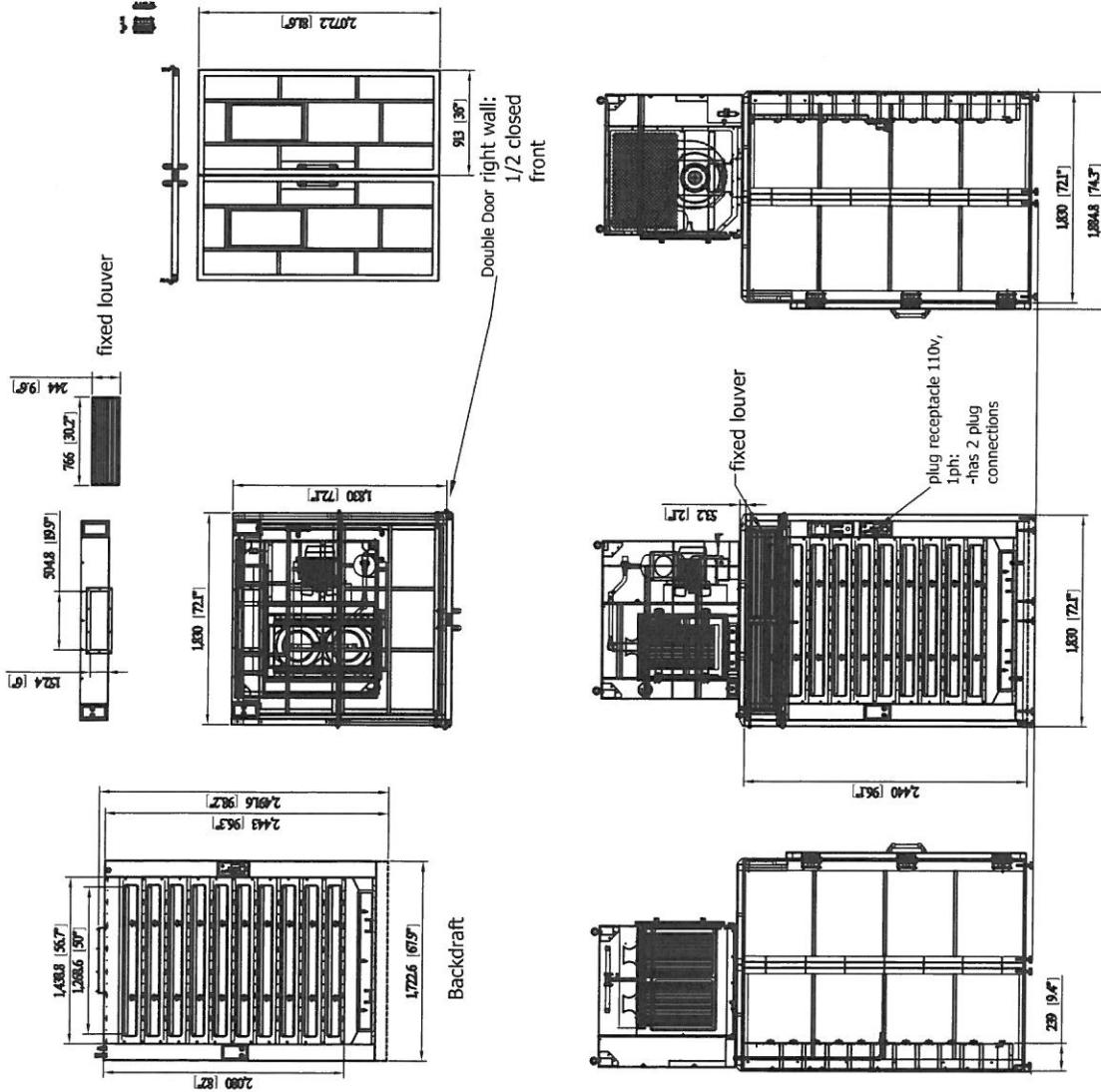

GR-6066-DD GRINDING BOOTH SPECIFICATIONS

- Top Panel Dimensions: 72.1" x 72.1" x 2.1"
 - Back Draft Dimensions: 82" x 56.7" x 9.4" (NOT incl. clean out drawer)
 - Top Service Panel: Removable 19.9" x 6" service panel
 - Back Draft Adjustable Inlet Slots: (10) 1" x 50"
 - Side Panel Dimensions: (2) 73.1" x 96.1"
 - Front Panel Dimensions: (1) 28.3" x 81.2"
 - Working Lights: (2) Explosion Proof Lights (110V, Single Phase, 60 Hz, 20W)
 - Adjustable Knobs: (20) 2 1/2" Five Star Twists
 - Support Structure: 1 1/2" x 4" steel stock welded
 - Panel Construction: 12-gauge welded steel single wall with cross and up bracing
 - Powder Coated: Avanti Safety Blue Standard (custom colors available)
 - Six Piece Configuration: (2) side panels, (1) back panel, (1) backdraft assembly, (1) Top hood, (1) double door
 - Booths can be mounted back-to-back, side-to-side or both options
 - Electrical Outlets: (2) 110V Outlets @ (1) Switch (additional single or three phase outlets available)
 - Light Switch: For overhead lights
 - Compressed Air Connection
 - CO2 or Gas Connection: (additional gas lines or compressed lines available)
 - Double Wall Construction (welded)
 - ***Double Door with center opening: (2) 36" x 81.6"
 - ***Adjustable Louver: (2) 30.2" x 9.6"
- OPTIONS**
- Welded Nuts: Optional locations for J-Hooks
 - Welding Nuts: For wire feeder or welder bracket
 - Adjustable Rear Shelf (solid, grated or cutting table)
 - Corner Shelves
 - Viewing Windows
 - Custom Welding Brackets
 - Foot Lockers
 - Fixtures, Lazy Suzans
 - Any option that can fit inside the booth or on the booth

Title:		6x6 Grinding Booth with Double Door	
Part Number:		GR-6066-DD	
Size	Scale	Drawing Number:	
D	1 = 40	WB-6-6P-GDD	

Drawn by:	Date	Name
Checked by:	2015-01-29	***

The drawings, AutoCAD, 3-D Models, and specifications are the property of Avanti Environmental Int. Inc. (AE) and may not be reproduced, distributed, modified, or otherwise used, except provided herein, without the express written permission of AE.

AVANI ENVIRONMENTAL INTL. INC. Sales Department
 95 Cypress Drive
 Youngsville, NC 27596
 info@avanienvironmental.com
 (919) 570-2862

Revisions			
Rev	Description	Date	Approved

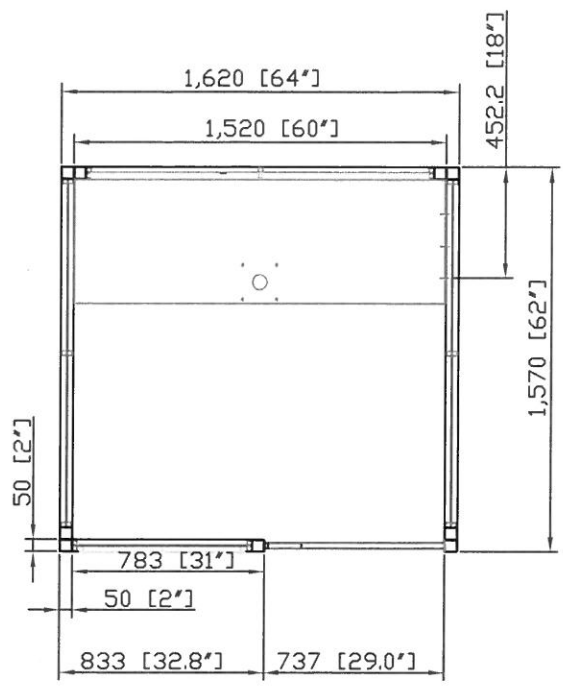

WB-1055 WELDING BOOTH SPECIFICATIONS

- Dimensions: 5' x 5' x 7.5' H
- Frame Steel: 2-Inch Square Tube with 1-Inch Square Tube Center Supports; 11-Gauge
- Panel Steel: 12-Gauge
- Rear Shelf: 60" L x 18" D; Fixed; 11-Gauge with 1.5-Inch Square Tube Frame
- Fume Arm Stanchion: 2-Inch Square Tube, 11-Gauge
- Finish: Powder Coat; Color: Blue
- Curtain Rod Assembly
- Optional Items: 1-Ply Vinyl Curtain, Strip Curtain Package, Adjustable Shelf, Fume Arm Stanchion (2-Foot Long, 11-Gauge), Fume Arm

Arm 1620: dia. 6" x 7' hanging arm

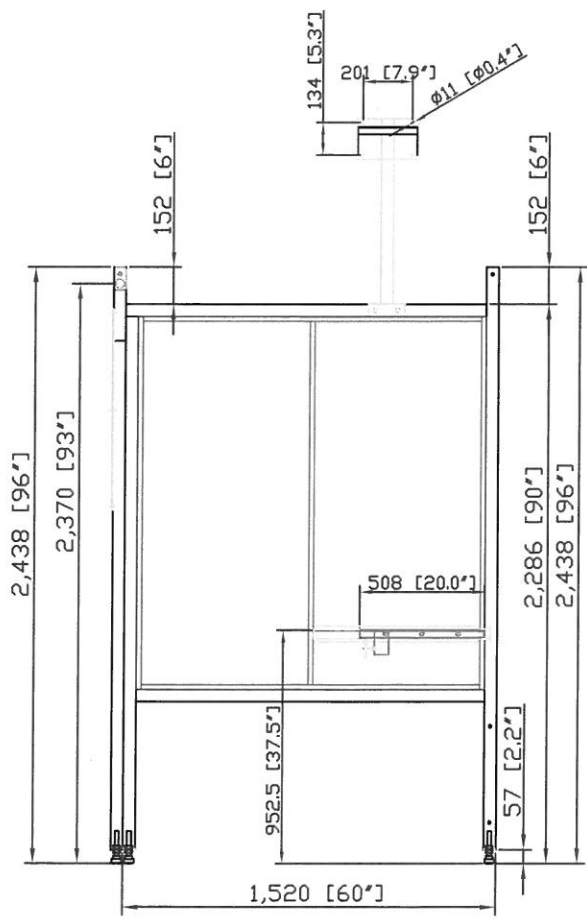
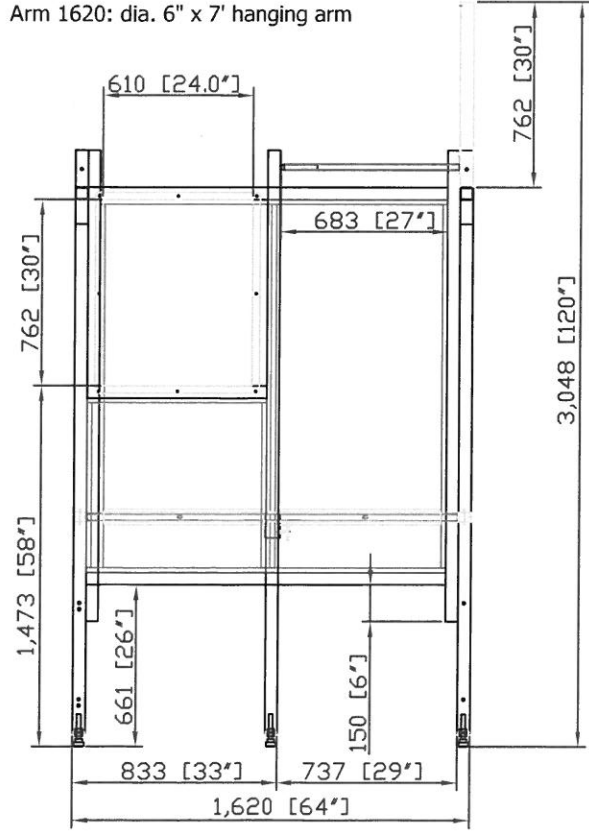

AVANI ENVIRONMENTAL INTL. INC. Sales Department
 95 Cypress Drive (1919) 570-2862
 Youngsville, NC 27596 info@avanienvironmental.com

Date	Name
2014-11-18	***
2015-01-22	***

The drawings, AutoCAD, 3-D Models, and specifications are the property of Avani Environmental Intl. Inc. (AE) and may not be reproduced, distributed, modified, or otherwise used, except provided herein, without the express written permission of AE.

Booth WB-1055		
Size A	Scale 1 = 25	Drawing Number: WB-5x5S

DO NOT SCALE IF IN DOUBT ASK



Rev	Description	Date	Approved
-----	-------------	------	----------

Hanging Arm 6"*7'

Diameter: 6"
Length: 7'
Weight: 42.5 lbs (net)
Arm Construction: Two galvanized steel tubes, three pieces of flex hose at joints, aluminum hood, heavy gauge steel swivel base, and support spring.
Arm Adjustment: Externally supported, adjustments are quickly done at the joints.
Hood: 13" diameter round aluminum hood.
Damper: Internal with external adjustment.
Finish: Powder coated.
Hose: Rated at 200°F
Accessories: Mounting bracket and light kit.
Mounting Bracket:
Warranty: Limited two years from date of purchase.

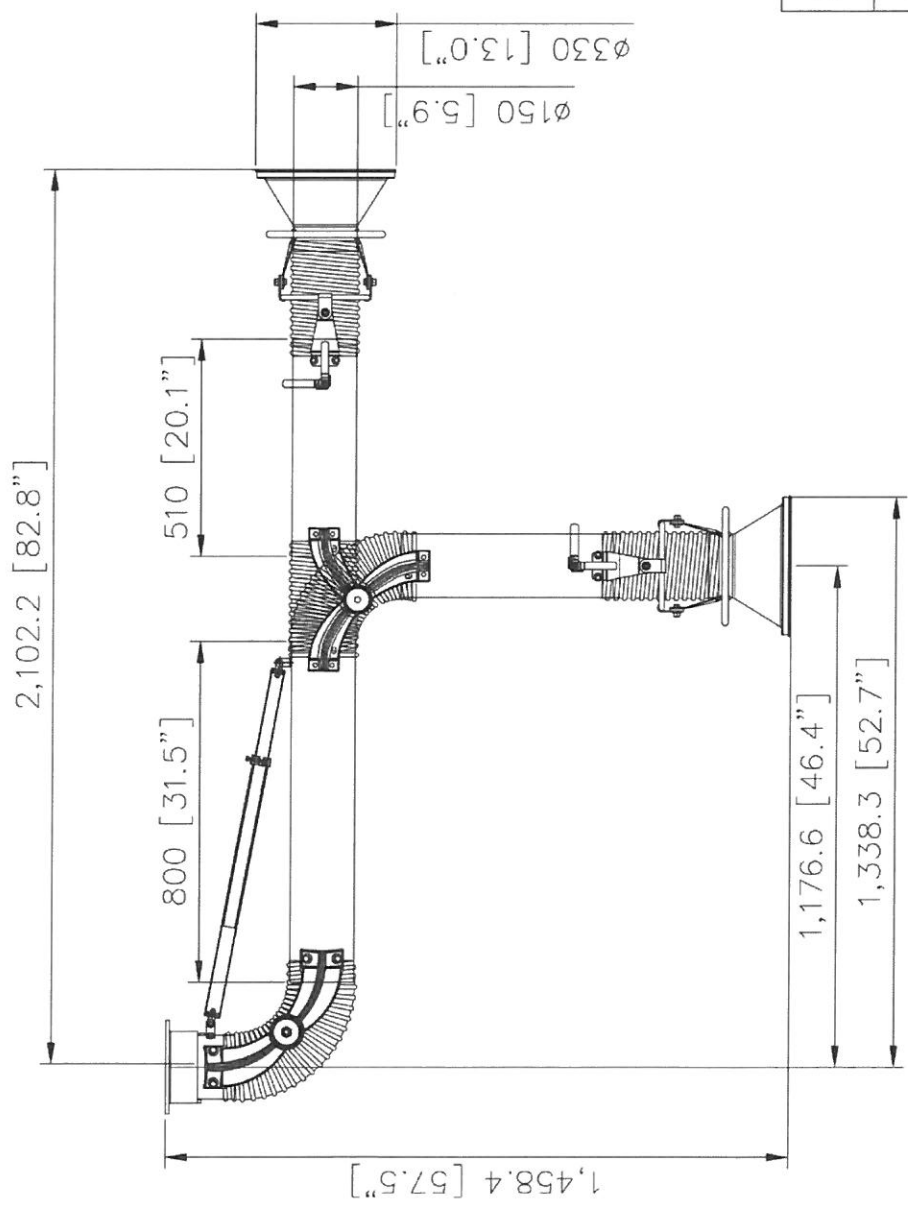

Packing Size:	133.7 x 87 x 37.5 cm 52.7 x 34.3 x 14.8 inch
N.W. / G.W.:	19.3 / 24.9 kgs 42.5 / 54.9 lbs

Avani Environmental Intl, Inc. 95 Cypress Drive Youngsville, NC 27596 sales@avanienvironmental.com		Sales Department (919) 570-2862		Part Number: PART NO.		Title: Arm 1620	
Drawn by:	Date:	Name:					
Checked by:	XX-XX-XX	XXXX					
			Size:	Scale:	Drawing Number:		
			A	1 = xx	2009.12.18		

DO NOT SCALE IF IN DOUBT ASK

WALL MOUNT BRACKET 6" ARM

Rev	Description	Date	Approved

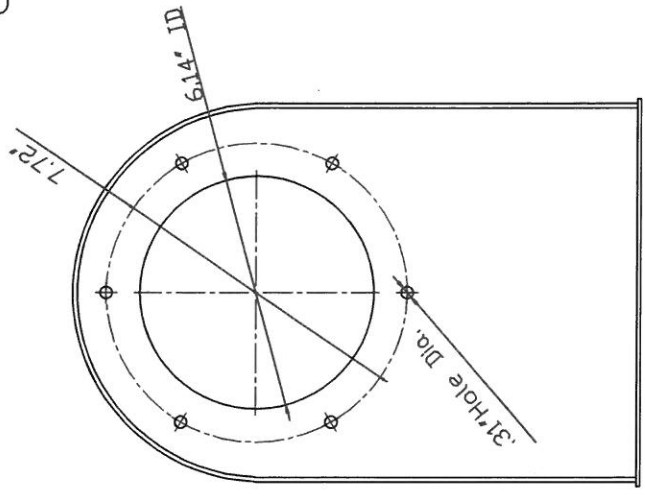
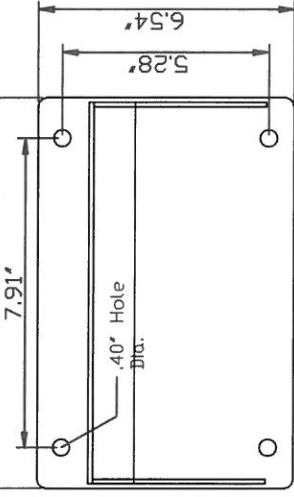
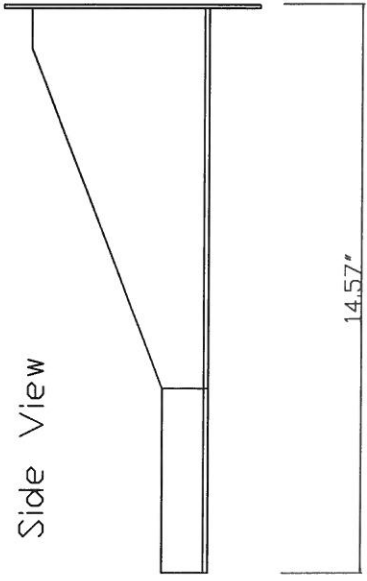

- * 11 Gauge Steel
- * Painted Black

AVANI ENVIRONMENTAL INTL. INC. Sales Department 95 Cypress Drive Youngsville, NC 27596 (919) 570-2862 info@avanienvironmental.com		Drawn by: Checked by:	Date: 2012.02.14 Name: DOJ	Part Number: FE-MB-6	Title: 6 inch arm wall mount bracket
The drawings, AutoCAD, 3-D Models, and specifications are the property of Avani Environmental Int. Inc. (AE) and may not be reproduced, distributed, modified, or otherwise used, except provided herein, without the express written permission of AE.				Size: A Scale: 1 = 1	Drawing Number: FE-MB-6

(01-27-15):

BID SPECIFICATION SHEET: Avani Welding Booth Curtains; XA Series

Prepared For: AP Wyoming, ATTN: John Haass

Project: Natrona High School, Casper, WY

WELDING BOOTH CURTAIN SPECIFICATIONS; Avani Part Numbers: XA-65 and XA-75

- Material: Flame Retardant Vinyl; (Material is approved for welding applications)
- Thickness: 14.0 Mil
- Dimensions: 6' W x 5' H x 14.0 Mil Thick
- Description: 1-Ply Curtain with Grommetted Top Edge for Curtain Ring Hardware
- Color: Safety Blue; (This is the standard offering; other colors are available)
- Part Number XA-65 (6' W x 5' H x 14-Mil) fits booth WB-1055
- Part Number XA-65 (7' W x 5' H x 14-Mil) fits booth WB-1065
- Photo:



Contact:

Avani Environmental Intl., Inc.

ATTN: Kirke Blenkhorn; Educational Sales

Phone: 919-488-5194

E-Mail: education@avanienvironmental.com

95 Cypress Drive, Youngsville, NC 27596

Main Phone: 919-570-2862, Fax: 919-570-2863, Website: www.avanienvironmental.com