

Revisions

2-26-09	BULLETIN #16	BULLETIN #16
9-29-08	BULLETIN #8	BULLETIN #8
9-4-08	BULLETIN #2	BULLETIN #2
10-1-07	WELDING SCHOOL REVISION	

Revisions
D a 1 e
Construction Set 8 August, 2008

Project Title
BWR Training Facility
Chattanooga, TN
Westinghouse Electric Co.

Drawing Title
NEW WORK PLAN - PART 'A' & NOTES

Project Number
20080017
Drawing Number
S1.3

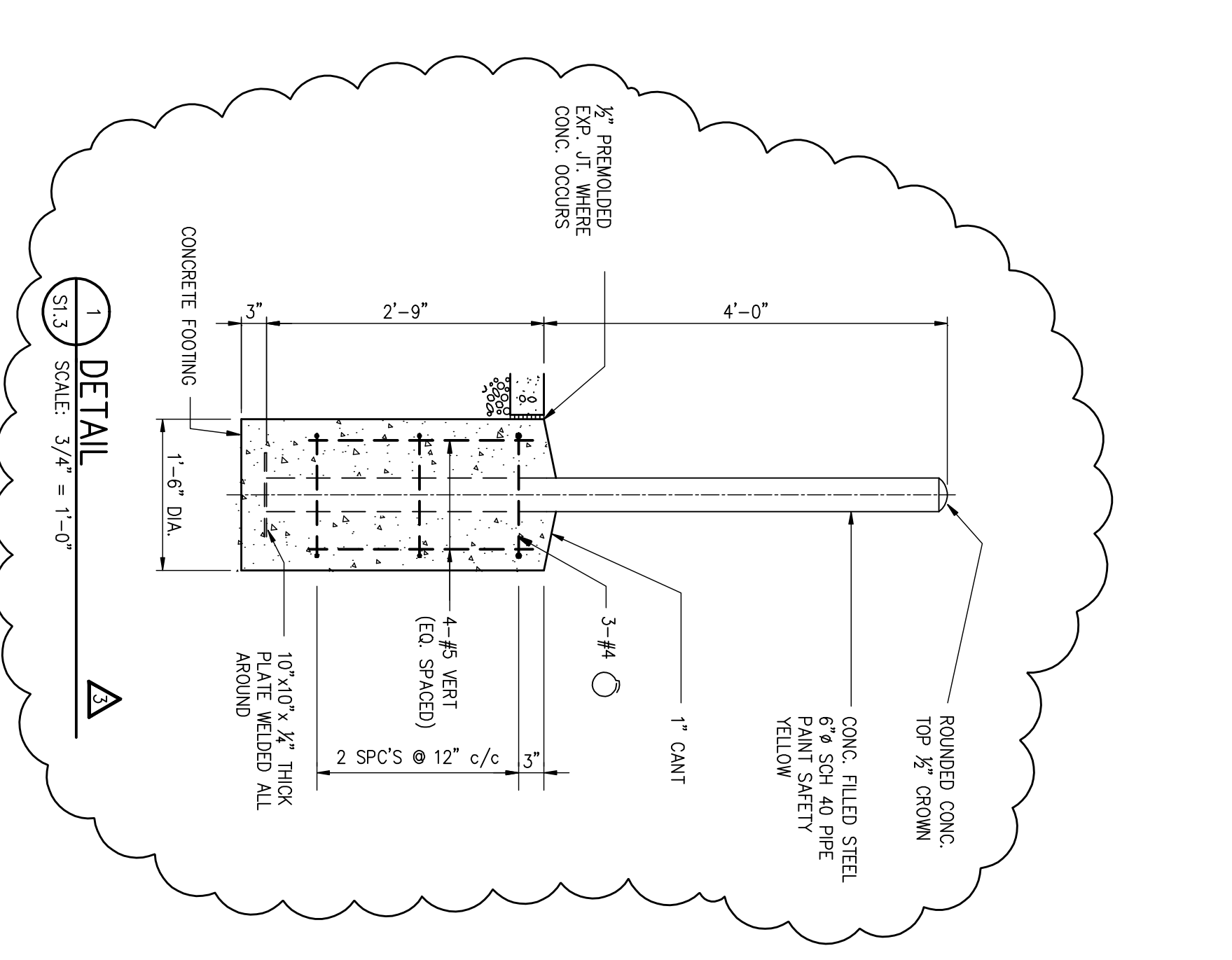
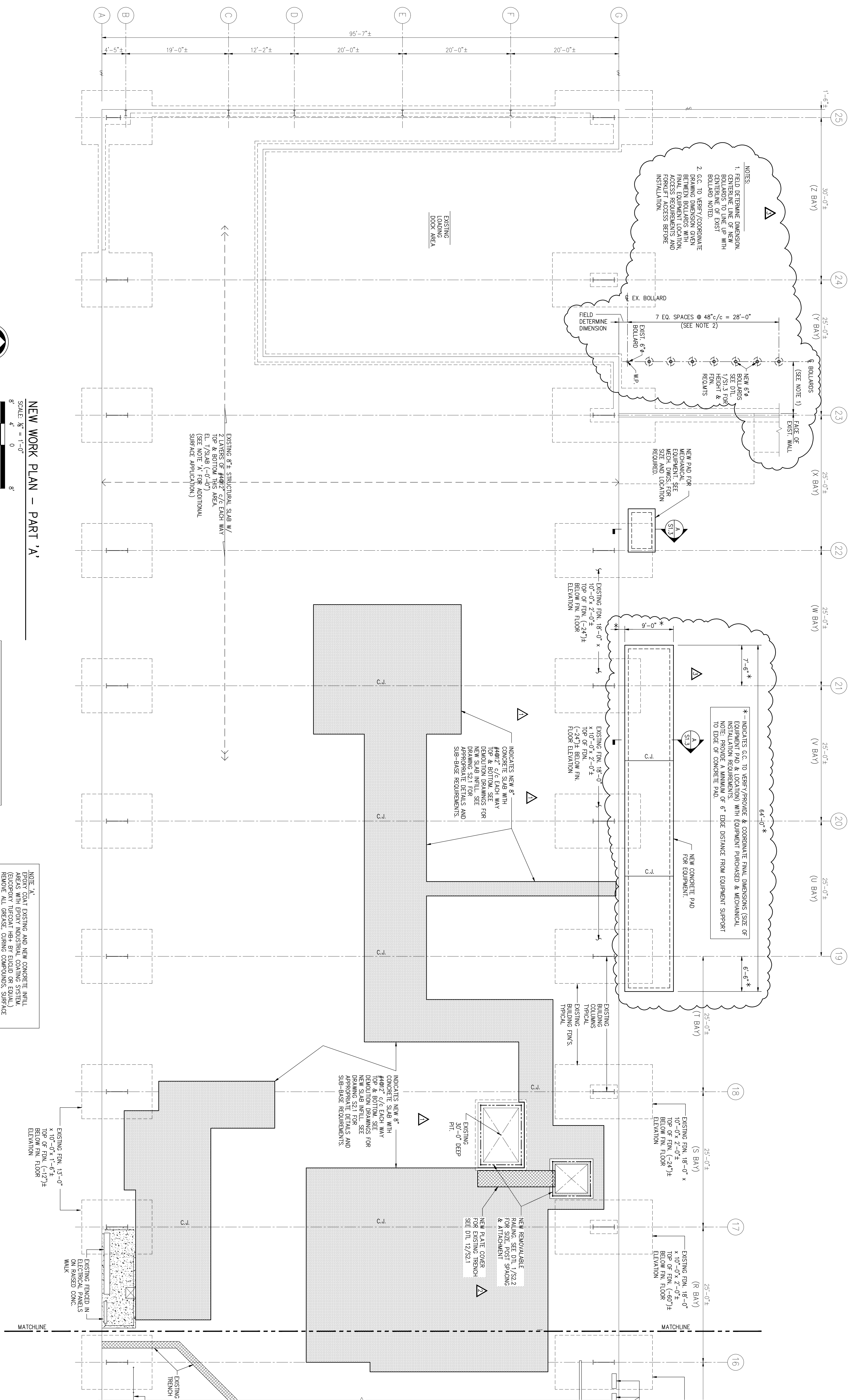

NEW WORK PLAN - PART 'A'
SCALE: 3/8" = 1'-0"
1. GOVERNING CODE - 2003 IRC (UNLESS OTHERWISE NOTED)
2. LIVE LOADS - 150 PSF OR (2) 3 TON CAPACITY FORKLIFT TRUCKS
A. OFFICE 80 PSF
C. PIT PLATFORM 120 PSF/8 PEOPLE
CONCRETE NOTES (SEE DRAWING S11)
1. ALL STRUCTURAL STEEL SHALL BE IN ACCORDANCE WITH THE SPECIFICATIONS FOR STRUCTURAL STEEL BUILDINGS (NINTH EDITION) OF THE A.I.S.C.
2. STRUCTURAL STEEL SHALL CONFORM TO THE FOLLOWING:
A. WIRE RANGING SHAPES AND WTS. - A.S.T.M. A-599 WITH A MINIMUM YIELD STRENGTH OF 50,000 PSI.
B. CHANNELS, ANGLES, PLATES AND MISCELLANEOUS CONNECTION MATERIAL A.S.T.M. A-36 WITH A MINIMUM YIELD STRENGTH OF 36,000 PSI, UNLESS NOTED OTHERWISE.
C. PIPES SHALL CONFORM TO A.S.T.M. A-501 SPECIFICATIONS AND A.S.T.M. A-53, TYPES E OR S, WITH A MINIMUM YIELD STRENGTH OR 35,000 PSI.

CONSTRUCTION NOTES
1. ALL STEEL BEAMS SHALL BE EQUALLY SPACED IN BAYS UNLESS OTHERWISE NOTED.
2. ALL CONNECTION BOLTS SHALL BE 3/4" DIAMETER A.S.T.M. A-325 H.S. BOLTS UNLESS OTHERWISE NOTED.
3. ALL BOLTED CONNECTIONS SHALL BE MADE ACCORDING TO A.I.S.C. TABLE J OR III - FRAMED BEAM CONNECTIONS. THE HALF THE DEPTH OF THE BEAM.
4. ALL ANCHOR BOLTS SHALL MEET A.S.T.M. A-307 OR A36 SPECIFICATIONS AND BE 3/4" DIAMETER WITH A 3" HOOK AT THE END AND EMBEDDED 1'-0" MINIMUM IN CONCRETE.
5. THE STANDARD OF THE A.M.S. AND A.I.S.C. USE EXXX ELECTRODES.
6. NO SHIP OR FIELD HOLES OR CUTS TO BE PLACED IN STRUCTURAL MEMBERS UNLESS INDICATED ON THE CONTRACT OR APPROVED SHOP DRAWINGS.
7. DO NOT PAINT STEEL WHERE ENGAGED OR IN CONTACT WITH CONCRETE OR OTHER AREAS AS REQUIRED TO MATCH SHOP FINISHES.
8. ALL STRUCTURAL AND MISCELLANEOUS STEEL, INCLUDING CONNECTION MATERIAL, NOTED ON DRAWINGS TO BE GALVANIZED. GALVANIZING SHALL BE THROUGHLY CLEANED AFTER FABRICATION AND ALL HIGH STRESS AREAS SHALL BE GALVANIZED TO A MINIMUM OF 2.5 OUNCES TO A.S.T.M. A-153. SEE SPECIFICATIONS FOR ADDITIONAL INFORMATION.
9. ALL BIRDS SHALL BE REMOVED AND EXPOSED EDGES AND CORNERS SHALL BE GROUNDED AND ROUNDED TO GALVANIZING.

LEGEND
NEW CONCRETE WORK

NOTE 'A'
EPOXY COAT EXISTING AND NEW CONCRETE INFILL AREAS WITH EPOXY INDUSTRIAL COATING SYSTEM. REMOVE ALL GREASE, CHIPPING COMPANION SURFACE TREATMENTS, COATINGS, OILS, ETC. FROM EXISTING CONCRETE SLAB PER MANUFACTURER'S REQUIREMENTS. PERFORMED PER MANUFACTURER'S PRINTED INSTALLATION REQUIREMENTS.

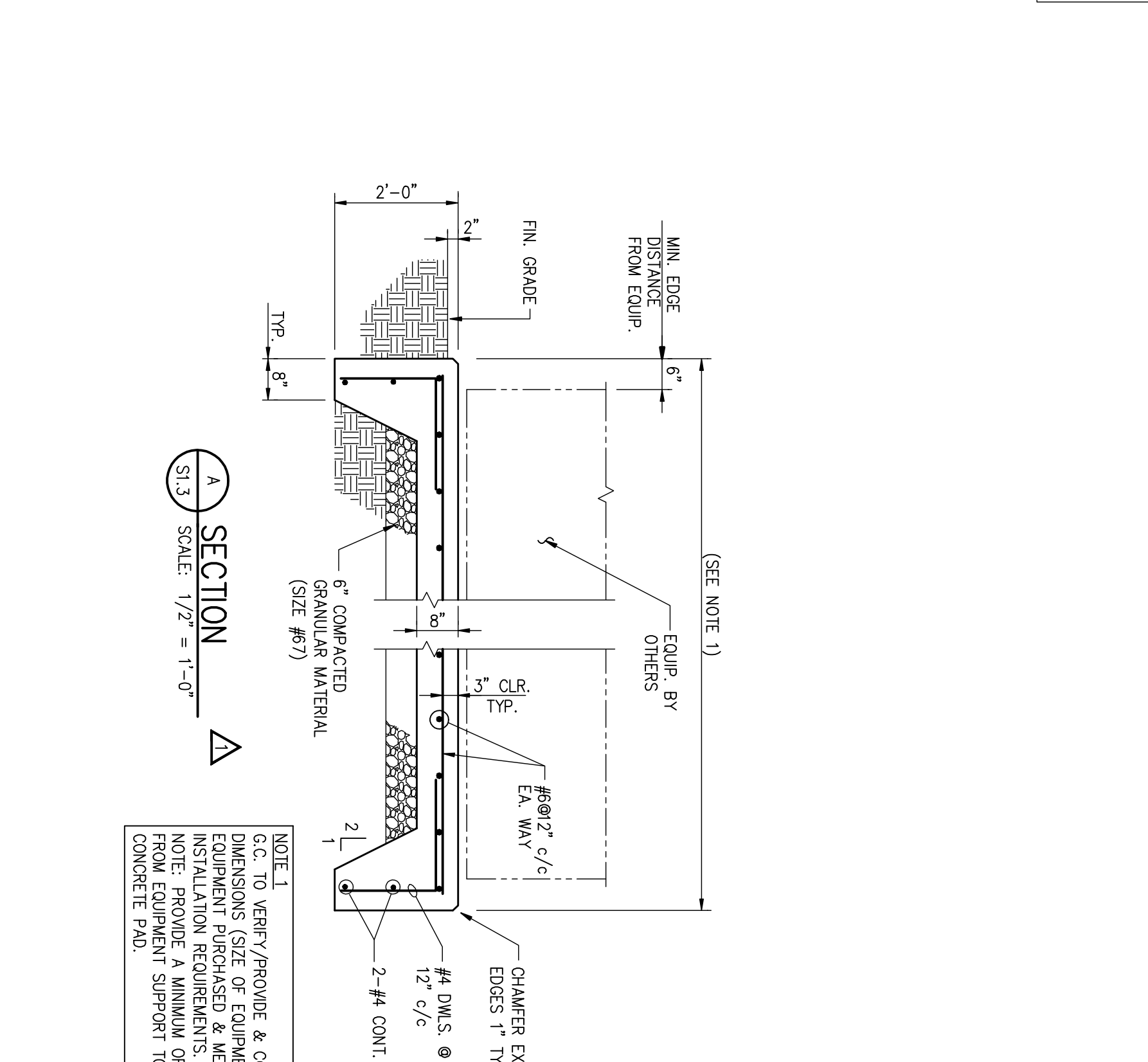

NOTE 1
G.C. TO VERIFY/PROVIDE & COORDINATE DIMENSIONS (SIZE OF EQUIPMENT PAD) WITH EQUIPMENT PURCHASER & MECHANICAL NOTE. PROVIDE A MINIMUM OF 6" EDGE DISTANCE FROM EQUIPMENT SUPPORT TO EDGE OF CONCRETE PAD.