



JACOB

Modular Tubing Systems

Jacob Tubing, L.P.
3948 Willow Lake Blvd.
Memphis, TN 38118

Phone: 901-566-1110
Fax: 901-566-1910
E-mail: info@jacob-tubing.com

www.jacob-tubing.com

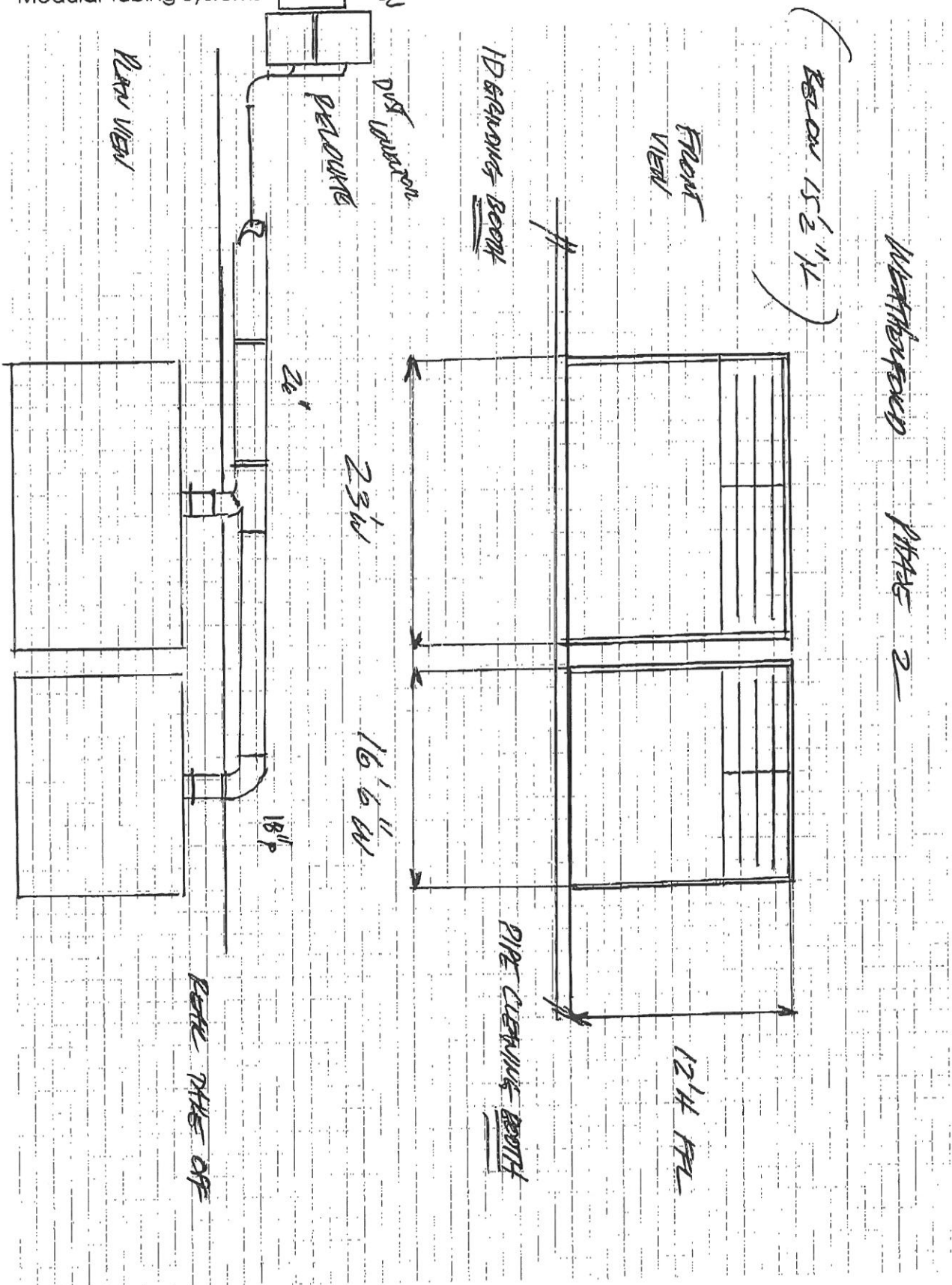

Used in all industrial sectors





Modular Tubing Systems

Jacob Tubing, L.P.
3948 Willow Lake Blvd.
Memphis, TN 38118

Phone: 901-566-1110
Fax: 901-566-1910
E-mail: info@jacob-tubing.com

www.jacob-tubing.com

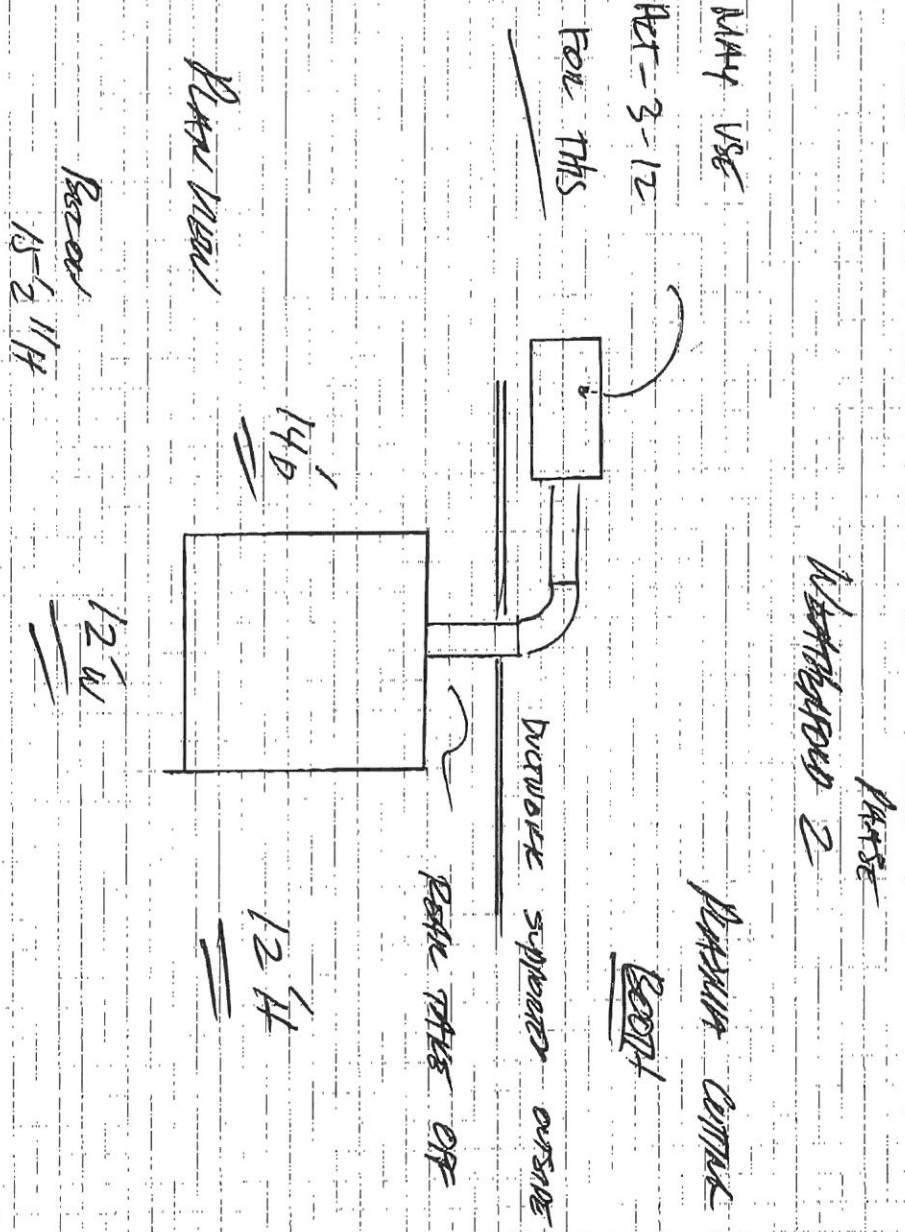

Used in all industrial sectors





Modular Tubing Systems

Jacob Tubing, L.P.
3948 Willow Lake Blvd.
Memphis, TN 38118

Phone: 901-566-1110
Fax: 901-566-1910
E-mail: info@jacob-tubing.com

www.jacob-tubing.com

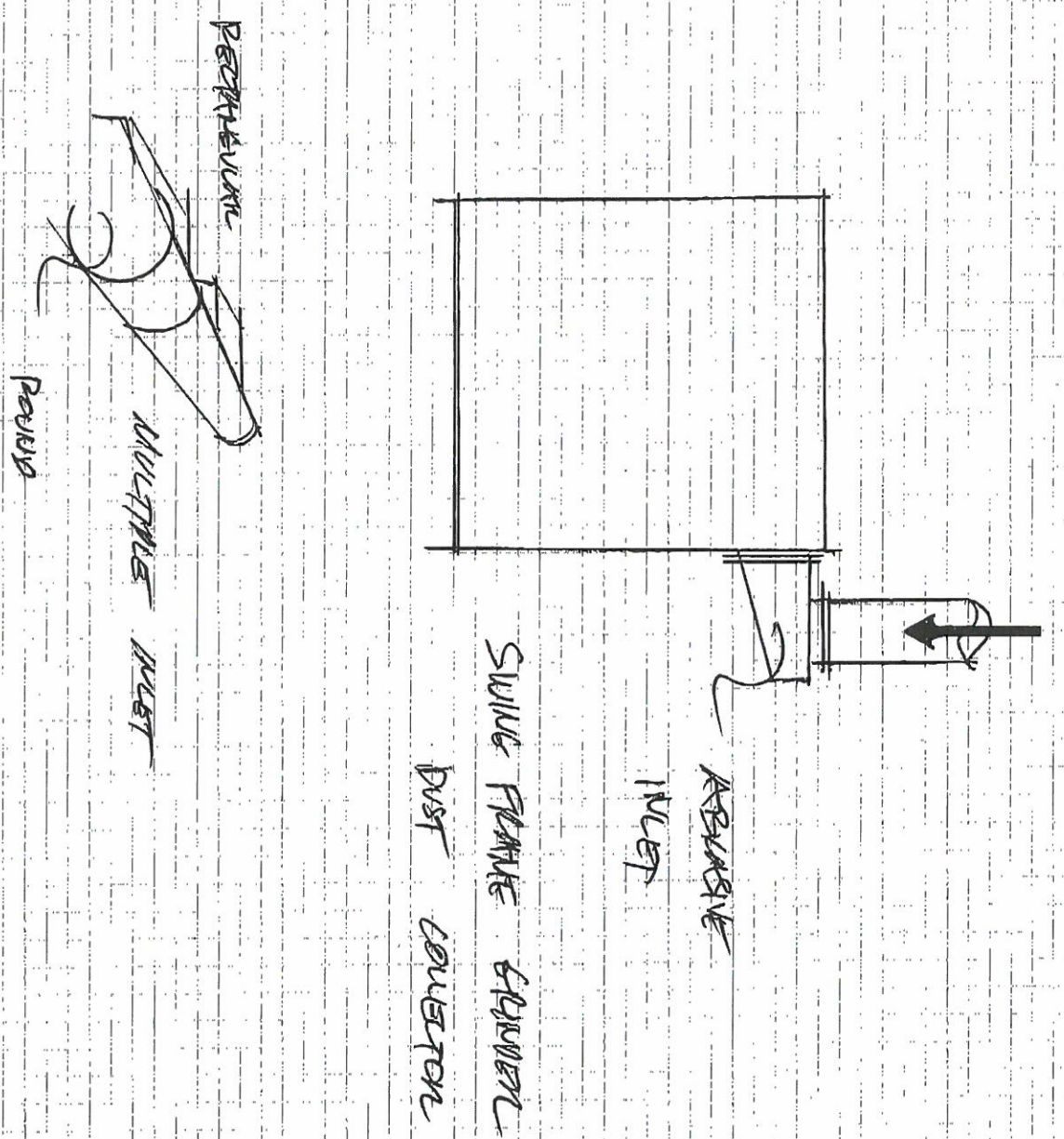

Used in all industrial sectors



I.D. GRINDING-CLEANING STATION DUCT LAYOUT

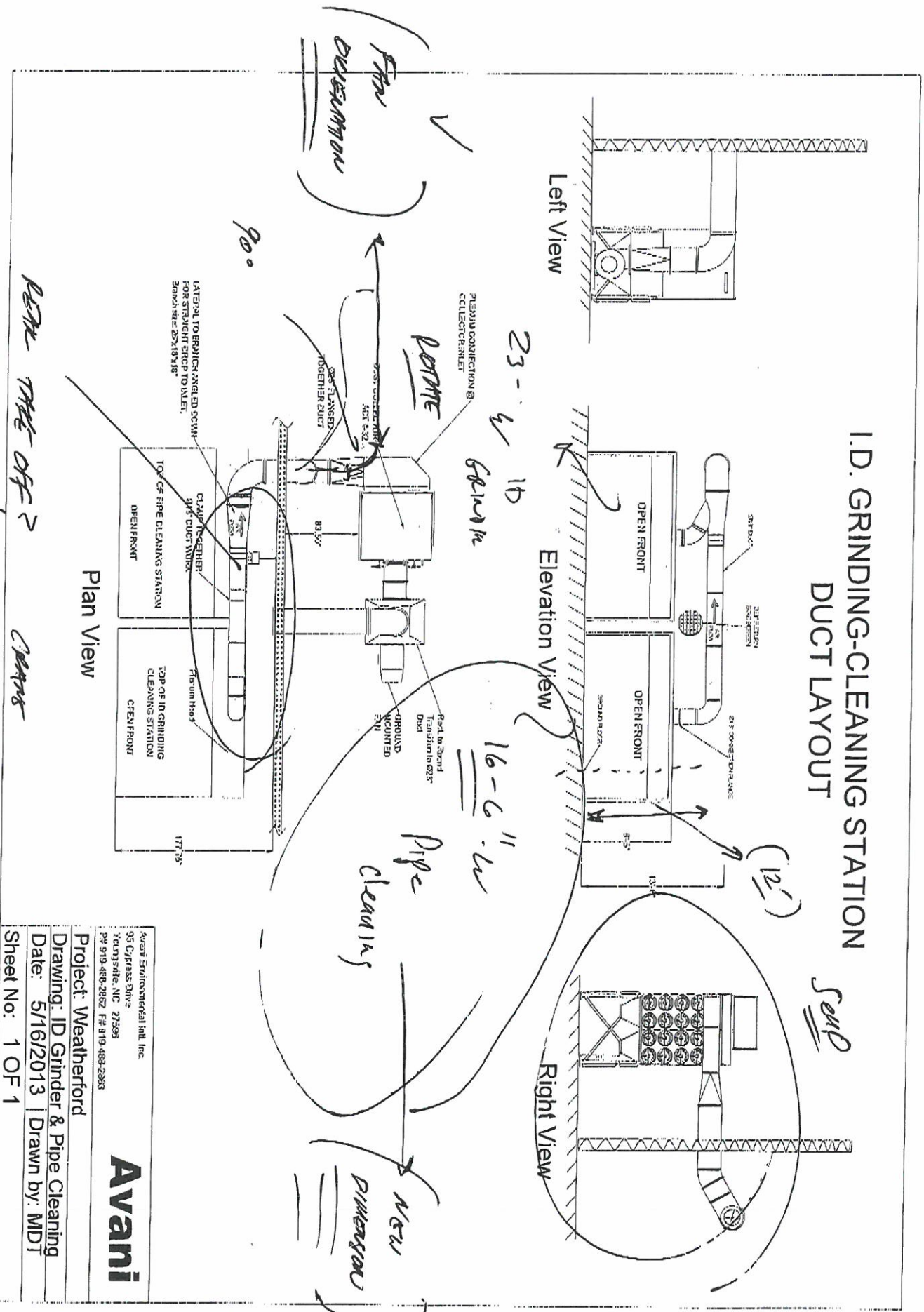

Avani
 50 Cypress Drive
 Raleigh, NC 27609
 PO 919-488-2883

Project: Weatherford
 Drawing: ID Grinder & Pipe Cleaning
 Date: 5/16/2013 Drawn by: MDT
 Sheet No: 1 OF 1

PIPE TAKE OFF ?
 CLEANING
 CLEANINGS

Weatherford - Broussard ID Pipe Cleaning Partition

*Kathy
McCluskey*

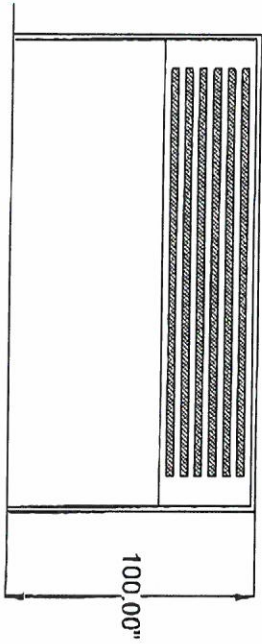

FRONT VIEW

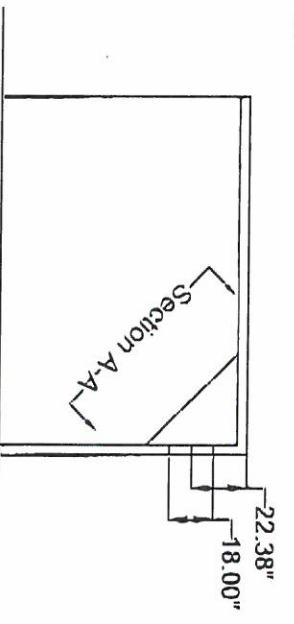

SIDE VIEW

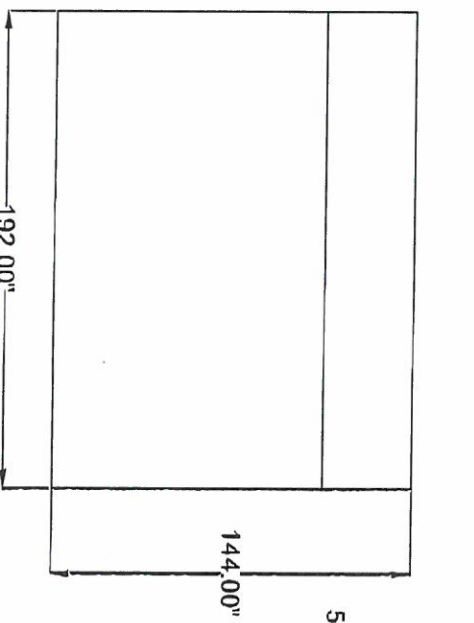

PLAN VIEW

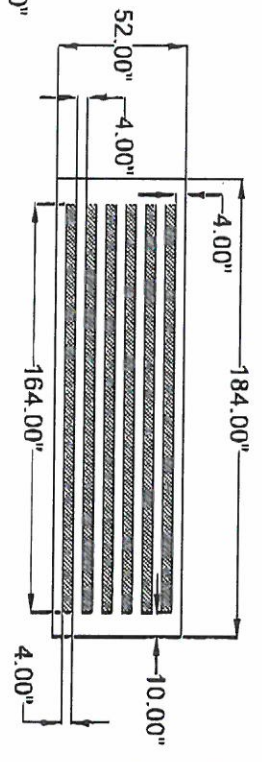

SECTION A-A

- NOTES:
1. Partition to be made by Aerosonics
 2. Two partitions to be fabricated

Avani Environmental, Inc. 95 C/Press Drive Yemassee, NC 27595 PH 919-438-2382 FX 919-438-2663		<h2 style="margin: 0;">Avani</h2>
Project: Weatherford - Phase 2		
Drawing: ID Pipe Cleaning Partition		
Date: 6/28/2013	Drawn by: MDT	
Sheet No: 1 OF 1		

Weatherford - Plasma Table Duct Layout

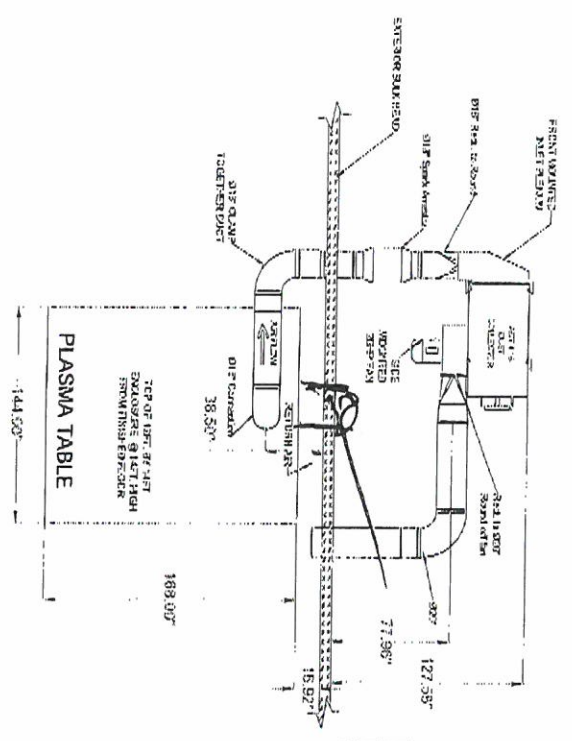
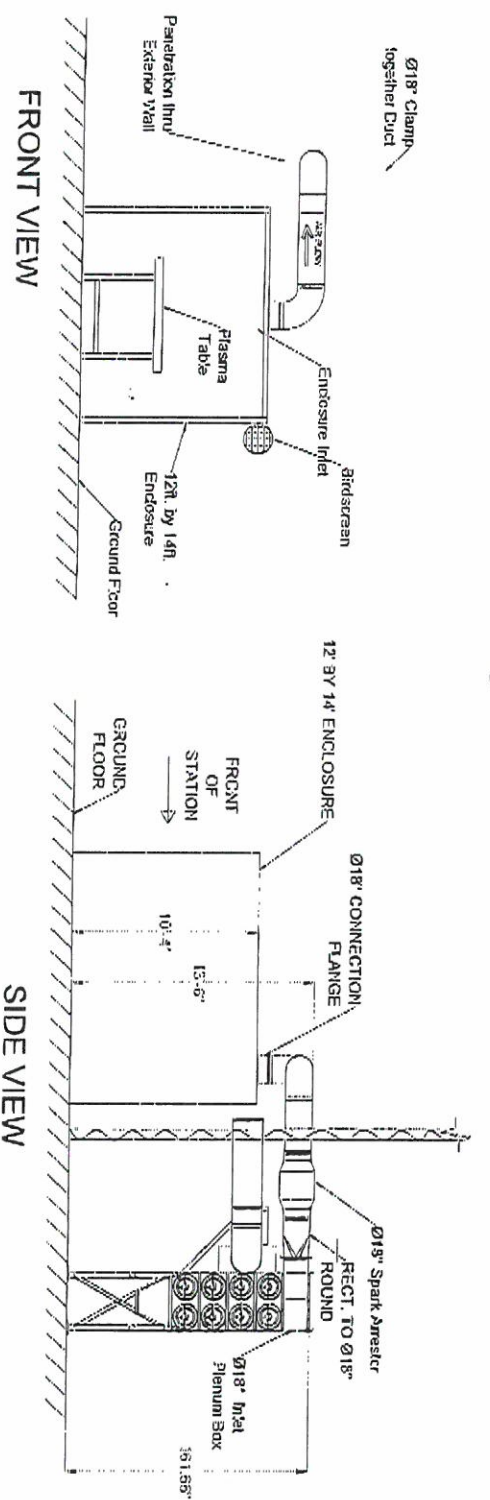

- NOTES:
1. DUCTWORK CONNECT TO ACT 4-18 WITH A 5800 CFM FAN
 2. DISCHARGE OUT OF FAN INTO ROOM
 3. OVERHEAD CRANE RUNS AT 15'

See outside
As shown

Avani Environmental Int'l. Inc. 95 Cypress Drive Youngsville, NC 27596 PH 919-488-2862 FX 919-488-2663		<h2 style="margin: 0;">Avani</h2>
Project: WEATHERFORD		
Drawing: 12' BY 14' ENCLOSURE		
Date: 6/25/2013		Drawn by: MDT
Sheet No: 1 OF 1		

Weatherford - Broussard Plasma Table Partition

ENCLOSURE
Room

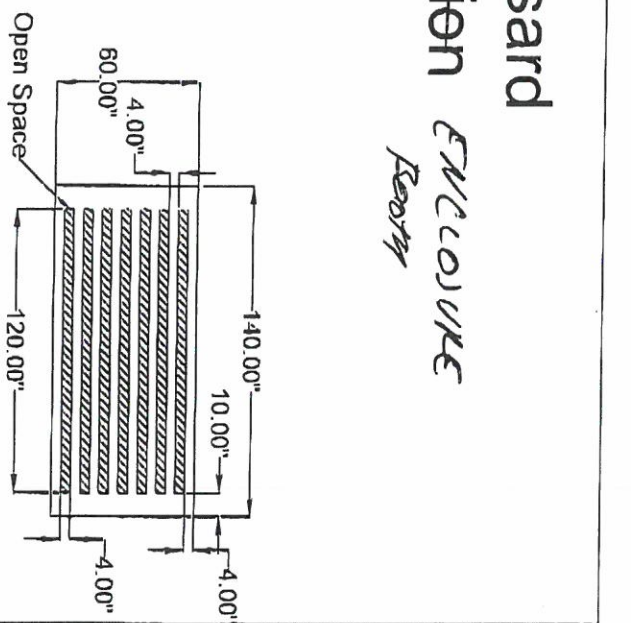
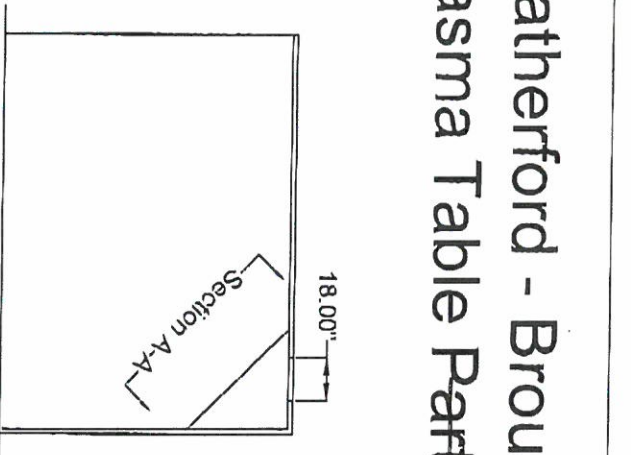
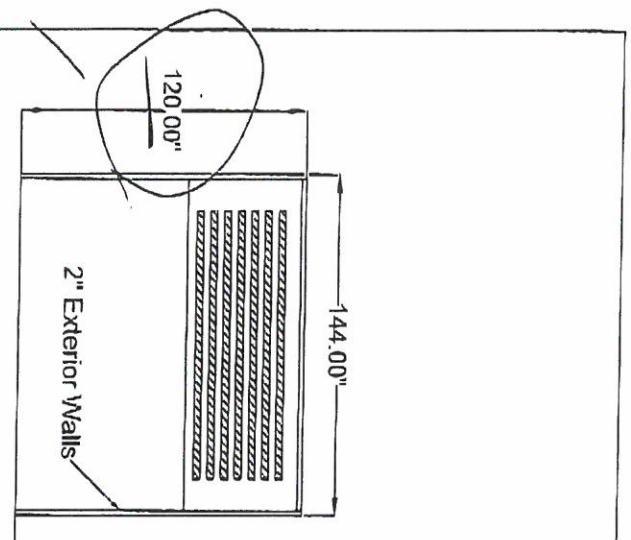

FRONT VIEW

SIDE VIEW

SECTION A-A

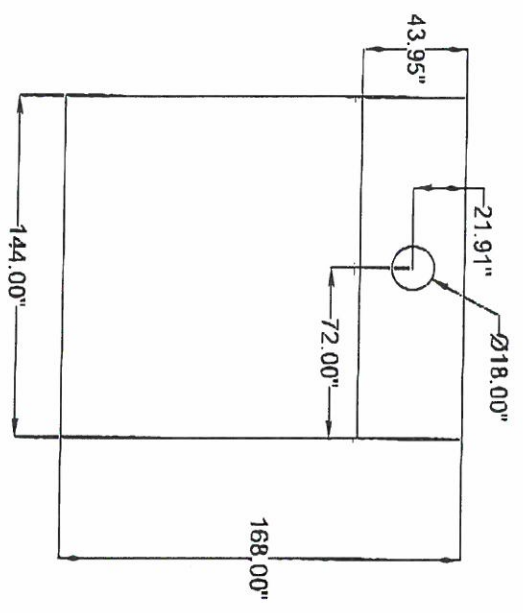

PLAN VIEW

- NOTES:**
1. Baffles made out of single sheet of metal
 2. Baffle material to be 16 GA Steel

Avani Environmental Int'l, Inc. 95 Cypress Drive Youngsville, NC 27566 P# 919-488-2692 F# 919-488-2683	
Avani	
Project: Weatherford - Phase 2	
Drawing: Plasma Table Partition	
Date: 6/18/2013	Drawn by: MDT
Sheet No: 1 OF 1	

Weatherford - Broussard Phase 2 Swing Frame Grinder

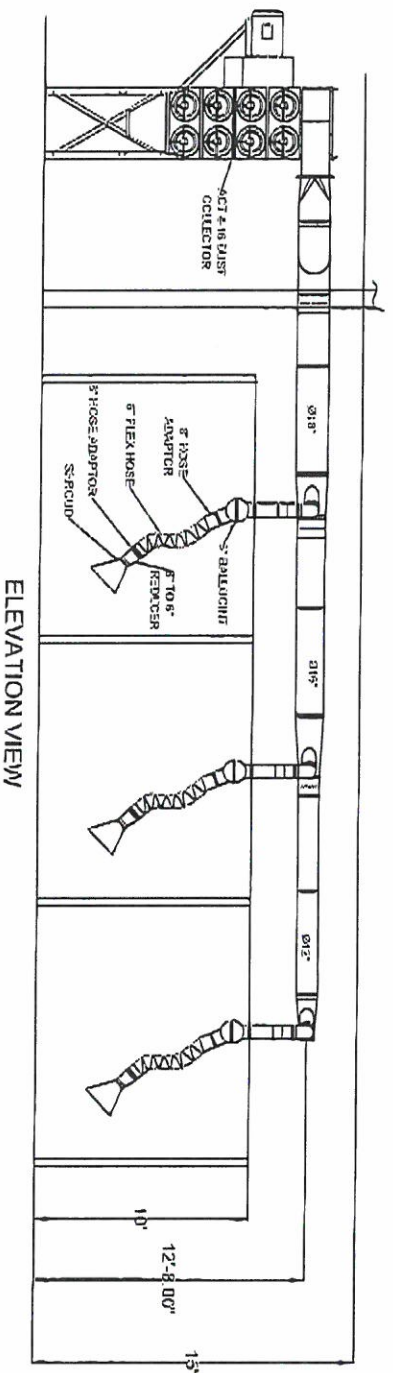
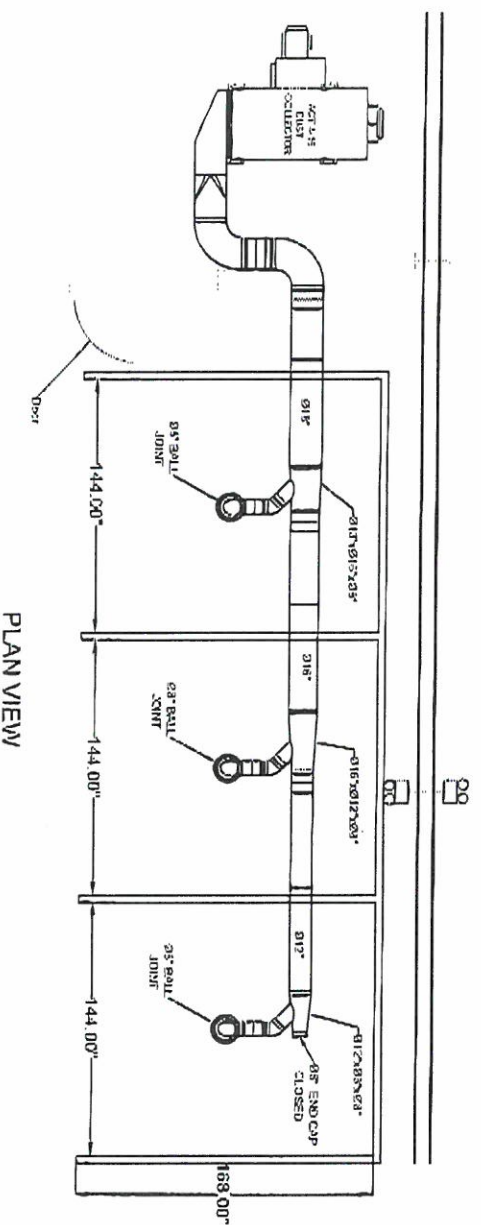

- NOTES:
1. DUCTWORK CONNECT TO ACT-4-16 WITH A 5899 CFM FAN
 2. DISCHARGE OUT OF FAN INTO ROOM
 3. OVERHEAD CRANE RUNS AT 15'

Avani
Avani Engineering, Inc. 54 Green Oaks Vancouver, BC V7V 5G8 Tel: 604-263-2822 Fax: 604-263-2823
Project: Weatherford - Phase 2 Drawing: Swing Frame Grinder Date: 5/15/2013 Drawn by: MDT Sheet No: 1 OF 1

Weatherford - Broussard Swing Frame Partition

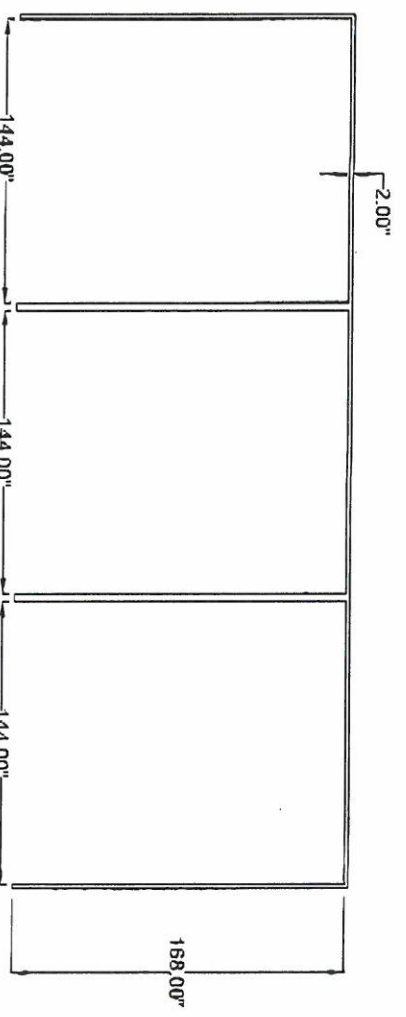

PLAN VIEW

NOTES:
1. Partition to be made by Aerosonics

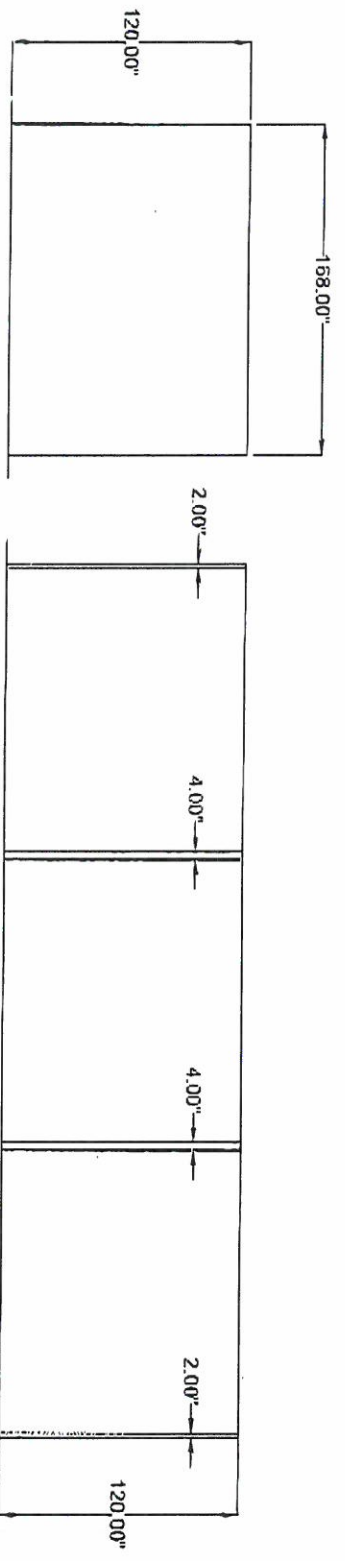

ELEVATION VIEW

<small>Avani Engineering, Inc. 5650 W. 13th Street Tomball, TX 77375 P: 281-410-2000 F: 281-410-2100</small>		<h2 style="margin: 0;">Avani</h2>
Project: Weatherford - Phase 2		
Drawing: Swing Frame Grinder		
Date: 6/27/2013		
Drawn by: MDT		
Sheet No: 1 OF 1		

Weatherford - Broussard Phase 2 Swing Frame Grinder

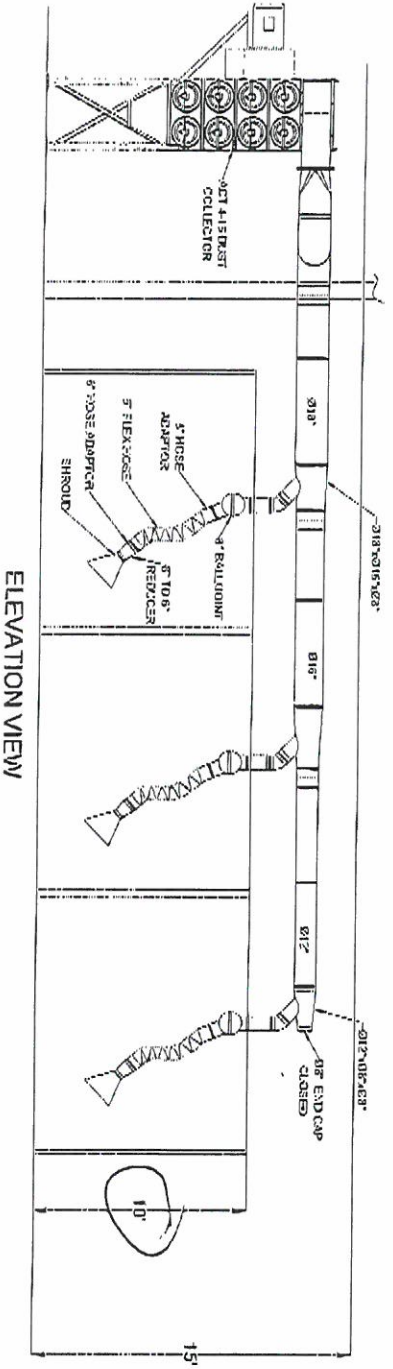
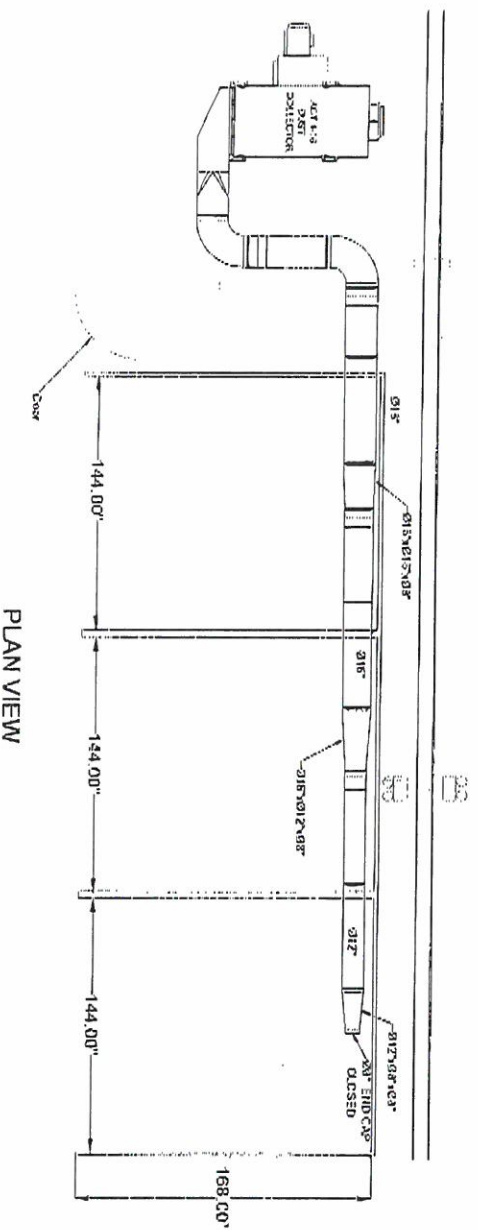

- NOTES:
1. DUCTWORK CONNECT TO ACT-4-16 WITH A 5800 CFM FAN
 2. DISCHARGE OUT OF FAN INTO ROOM
 3. OVERHEAD CRANE RUNS AT 15'

Avani Erectors, Inc. 55 Corporate Drive Weatherford, TX 79781 797-408-2527 Fax 797-408-2528	<h2 style="margin: 0;">Avani</h2> <p>Project: Weatherford - Phase 2 Drawing: Swing Frame Grinder Date: 6/25/2013 Drawn by: MDT Sheet No: 1 OF 1</p>
--	--

Jacob Tubing, L.P.
 3948 Willow Lake Blvd.
 Memphis, TN 38118
 Phone: 901-566-1110
 Fax: 901-566-1910
 E-mail: info@jacob-tubing.com
 www.jacob-tubing.com



Modular Tubing Systems



SEA LEVEL
 FRAME, LIT

SWING ARM
 & BOOM EXTENSION SYSTEM

BOOM
 &
 ARM
 (4)

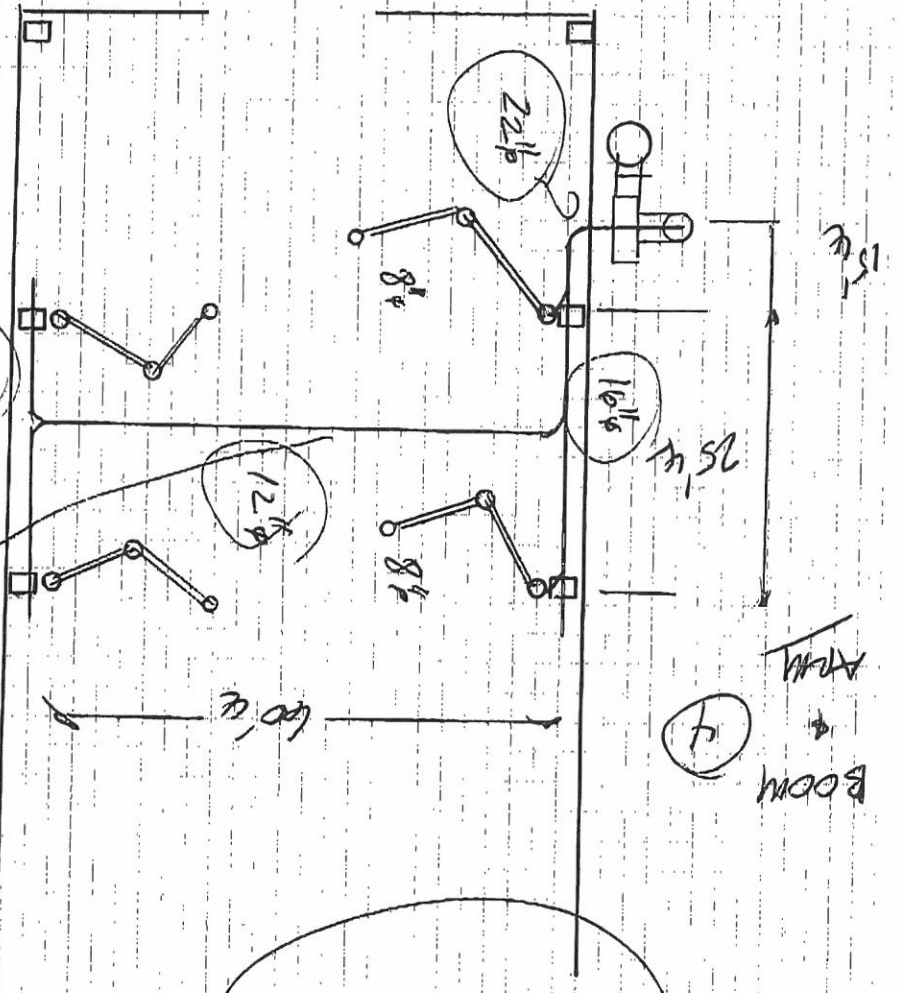

UP HAND OVER
 CLAMP
 PART

NO V
 CENTER

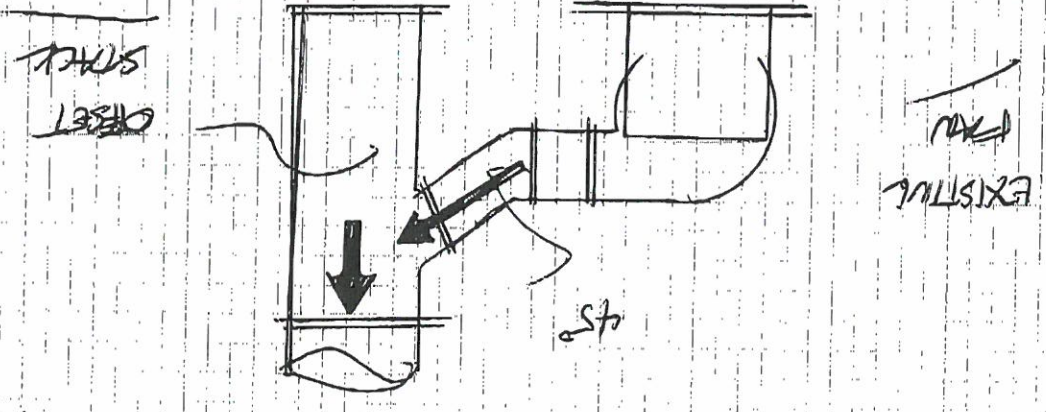

Used in all industrial sectors





Modular Tubing Systems

Jacob Tubing, L.P.
3948 Willow Lake Blvd.
Memphis, TN 38118

Phone: 901-566-1110
Fax: 901-566-1910
E-mail: info@jacob-tubing.com

www.jacob-tubing.com

Pressure Rating = 16 HPR

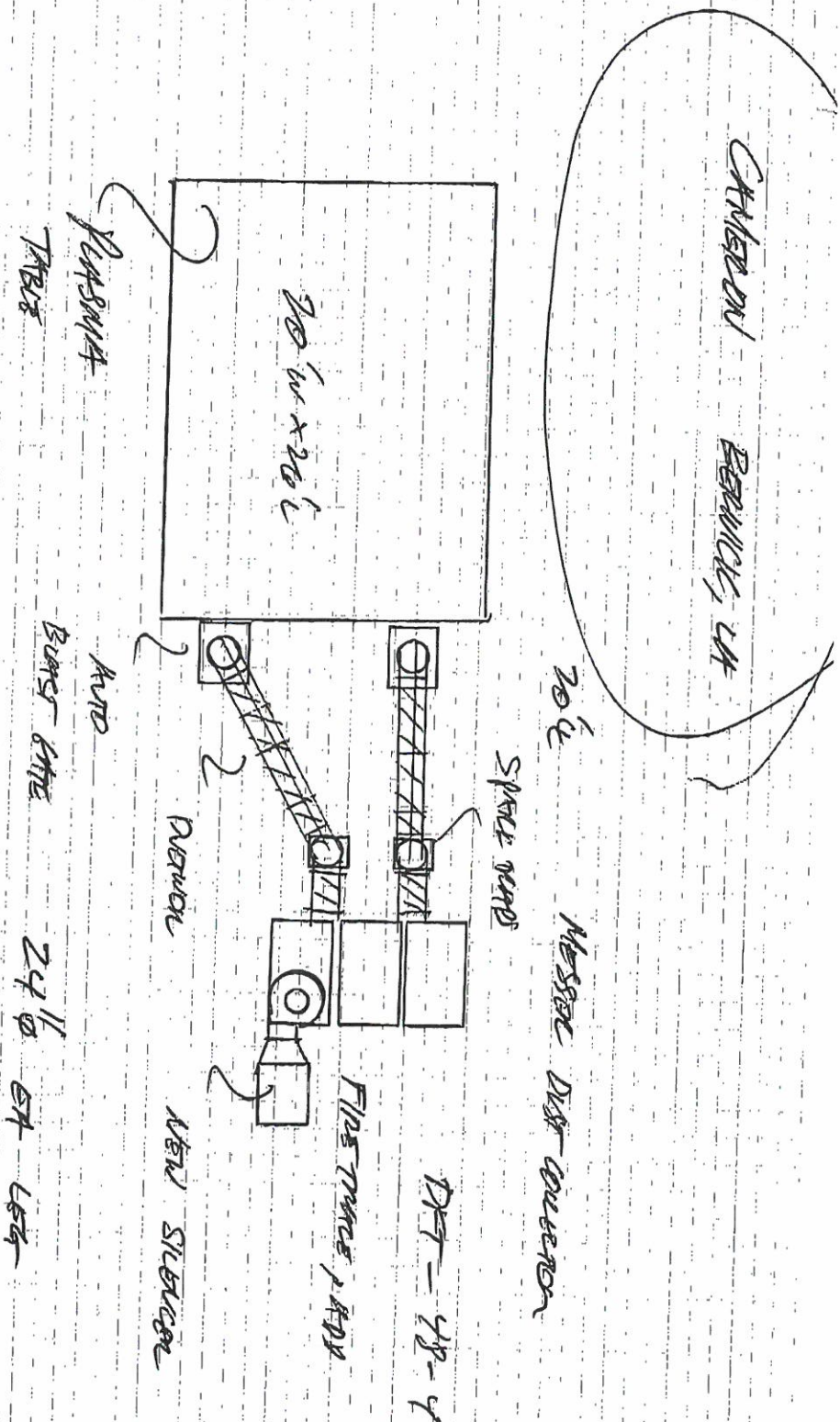

Used in all industrial sectors

