

Weatherford - Broussard Plasma Table Enclosure Booth

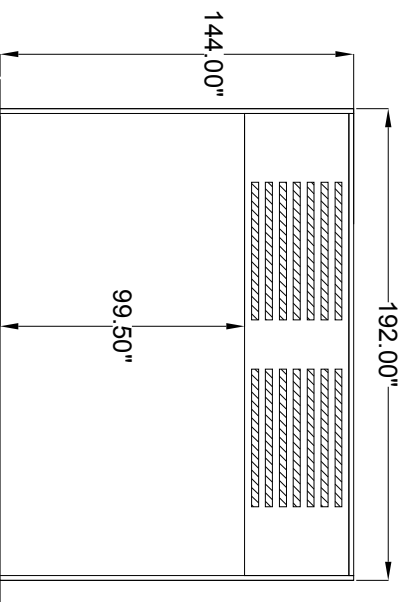

FRONT VIEW

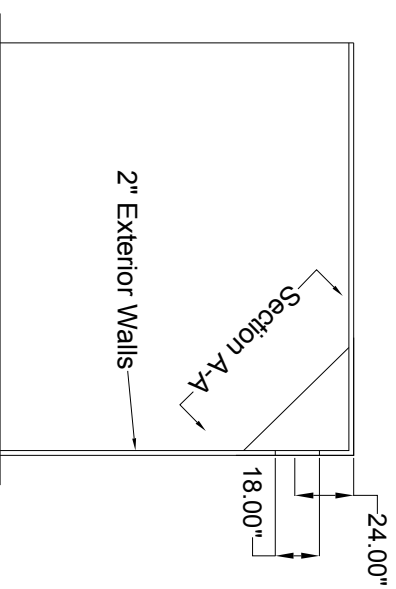

SIDE VIEW

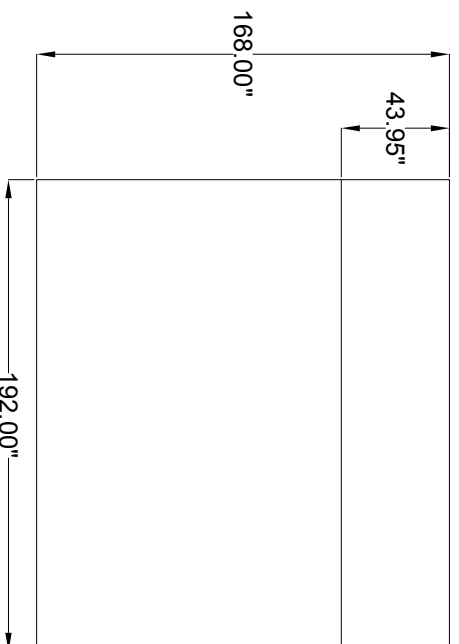

PLAN VIEW

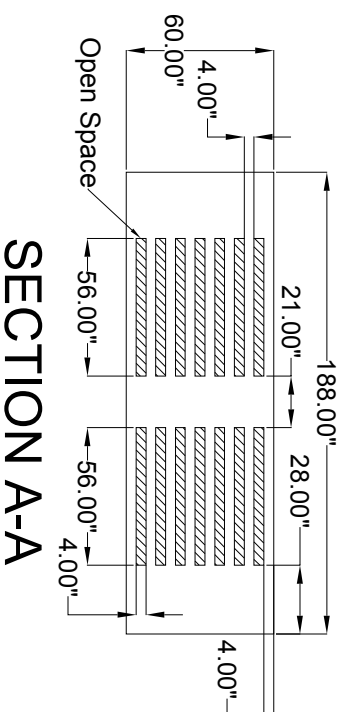

SECTION A-A

- NOTES:
1. Baffles made out of single sheet of metal
 2. Baffle material to be 16 GA Steel

Avani Environmental Intl. Inc.
95 Cypress Drive
Youngsville, NC 27596
P# 919-488-2862 F# 919-488-2863

Avani

Project: Weatherford - Phase 2
Drawing: Plasma Table Partition
Date: 8/12/2013 Drawn by: MDT
Sheet No: 1 OF 1