

DO NOT SCALE

IF IN DOUBT ASK

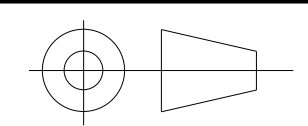

Revisions			
Rev	Description	Date	Approved

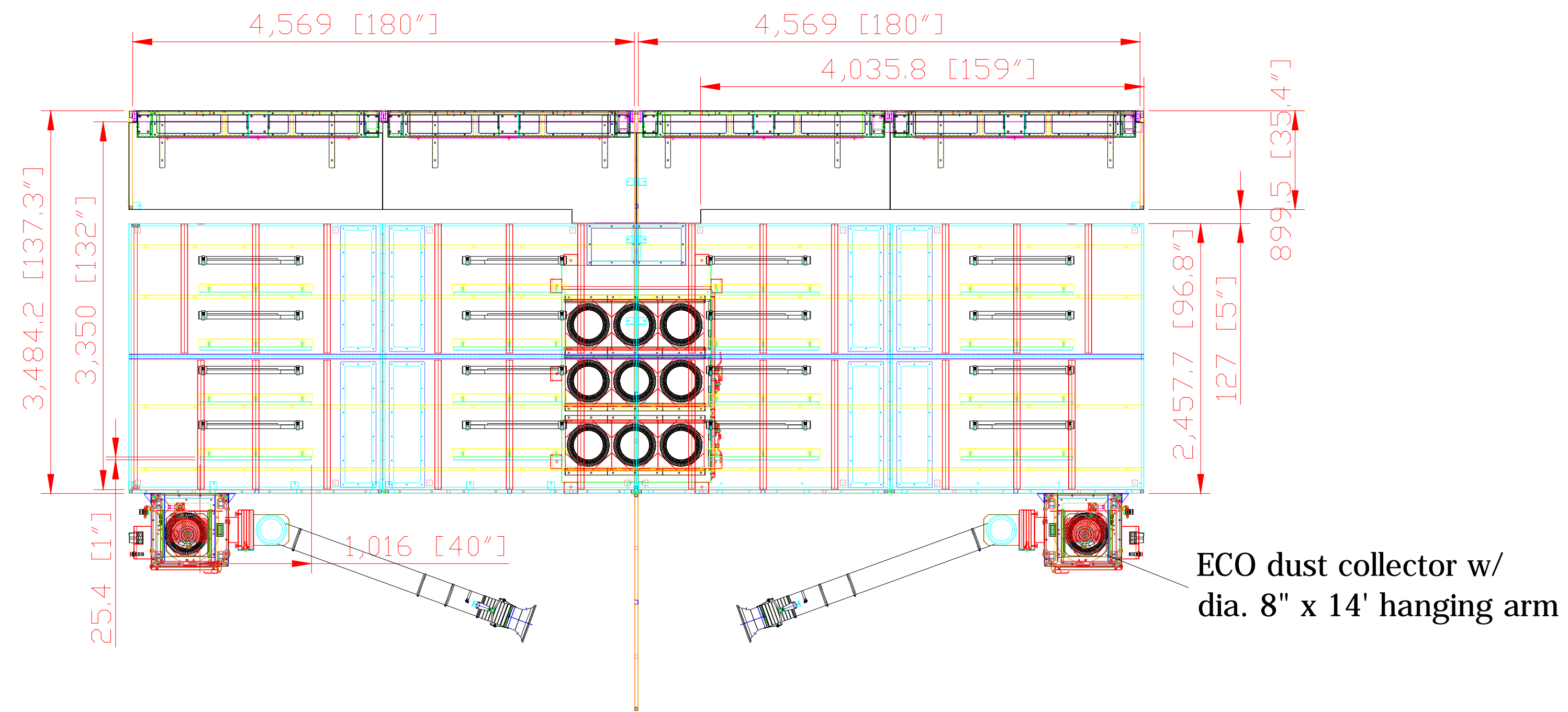

SDC-15-9 Type I:

- 15HP x 1 pc (TEFC)
- 9 cartridges: each $\phi 15"$ x 26"L
- 8,000 CFM @ 6" SP (CFM tested at inlet, test method equal to SDC large cartridge collectors)

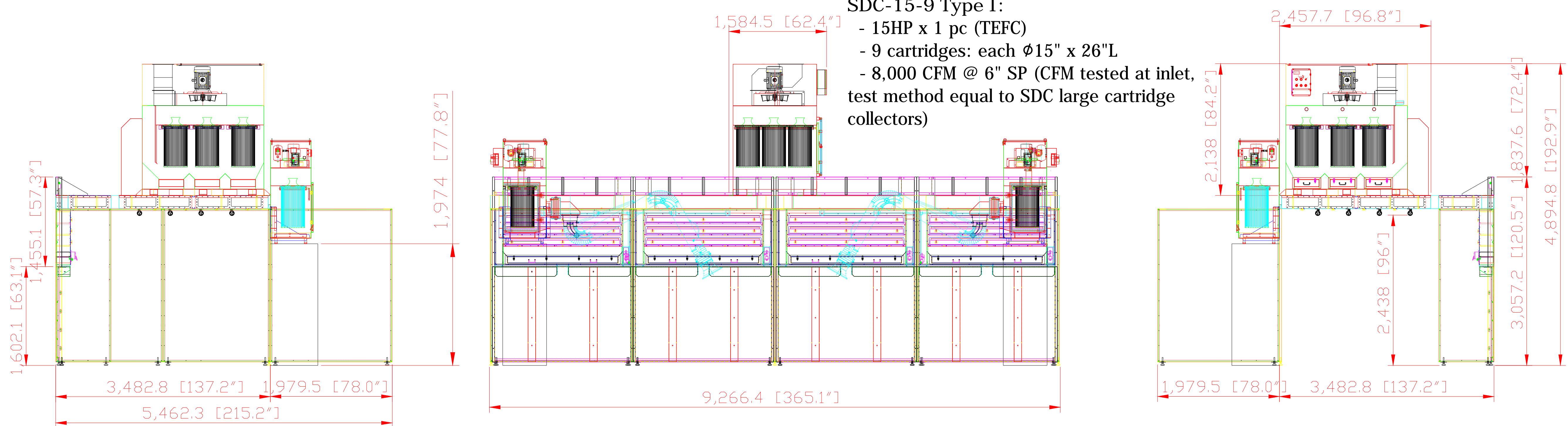

AVANI ENVIRONMENTAL INTL. INC. Sales Department

95 Cypress Drive
Youngsville, NC 27596

(919) 570-2862
info@avanienvironmental.com

Date	Name	Part Number:
2012-10-31	***	**
Drawn by:	Checked by:	
The drawings, AutoCAD, 3-D Models, and specifications are the property of Avani Environmental Intl. Inc. (AE) and may not be reproduced, distributed, modified, or otherwise used, except provided herein, without the express written permission of AE.		

Title:
WB-6000 series: 15'W x 11'D

Size	Scale	Drawing Number:
B	1 = 95	15' x 11'