

1. ALL EXTERIOR DIMENSIONS ARE FROM FACE OF MASONRY TO FACE OF MASONRY.
2. ALL INTERIOR DIMENSIONS ARE FROM COLUMN CENTERLINE TO CENTERLINE OF STUD WALL OR FACE OF MASONRY WALLS.
3. DIMENSIONS SHOWN FOR OPENINGS ARE ROUGH OPENING DIMENSIONS UNLESS NOTED OTHERWISE.
4. ALL NEW WALLS ARE WALL TYPE "W1" UNLESS OTHERWISE NOTED.
5. ADA REQUIRES THAT DOOR CLEARANCE FROM EDGE OF DOOR TO EDGE OF PERPENDICULAR WALL OR OBSTRUCTION IS MINIMUM OF 12" ON THE PUSH SIDE AND 18" ON THE PULL SIDE. PRIOR TO FRAME INSTALLATION, BRING DISCREPANCIES TO THE ARCHITECT'S ATTENTION.
6. PLUMBING FIXTURE LOCATIONS (UNLESS NOTED OTHERWISE):
 - *TOILETS 18" O.C. FROM ADJACENT WALL SURFACE
 - *SINKS CENTERED IN CABINET
 - *LAVATOIRES 15" O.C. FROM ADJACENT FINISH WALL.
7. THE EXISTING FLOOR IN ROOM 301 IS SLOPED THEREFORE ALL BOOTHS WILL REQUIRE LEVELING LEGS
8. ALL INFILL WALLS ARE TO BE PAINTED ON INTERIOR OF BUILDING TO MATCH EXISTING INTERIOR WALLS UNLESS OTHERWISE NOTED ON FINISH SCHEDULE

WALL RATING LEGEND:

- EXISTING 4-HOUR RATED WALL
- ===== NEW 8" CMU
- XL WALL IDENTIFICATION TAG

KEYNOTE LEGEND:

- (KN-1) 6' x 6' WELDING BOOTH (40) SEE A7-1 FOR DETAILS
- (KN-2) 4' x 3' GRINDING BOOTH (8) SEE A7-1 FOR DETAILS
- (KN-3) 2' x 2' CUTTING STATION (10) SEE A7-1 FOR DETAILS
- (KN-4) EQUIPMENT N.I.C.
- (KN-5) NEW EYE WASH STATION SEE PLUMBING DRAWINGS
- (KN-6) FUTURE 6' x 6' WELDING BOOTHS N.I.C.
- (KN-7) 4 PERSON LAVATORY SEE PLUMBING DRAWINGS
- (KN-8) EXISTING EYEWASH STATION TO REMAIN
- (KN-9) SERVICE SINK SEE PLUMBING DRAWINGS
- (KN-10) HIGH/LOW E.W.C. SEE PLUMBING DRAWINGS
- (KN-11) DISASSEMBLE AND RELOCATE EXISTING TOOL STORAGE CAGE TO LOCATION SHOWN ON PLANS
- (KN-12) PROVIDE NEW TOOL CAGE WEST WALL TO MATCH EXISTING
- (KN-13) PROVIDE NEW 6" CONC. SLAB ON 6" STONE BASE FOR MICH EQUIP.

CONTRACTORS OPTION

PURCHASE WELDING, GRINDING, AND CUTTING BOOTHS VERSUS CONSTRUCTING THEM FROM STOCK MATERIAL.

ROOM SIGNS

PROVIDE SIGNS FOR MEN'S AND WOMEN'S BATHROOMS
PROVIDE 2 SIGNS IN THE GRINDING ROOM (312) STATING "GRINDING OF ALUMINUM IS STRICTLY PROHIBITED" IN A CONSPICUOUS PLACE ABOVE THE GRINDING BOOTHS ON THE EAST AND WEST WALLS

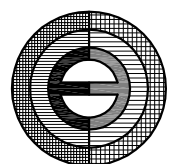

ENWRIGHT
ASSOCIATES, INC.

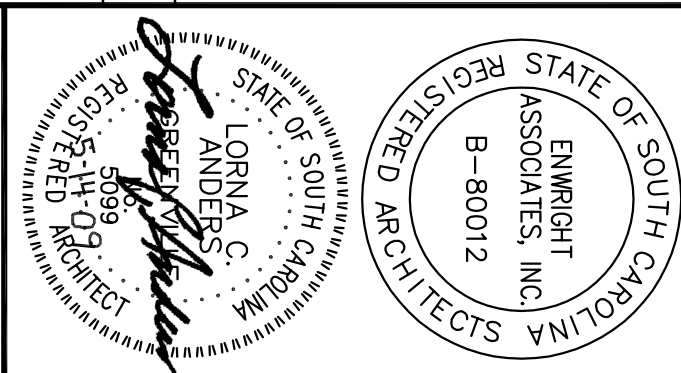

NO.	DATE	REVISION
JOB NO.	09GTECWELDING	DATE 6/15/09
DRAWN BY	JD	

FLOOR PLAN

COMPLEX KEY PLAN

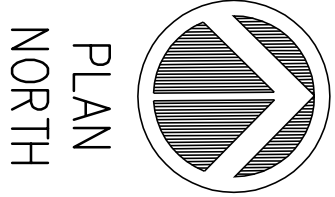
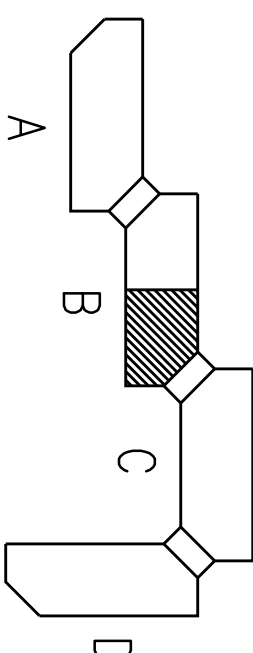

A1-1

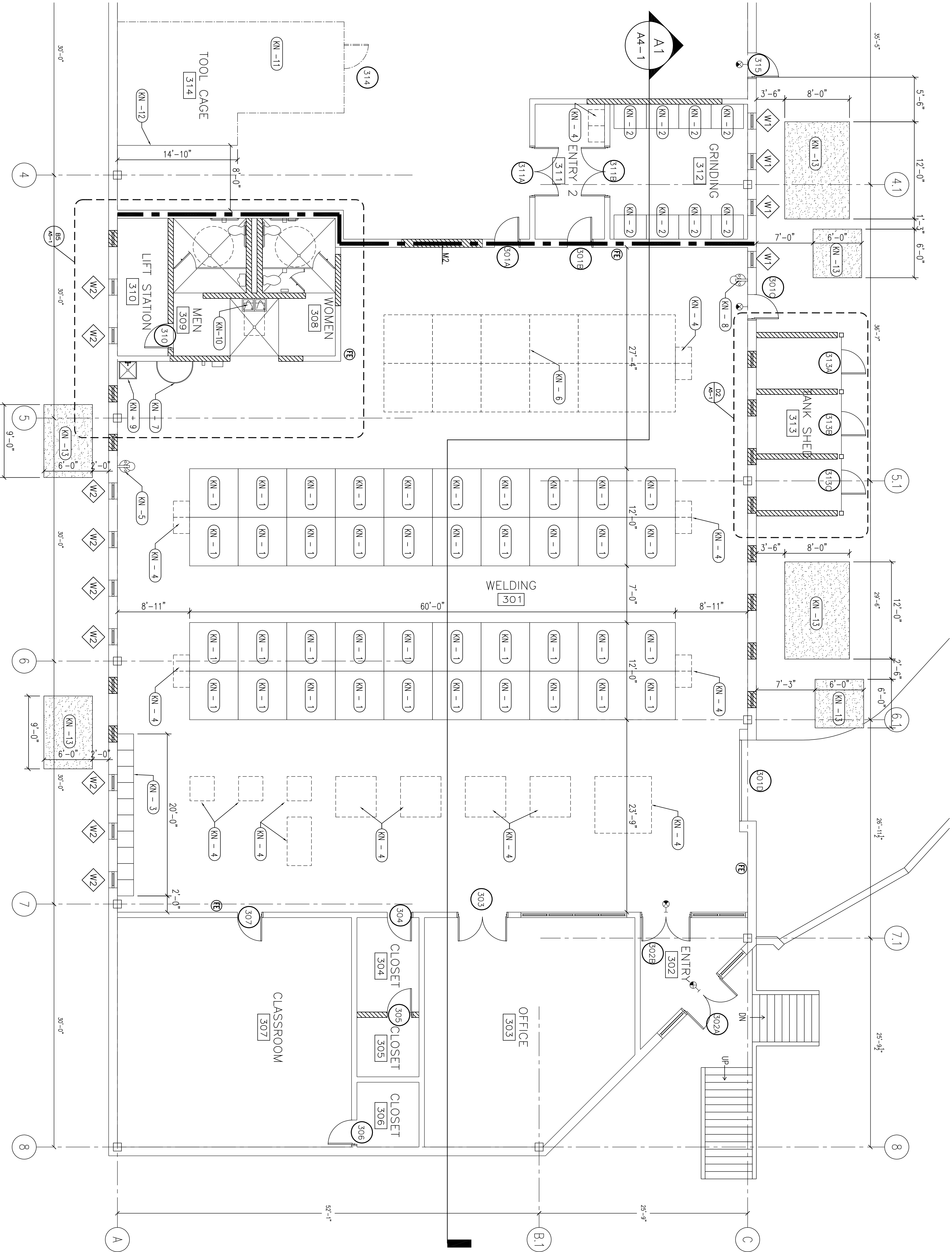

FLOOR PLAN
3/16" = 1'-0"
A1
A1-1