

Stand Detail Drawing

Plan view of the stand footprint

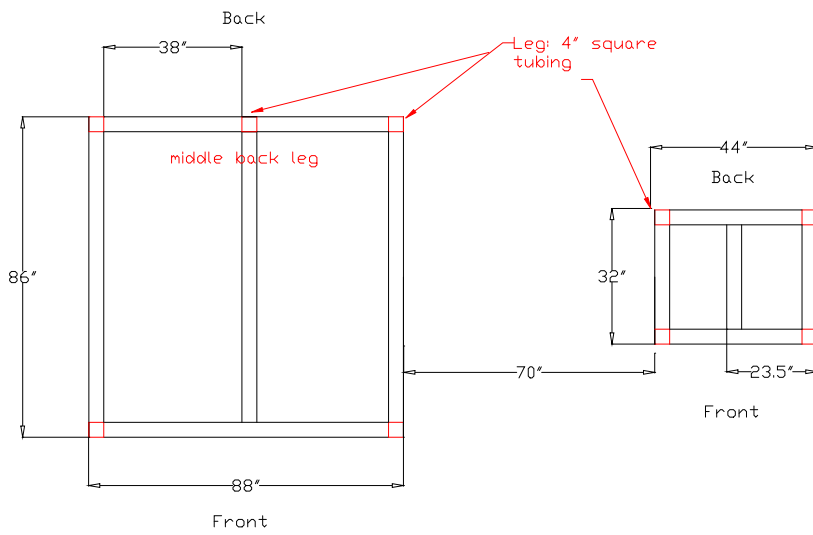

Foot Plate Detail for each leg

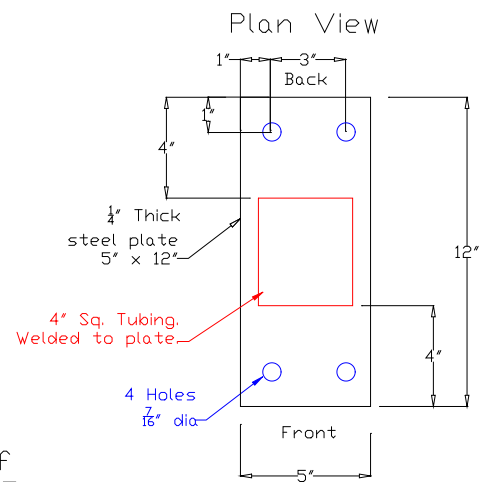

Weight of Elevation View Absolent is 8000Lbs

Weight of Exhaust Fan is 2000Lbs

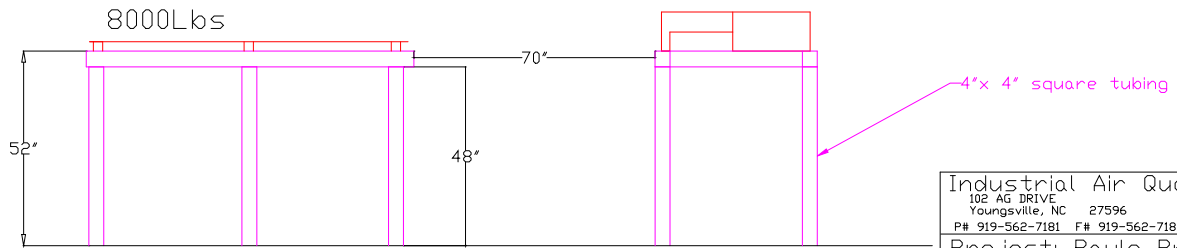

Industrial Air Quality		IAQ
102 AG DRIVE Youngsville, NC 27596		
P# 919-562-7181	F# 919-562-7182	
Project: Paulo Products		
Drawing: Stand Drawing		
Date: 5/6/09	Drawn by: RAV	
Sheet No: 2 of 2		