



**Date:** February 24, 2015

**Project:**

**To:** McCown Gordon Construction

**Attn:**

**Recommended Equipment:**

- (5) WB-5087 welding booth: 8' x 7'
- (1) WB-5810 welding booth: 8' x 10'
- (1) WB-5088G Grinding Booth with front door
  - 8' x 10' x 8'
  - Front door equipped with inlet louvers and windows

---

**Avani Environmental Intl. Inc.**  
95 Cypress Drive  
Youngsville, NC 27596  
[www.avanienvironmental.com](http://www.avanienvironmental.com)

Phone: (919) 570-2862  
Fax: (919) 570-2863  
Email: [info@avanienvironmental.com](mailto:info@avanienvironmental.com)  
[www.weldingbooths.com](http://www.weldingbooths.com)

The drawings, AutoCAD, 3-D Models, and specifications are the property of Avani Environmental Intl. Inc. (AE) and may not be reproduced, distributed, modified, or otherwise used, except provided herein, without the express written permission of AE.

DO NOT SCALE

IF IN DOUBT ASK



Revisions			
Rev	Description	Date	Approved

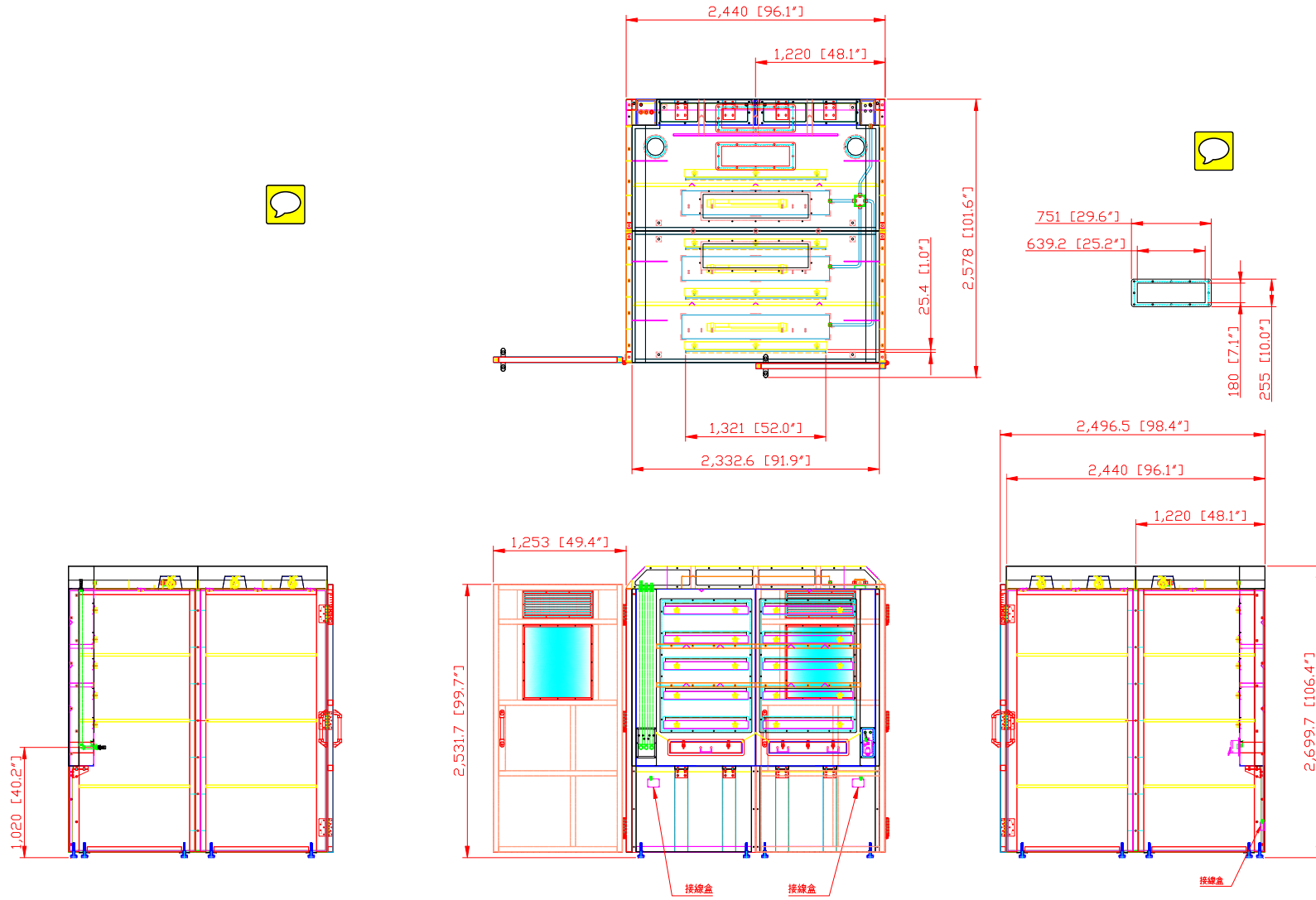

AVANI ENVIRONMENTAL INTL. INC. Sales Department  
 95 Cypress Drive  
 Youngsville, NC 27596  
 (919) 570-2862  
 info@avanienvironmental.com

Date	2015-02-24	Name	***	Part Number: <b>REVISION VI</b>
Drawn by:		Checked by:		
The drawings, AutoCAD, 3-D Models, and specifications are the property of Avani Environmental Intl. Inc. (AE) and may not be reproduced, distributed, modified, or otherwise used, except provided herein, without the express written permission of AE.				

Title: <b>WB-5088G</b>		Drawing Number: <b>WB-8-8-8G</b>
<b>Close up on outlet/gas connect.</b>		
Size <b>B</b>	Scale 1 = 35	

DO NOT SCALE

IF IN DOUBT ASK



Revisions			
Rev	Description	Date	Approved

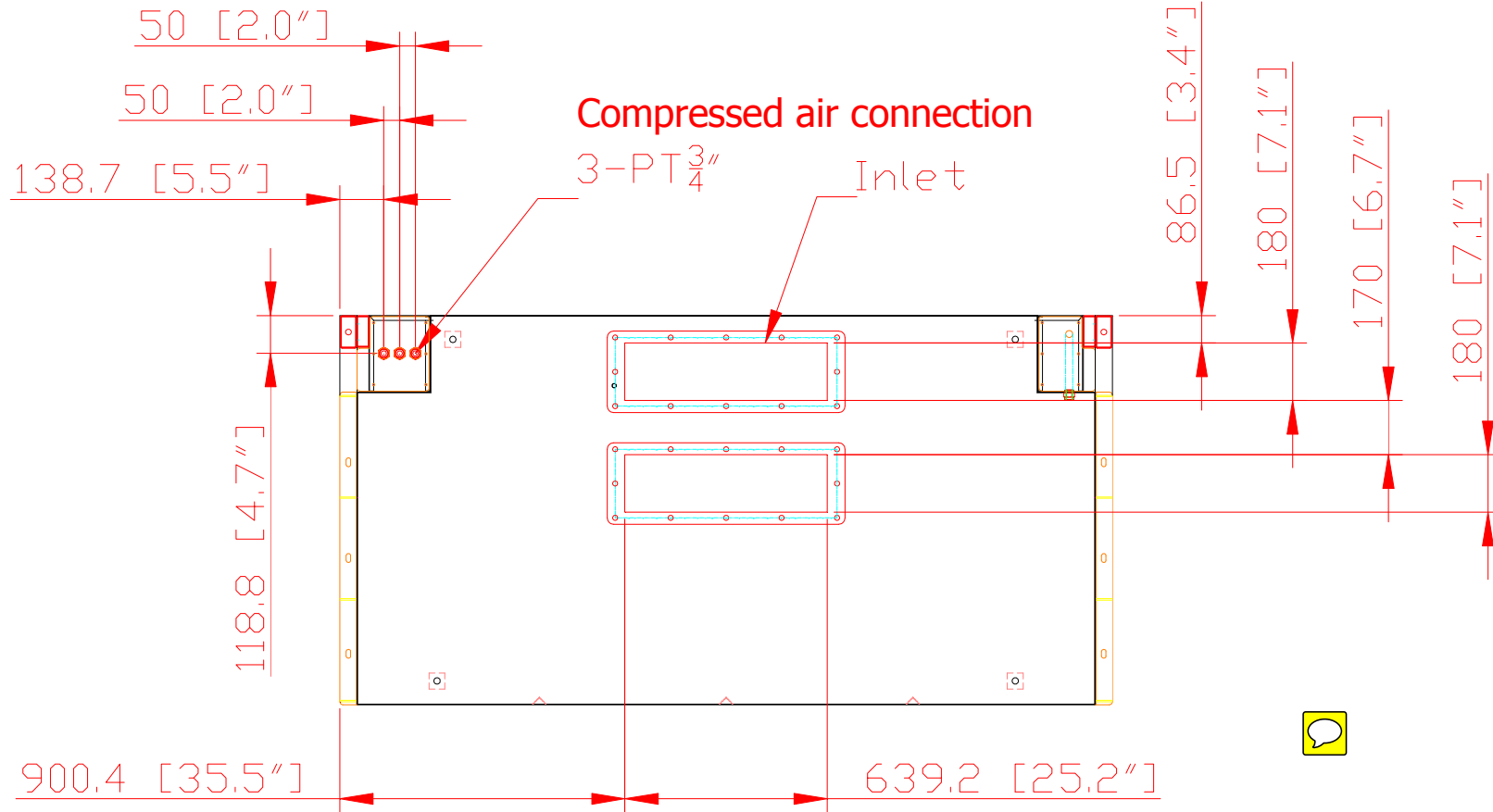

AVANI ENVIRONMENTAL INTL. INC. Sales Department  
 95 Cypress Drive  
 Youngsville, NC 27596  
 (919) 570-2862  
 info@avanienvironmental.com

	Date	Name	Part Number:
Drawn by:	2015-02-24	***	Position I
Checked by:			
The drawings, AutoCAD, 3-D Models, and specifications are the property of Avani Environmental Intl. Inc. (AE) and may not be reproduced, distributed, modified, or otherwise used, except provided herein, without the express written permission of AE.			

Title:		WB-5088G
Inlet and Compressed Air Connection position.		Drawing Number:
Size	Scale	WB-8-8-8G
B	1 = 35	REVISION B

DO NOT SCALE

IF IN DOUBT ASK



Revisions			
Rev	Description	Date	Approved

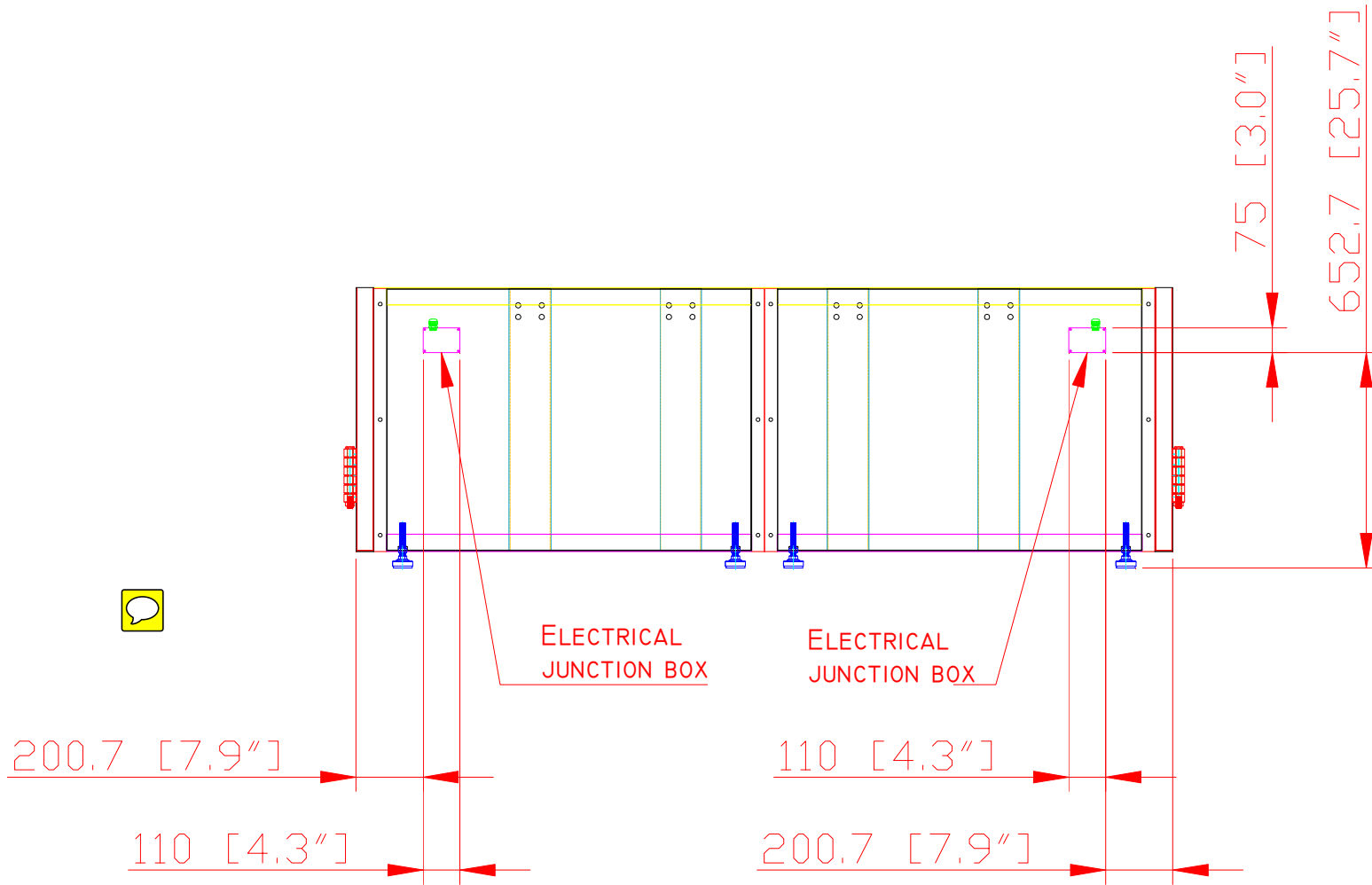

AVANI ENVIRONMENTAL INTL. INC. Sales Department  
 95 Cypress Drive  
 Youngsville, NC 27596  
 (919) 570-2862  
 info@avanienvironmental.com

	Date	Name	Part Number:
Drawn by:	2015-02-24	***	Position I
Checked by:			

Title: **WB-5088G**  
 Electrical Junction Box position.

The drawings, AutoCAD, 3-D Models, and specifications are the property of Avani Environmental Intl. Inc. (AE) and may not be reproduced, distributed, modified, or otherwise used, except provided herein, without the express written permission of AE.

Size **B**  
 Scale 1 = 35

Drawing Number:  
**WB-8-8-8G**  
 REVISION B

DO NOT SCALE

IF IN DOUBT ASK

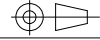

Revisions			
Rev	Description	Date	Approved

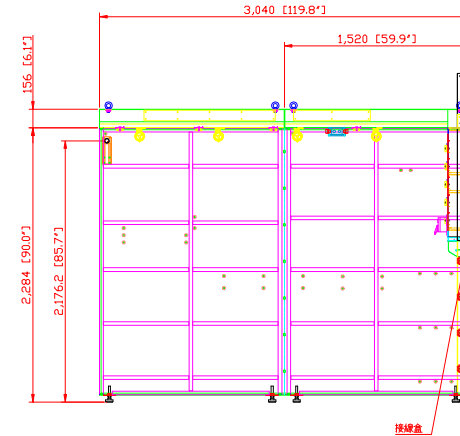
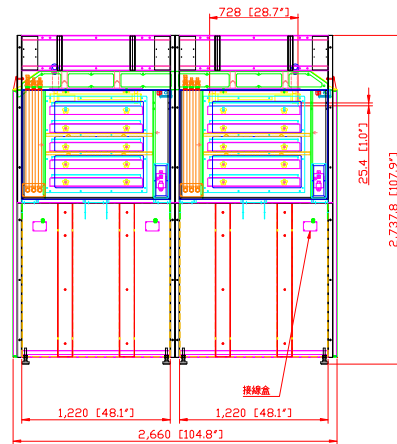
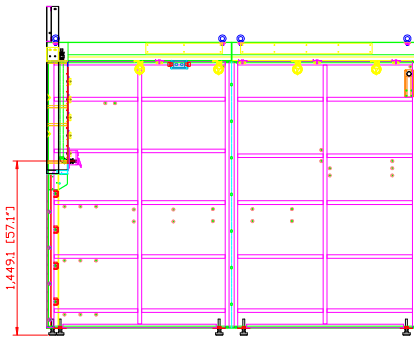
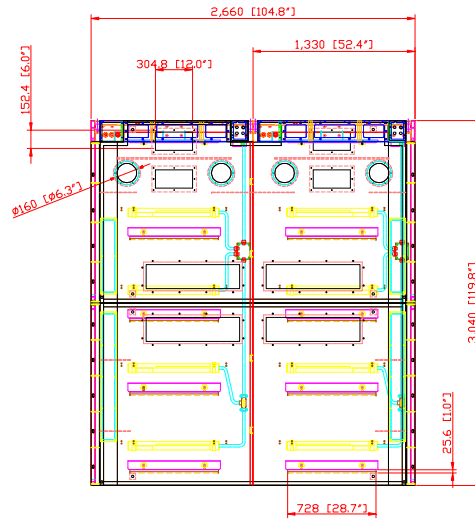

AVANI ENVIRONMENTAL INTL. INC. Sales Department  
 95 Cypress Drive  
 Youngsville, NC 27596  
 (919) 570-2862  
 info@avanienvironmental.com

	Date	Name
Drawn by:	2015-02-24	***
Checked by:		

Part Number:  
**REVISION VI**

Title: **WB-5810**  
 Close up on junc. box/gas connect

The drawings, AutoCAD, 3-D Models, and specifications are the property of Avani Environmental Intl. Inc. (AE) and may not be reproduced, distributed, modified, or otherwise used, except provided herein, without the express written permission of AE.

Size **A** Scale 1 = 35

Drawing Number:  
 \*\*\*

DO NOT SCALE

IF IN DOUBT ASK

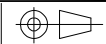

Revisions			
Rev	Description	Date	Approved

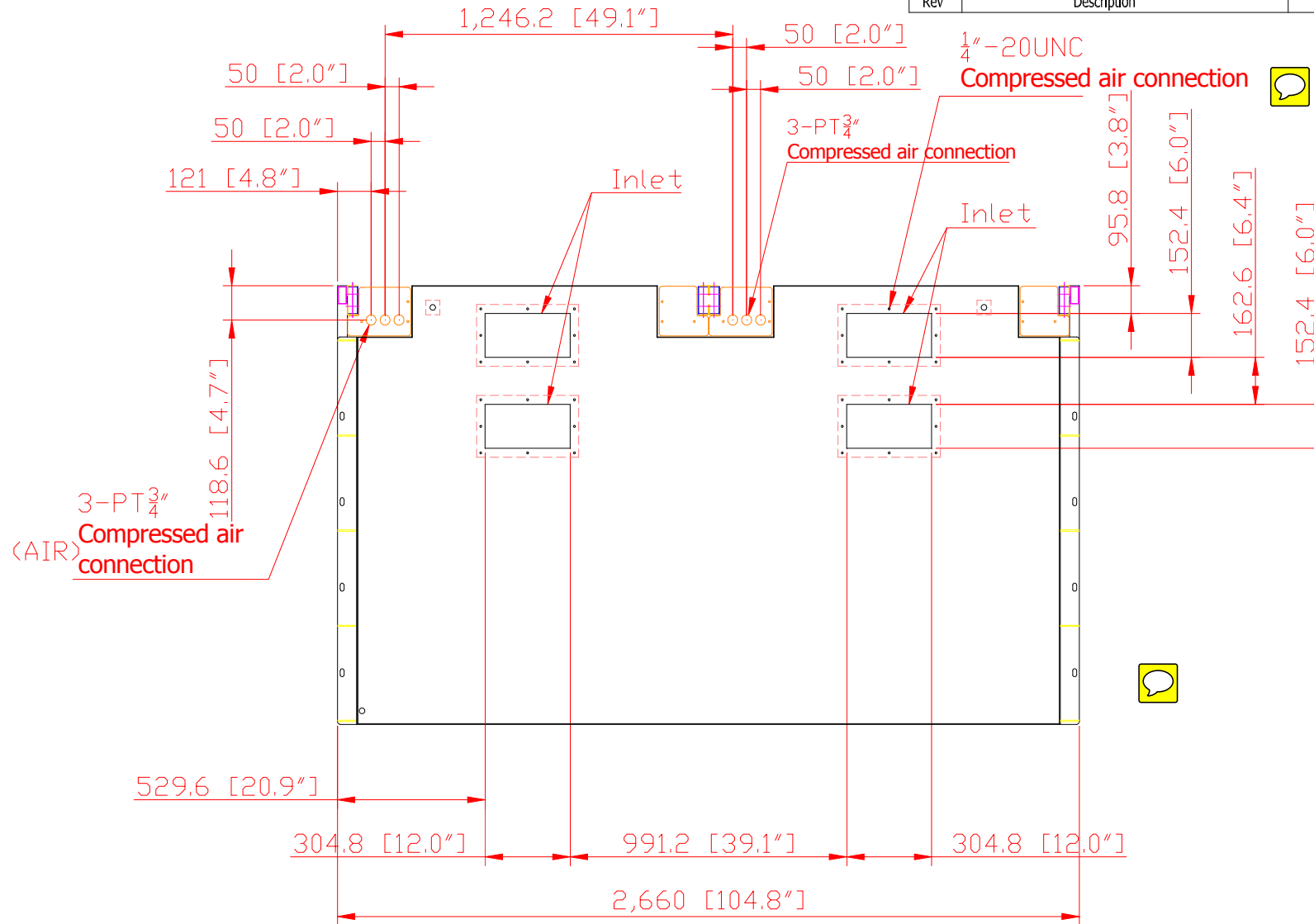

AVANI ENVIRONMENTAL INTL. INC. Sales Department  
 95 Cypress Drive  
 Youngsville, NC 27596  
 (919) 570-2862  
 info@avanienvironmental.com

	Date	Name	Part Number:	Title:
Drawn by:	2015-02-24	***	Position I	WB-5810
Checked by:				Inlet and Compressed Air Connection position.
The drawings, AutoCAD, 3-D Models, and specifications are the property of Avani Environmental Intl. Inc. (AE) and may not be reproduced, distributed, modified, or otherwise used, except provided herein, without the express written permission of AE.				Size <b>B</b>

Scale  
1 = 35

Drawing Number:  
REVISION B

DO NOT SCALE

IF IN DOUBT ASK

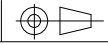

Revisions			
Rev	Description	Date	Approved

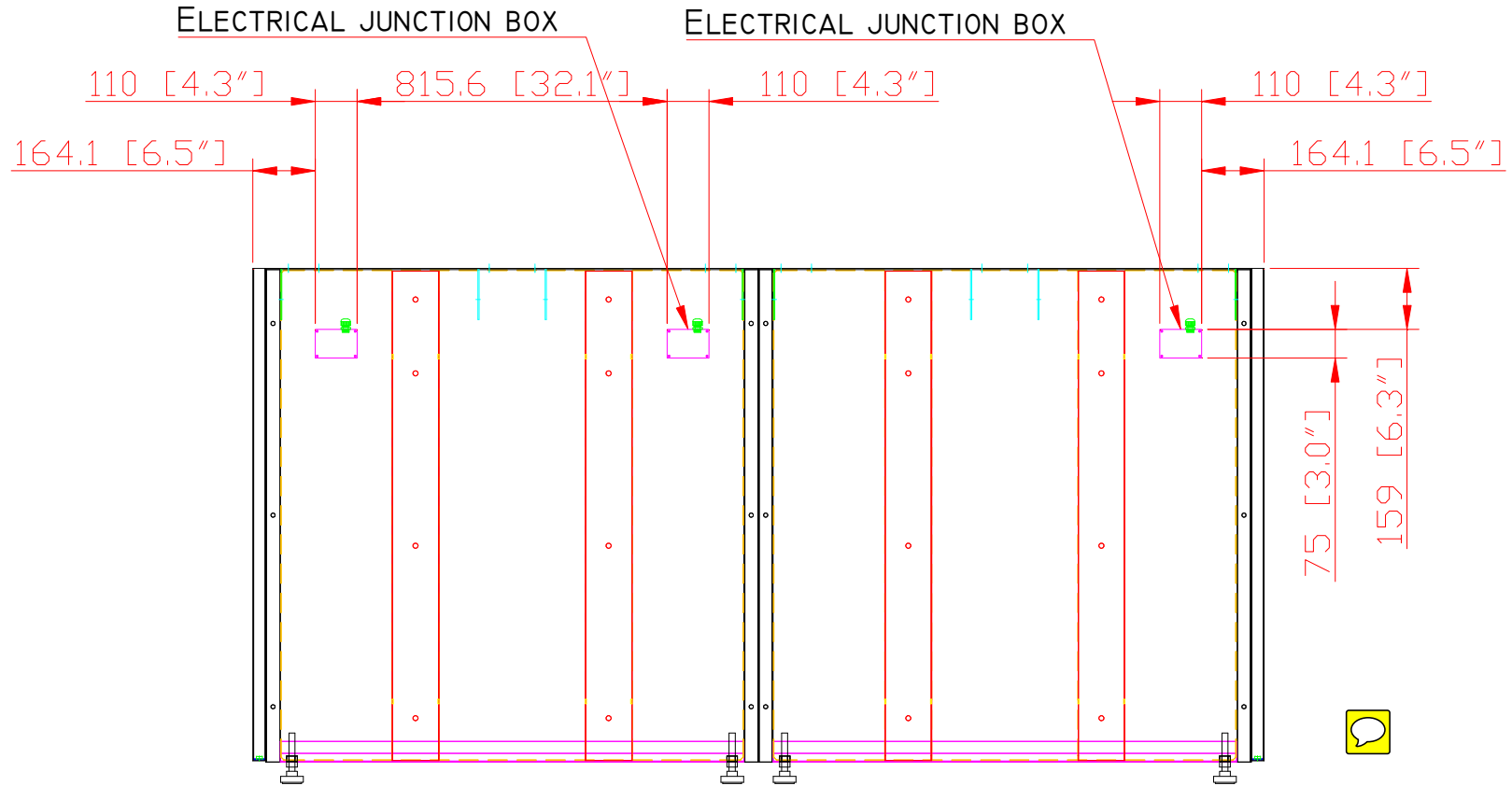

AVANI ENVIRONMENTAL INTL. INC. Sales Department  
 95 Cypress Drive  
 Youngsville, NC 27596

(919) 570-2862  
 info@avanienvironmental.com

	Date	Name	Part Number:	Title: <b>WB-5810</b>	
Drawn by:	2015-02-24	***	<b>Position I</b>	Electrical Junction Box position.	
Checked by:				Size	Scale
The drawings, AutoCAD, 3-D Models, and specifications are the property of Avani Environmental Intl. Inc. (AE) and may not be reproduced, distributed, modified, or otherwise used, except provided herein, without the express written permission of AE.					

DO NOT SCALE

IF IN DOUBT ASK



Revisions			
Rev	Description	Date	Approved

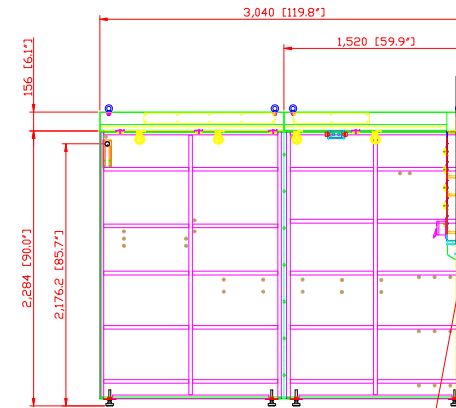
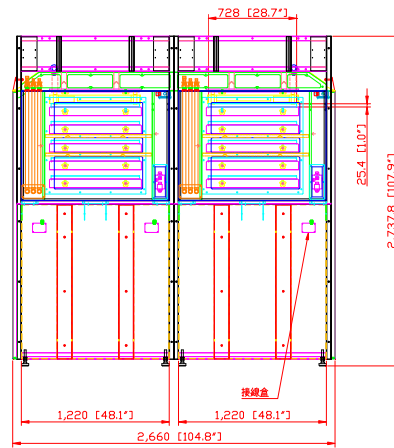
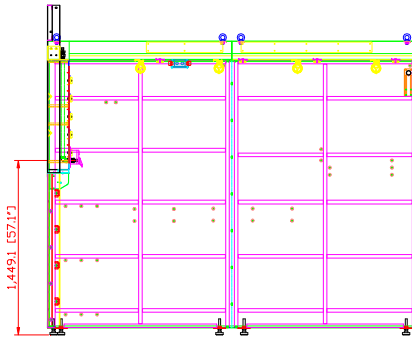
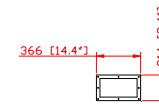
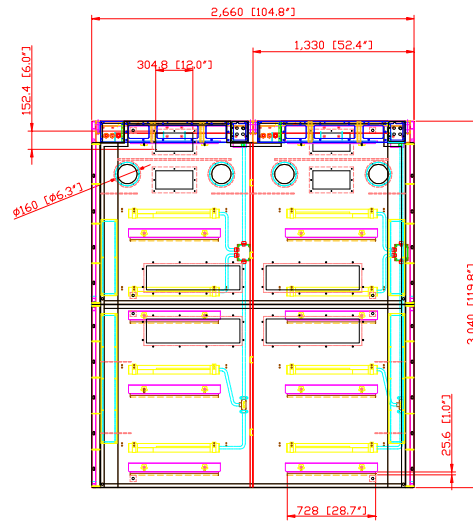

AVANI ENVIRONMENTAL INTL. INC. Sales Department  
 95 Cypress Drive (919) 570-2862  
 Youngsville, NC 27596 info@avanienvironmental.com

Drawn by:	Date	Name	Part Number: <b>REVISION VI</b>
Checked by:	2015-02-24	***	
The drawings, AutoCAD, 3-D Models, and specifications are the property of Avani Environmental Intl. Inc. (AE) and may not be reproduced, distributed, modified, or otherwise used, except provided herein, without the express written permission of AE.			Size <b>A</b>

Title: <b>WB-5087</b>	
Close up on junc. box/gas connect	
Scale 1 = 35	Drawing Number: ***



DO NOT SCALE

IF IN DOUBT ASK

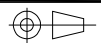

Revisions			
Rev	Description	Date	Approved

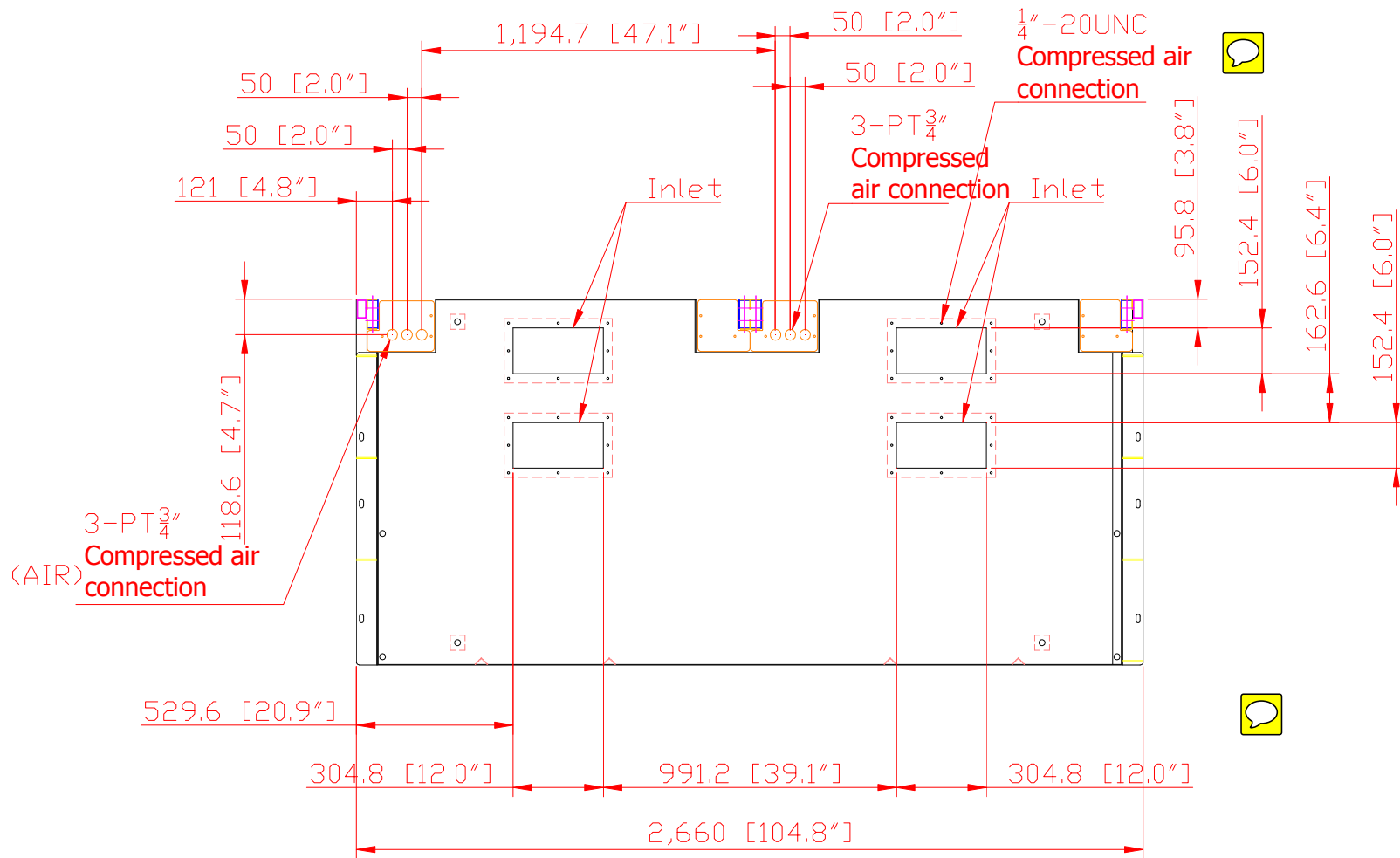

AVANI ENVIRONMENTAL INTL. INC. Sales Department  
 95 Cypress Drive  
 Youngsville, NC 27596  
 (919) 570-2862  
 info@avanienvironmental.com

Drawn by:	Date	Name	Part Number:
Checked by:	2015-02-24	***	Position I
The drawings, AutoCAD, 3-D Models, and specifications are the property of Avani Environmental Intl. Inc. (AE) and may not be reproduced, distributed, modified, or otherwise used, except provided herein, without the express written permission of AE.			

Title:	WB-5087	
Inlet and Compressed Air Connection position.		
Size	Scale	Drawing Number:
B	1 = 35	REVISION B

DO NOT SCALE

IF IN DOUBT ASK

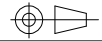

Revisions			
Rev	Description	Date	Approved



ELECTRICAL JUNCTION BOX

ELECTRICAL JUNCTION BOX

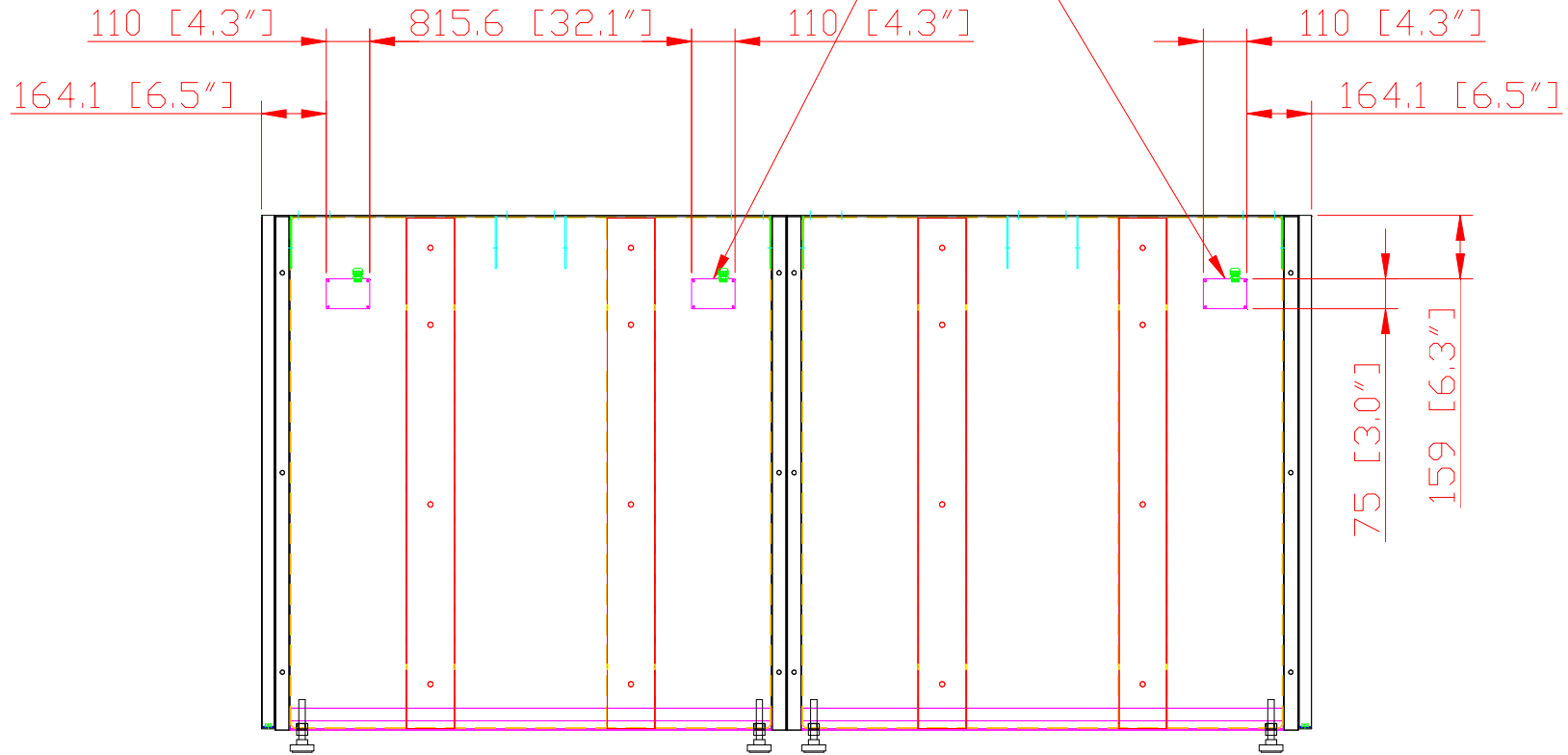

AVANI ENVIRONMENTAL INTL. INC. Sales Department  
 95 Cypress Drive  
 Youngsville, NC 27596  
 (919) 570-2862  
 info@avanienvironmental.com

	Date	Name	Part Number:
Drawn by:	2015-02-24	***	Position I
Checked by:			

Title: **WB-5087**  
 Electrical Junction Box position.

The drawings, AutoCAD, 3-D Models, and specifications are the property of Avani Environmental Intl. Inc. (AE) and may not be reproduced, distributed, modified, or otherwise used, except provided herein, without the express written permission of AE.

Size	Scale	Drawing Number:
<b>B</b>	1 = 35	REVISION B

DO NOT SCALE

IF IN DOUBT ASK

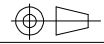

Revisions			
Rev	Description	Date	Approved

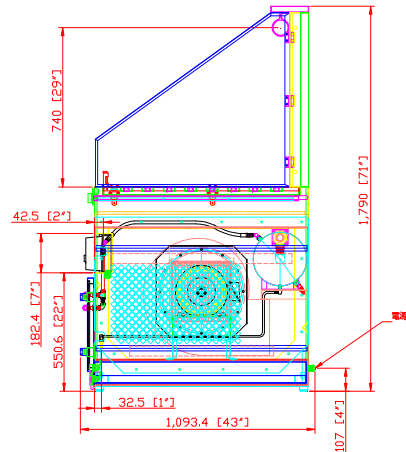
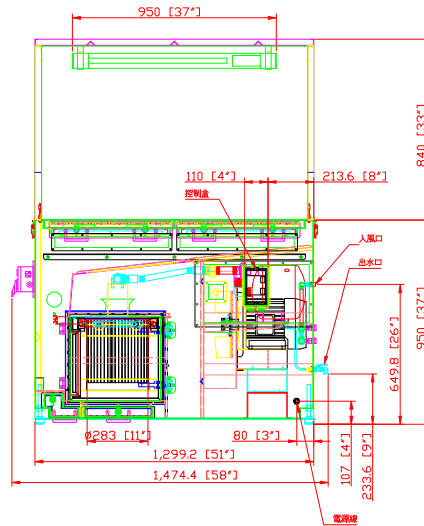
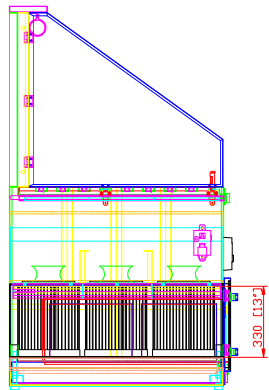
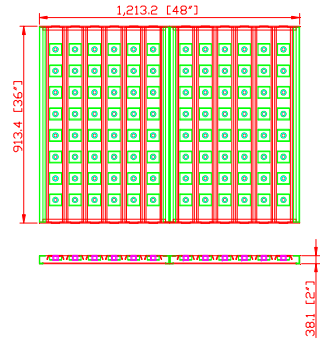
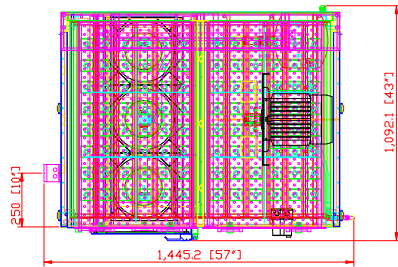

**SDT-5 DOWNDRAFT TABLE SPECIFICATIONS**

- Motor: 5HP
- \*\*\*NEMA Motor
- \*\*\*Aluminum Impeller
- Electric Spec: 230/460V / 60Hz / 3Ph (wired at 460V)  
can be prewired in **ONE** voltage:  
either:  
230V / 60Hz / 3Ph / 8.6A (wired at 230V)  
or  
460V / 60Hz / 3Ph / 4.3A (wired at 460V)
- Airflow: 2340 CFM (3973 m3/hr)

**Filtration Stages:**

1. aluminum mesh x 2 pcs  
- spec: 285 x 423 x 22mm (11.3" x 16.7" x 0.87")
2. Cartridge Filter: DIA. 283 x 330mmL x 3 pcs  
- spec: dia. 283 x 330mmL (dia. 11.2" x 13"L)  
- filtering area: 5m2 x 3 = 15m2 (161.4 ft2)  
- Material: Polyester with TEFLON treatment & coating.

- No. of Valves: 1
- Compressed Air Requirement: 90 PSI
- Compressed Air Reservoir: 2.7 gallon
- Dimension: 58" x 47" x 71"  
(1474.4 x 1185.2 x 1790mm)
- Construction: 14 gauge steel
- Max. Operating Temp.: 120°C
- Paint Color: powder coated Blue
- UL control box
- Manual Air Pulse Jet
- Electrical Outlets: (2) 110V Outlets @ (1) Switch
- Light Switch: For overhead lights
- \*\*\*Overhead Lights: (1) Explosion Proof Lights (110V, Single Phase, 60 Hz, 20W, non-recessed)

**\*\*Design options:**

1. 100% downdraft with no side/back panels
2. 100% downdraft with (2)side (1) back panels
3. 80%/20% with (2) side panels

- \*\*\*no blower outlet to reduce noise
- \*\*\*table top with 16mm fixture holes
- \*\* gauge hole pre-drilled.
- Optiona HEPA filter available.

AVANI ENVIRONMENTAL INTL. INC. Sales Department  
95 Cypress Drive  
Youngsville, NC 27596

(919) 570-2862  
info@avanienvironmental.com

Drawn by:	Date	Name	Part Number: 100% downdraft
Checked by:	2015-02-04	***	

The drawings, AutoCAD, 3-D Models, and specifications are the property of Avani Environmental Intl. Inc. (AE) and may not be reproduced, distributed, modified, or otherwise used, except provided herein, without the express written permission of AE.

Title: <b>SDT-5 downdraft table (grated top with 16mm fixture hole)</b>		
Size <b>A</b>	Scale 1 = 30	Drawing Number: ***

