

US

Users manual

Spray system - Liquid with timer

Part no: 96103005

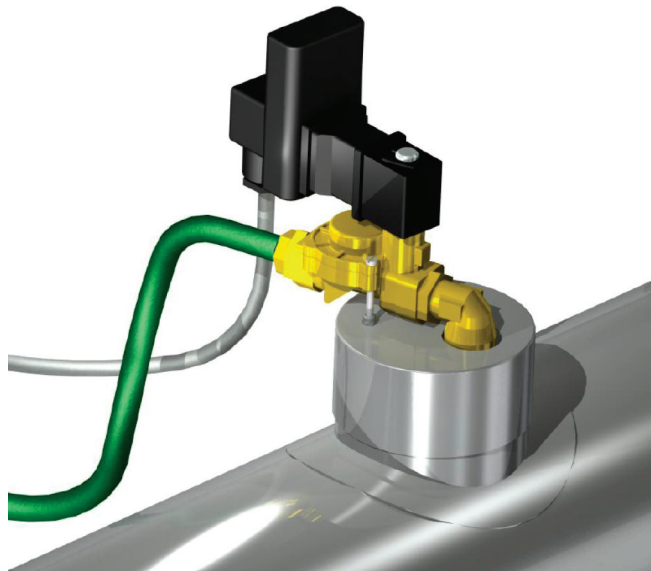

SPRAY



1. GENERAL INFORMATION

1.1 Introduction

This manual contains all necessary information about safety, installation, commissioning and maintenance.

This product is produced and designed in accordance with applicable EC, UL and CSA directives.

To preserve this status, this unit must be installed, repaired and maintained by qualified personnel and genuine spare parts must be used. For advice when technical service or spare parts are needed, contact Absolent Inc. or your nearest authorized dealer. You will find details on who to contact under the heading: "Technical support".



Read and understand the user's manual before beginning work in the filter unit.

1.2 List of contents:

1	General information.....	2
1.1	Introduction	2
1.2	List of contents.....	2
2	Declaration by supplier	2
3	List - Warning signs	3
4	Safety instructions	3
5	Range of application	4
6	Function	4
7	Installation / Wiring.....	4
7.1	Preparations	4
7.2	Electrical wiring.....	5
8	Adjustment.....	5
8.1	General	5
8.2	Adjustment of spray period and pauses	5
8.3	Important parameters to check when .. starting for the first time	5
9	Maintenance / Spare parts	6
9.1	Inspection and service	6
9.2	Spare parts	6
10	Technical support.....	6



2. DECLARATION BY SUPPLIER

Annex IIB



Absolent

Declaration by supplier according to the EC Machinery Directive 98/37/EG, the EC EMC Directive 89/336/EEC as well as the EC LVD Directive 73/23/EEC.

concerning the product **Spray system - liquid with timer**, which is a component in the machine or mounted together with another machine or plant, which together constitute a machine.







The product must not be commissioned until the machine or plant in which it is included, entirely conforms to the demands in the EC's Machinery Directive, EMC Directive and the LVD Directive.

Lidköping, Sweden 2007-11-12

Absolent AB

Tony Landh, CEO

US**3. LIST – WARNING SIGNS**

		<p>Warning - Read the user's manual Read and understand the user's manual before beginning any work in the filter unit. This sign is located on the right-hand side of the filter unit. This sign is located either on the side or back of the filter unit.</p>
		<p>Warning - Dangerous voltage All electrical work must be carried out by qualified electricians. This sign is located next to the control cabinet. This sign is located either on the side or back of the filter unit.</p>
		<p>Warning - Risk of injury Caution the filter unit can contain fluids dangerous to health. Refer to the product sheet for the fluids in question before handling. This sign is located either on the side or back of the filter unit.</p>

US**4. SAFETY INSTRUCTIONS**

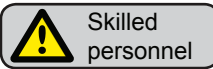
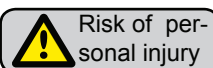
Type of warning	Warning text
	<p>Warning - Hazardous voltage! The filter unit works with a high electrical voltage. The electrical installation must be performed by qualified electricians. Disconnect the power supply to the filter unit before it is opened and/or before starting work on the filter unit.</p>
	<p>Caution - Read and understand the user's manual! Read and understand the user guide before working on the filter unit.</p>
	<p>Risk of slipping! Keep the floor clean. Remove oil spill to prevent injury due to slipping.</p> <p>Dangerous fluids! Use requisite personal safety equipment with all types of service work, as the filter unit can contain fluids dangerous to health. Refer to the product sheet for the fluids in question before handling.</p>

US

5. RANGE OF APPLICATION

General

When the impurities are "too dry" or contain liquid particles with excessively high viscosity (sluggish), the self-cleaning capacity of the filter decreases and its useful life is shortened drastically.

In order to increase the liquid content of the impurities and/or reduce their viscosity, minute drops of liquid are added to the air by means of a spray nozzle. The liquid added must dissolve the impurities that are separated in the filter. Water is used as an emulsifier.

The spray nozzle is mounted on the inlet duct of the filter. The spray nozzle is controlled by a time relay with adjustable pauses and spray periods. The spray system has a standard setting for **4-second spray periods and a 4-minute pauses**. After a certain period of use, the filter should be inspected, in order to see whether the quantity of liquid is correct.

US

6. FUNCTION

Function

The spray system consists of the following parts:

1. Duct connection
2. Spray nozzle
3. Solenoid valve, liquid (24VDC or 254VAC)
4. Flexible tube connection, liquid
5. Liquid filter (accessory)

The spray system is mounted on the inlet duct of the filter. The atomized liquid mixes into the polluted air from the machine and wets the impurities, thus guaranteeing the performance of the filter.

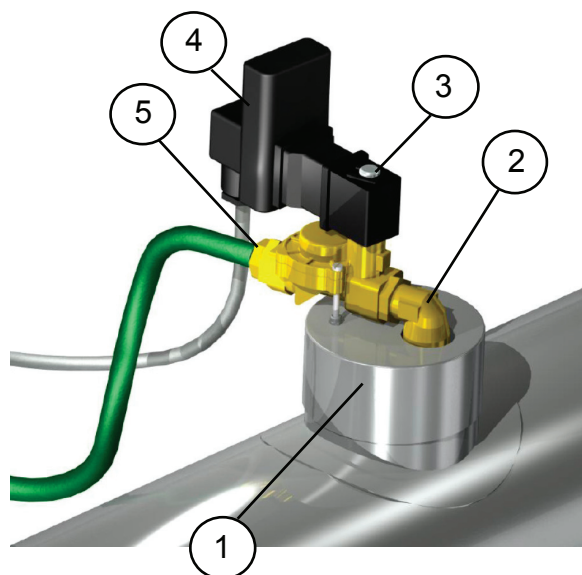
**US**

7. INSTALLATION / WIRING



Highly dangerous voltage!

All electrical work must be carried out by qualified electricians.

7.1 Preparations

- The spray system is mounted on the inlet duct of the filter unit. The spray system can be mounted directly next to the filter unit or up to 3 metres upstream of the filter unit.
- Before fluid is added to the system, the fluid pipe work has to be carefully cleaned from metal swarfs that might come from cutting of the pipes. If this is not done, the spray nozzle might get clogged.
- Clean water or other suitable liquid must be supplied to the spray system. If the purity of the liquid is uncertain, a liquid filter should be fitted upstream of the solenoid valve. The water pressure should be normal system pressure (3-4 Bar).

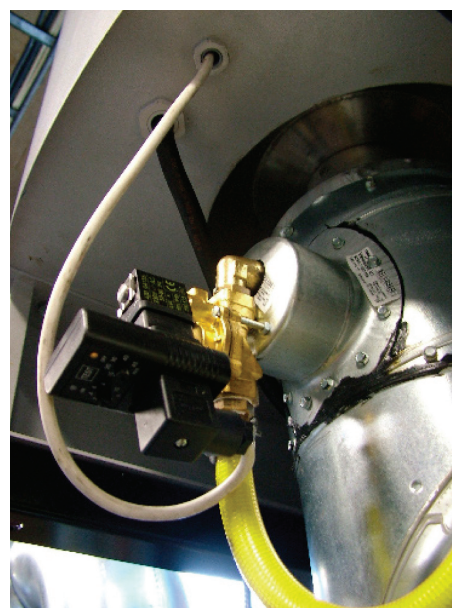



- The solenoid valve is controlled by the integrated timer. The power supply to the timer has to be disconnected when the filter unit has been shut off.

7.2 Electrical wiring

Connect the solenoid valve according to below specification:



- 1 24V DC or 254V AC
- 2 Neutral (N)
- 3 Earth

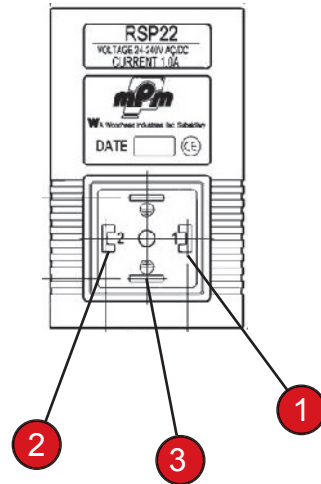

US

8. ADJUSTMENT

8.1 General

The spray systems that are supplied as an accessory the Absolent filter units are factory-preset for **4 second long spray periods and a 4-minute pause in between**. This setting works well in most applications. Nevertheless the performance of the system should be checked after a few days of operation to determine whether the setting is correct for the current application. This can be done by checking how much liquid is drained from the filter. 1-2 litres of liquid should be drained every 24-hour period. Larger quantities do no harm, but they create unnecessarily large amounts of dirty water that require purifying. Smaller quantities involve risk that the filter's drainage and self-cleaning capacity will be too little and this will shorten the useful life of the filter. Note, however that it may take one to two days before the filter starts to drain.

8.2 Adjustment of spray periods and pauses

The relay has been preset to the following values:

Spray period: 4 s
Pause period: 4 min

The periods can be set as follows:

- 1 Knob 1: Spray period (spraying time) in seconds
- 2 Knob 2: Paus period in minutes

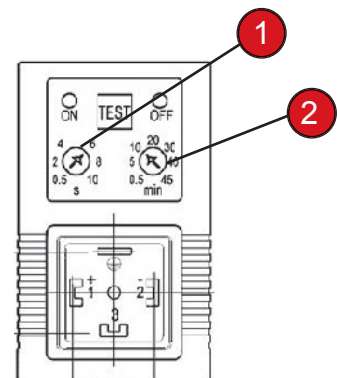

8.3 Important parameters to check when starting for the first time

When the fluid volume is to your satisfaction, disconnect the spray system from the duct work and check that the nozzle is spraying a fine mist.

US**9. MAINTENANCE / SPARE PARTS****9.1 Inspection and maintenance**

The spray system requires no service if the supply liquid is clean. However the system should be checked at regular intervals to make sure that its spray looks OK. When the system is new, it should be inspected every month. After a few months, when you see the system is functioning properly, one inspection every months will be enough. If you notice that the jet from the nozzle is uneven, has become smaller or stopp completely, disassemble the nozzle and blow it clea with compressed air.

9.2 Spare parts

- | | |
|-------------------------------------|--------------------|
| 1. Solenoid valve | part. no. 99703110 |
| 2. Coil 254VAC | part. no. 99703111 |
| (also available as 24VDC, 99703113) | |
| 3. Nozzle | part. no. 99703150 |
| 4. Timer | part no.99703131 |

All threaded fittings, except the the nozzle, must be sealed with thread tape.

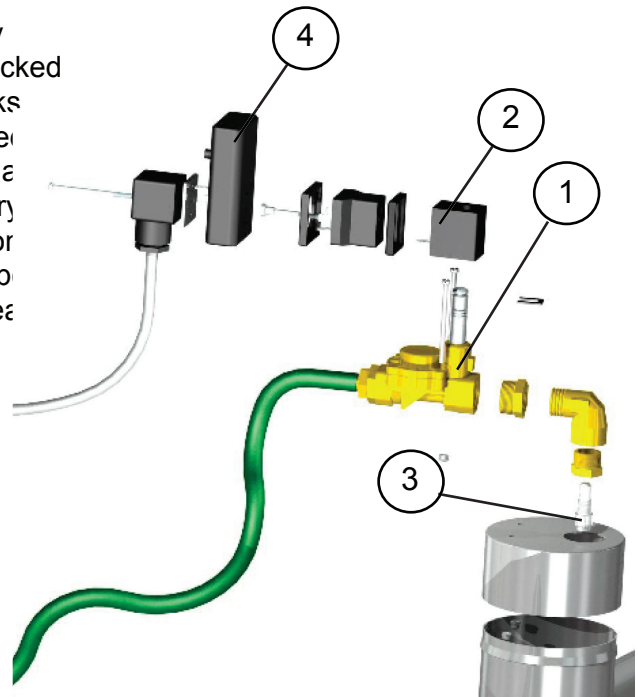
**US****10. TECHNICAL SUPPORT**

Absolent offers you a complete range of spare parts and full service. This ensures reliable performance in your installation.

Main Office

Absolent Inc
8601 Six Forks Road, Suite 400
Raleigh, NC 27615
USA
Telephone: +1 (919) 882 2075
Fax: +1 (919) 882 2087
Website: www.absolent.com

Dealer:

--