



ODF Oil Smoke Filters

The Absolent type ODF-S Oil smoke filter features one of the most effective systems in the world for cleaning oil mist and oil smoke. The series includes ODF 1000S and ODF 2000HPS for air flows up to 500m³/h respectively 1000m³/h. The filter units are designed for handling moderate levels of oil smoke from for example turning or grinding.

The highest possible collecting efficiency.

The filtered air becomes so clean that it usually can be returned to the premises. This means less loss of energy and a more balanced ventilation.

Designed for oil smoke.

Oil smoke particles are very small, smaller than 1.0µm. Other filter types, as for example centrifugal filters, have difficulties with small particles. The Absolent filter unit is designed just for this purpose.

Extremely low maintenance.

Absolent filter units can usually run for at least one year without requiring a filter change. This results in a low total cost of ownership.

A very reliable filter unit.

The fan, as the only moving component, is placed at the clean-side to minimize wear&tear.

Extremely low noise level for agreeable working conditions

*Does not apply for the HEPA filter.

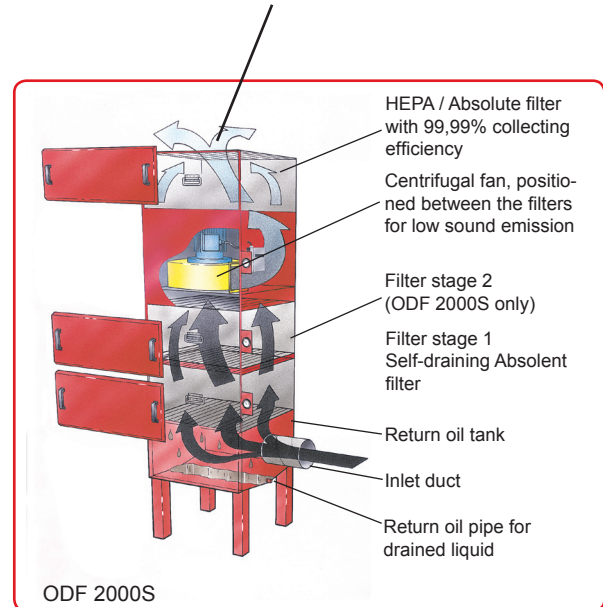

Operation

The filtering process occurs in two (ODF 1000S) respectively three (ODF 2000S) stages. The process air passes first through the self-draining Absolent filter cassettes. Here, a minimum of 95% of the oil mist and smoke is arrested. The last stage consists of a HEPA filter, which has a guaranteed and consistent collecting efficiency of 99.99% arresting 0.3 µm dia. particles. Every filter stage has a pressure gauge that indicates when a filter change is necessary. Thanks to the continuous draining of the filter cassettes, the unit can be operated without interruptions. The return oil is collected at the bottom of the filter for recycling.

Range of Application

The Absolent ODF-S is well suited for use in applications such as:

- Cold-drawing
- Gear cutting
- Grinding with neat oil
- CNC turning with neat oil

Design

The ODF-S has a highly robust tower design that occupies a minimum of floor space. Its hinged access doors make service still more convenient. The filter is supplied with a baked powder painted finish that adds colour to the shop floor.



ODF 2000S

ODF 1000S

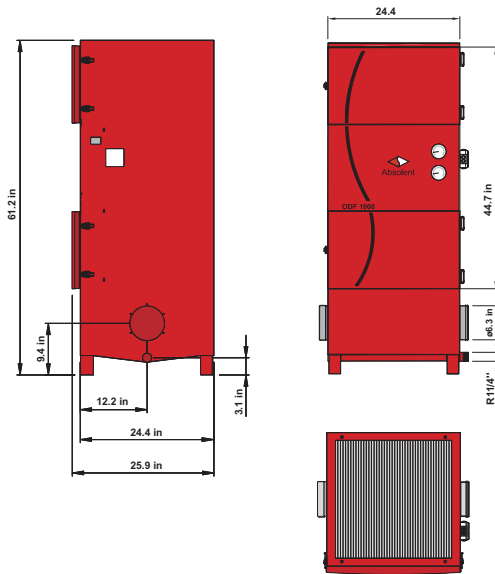

ODF 2000S

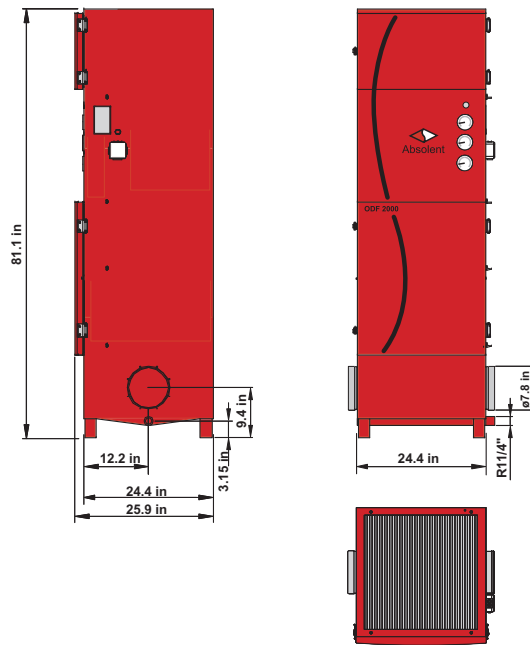



Technical data		ODF 1000S	ODF 2000S
Max permissible air volume	[cfm]	295	590
Sound level, 1m in front of filter unit ¹⁾	[dB(A)]	64	72
Weight (dry filters)	[lbs]	254	485
Available dim. ext. pressure drop	[Pa]	< 50	50
Filter area, filter 1 (Absolent filter)	[ft ²]	70	55 ²⁾
Filter area, filter 2 (Absolentfilter)	[ft ²]	-	70 ²⁾
Filter area, filter 3 (HEPA-filter)	[ft ²]	219	219

Fan Data		ODF 1000S	ODF 2000S
Motor output	[hp]	0.85	3.5
Rated current (3-Phase)	[A]	1.26	4.6
Power supply (3-Phase)	[V]	440-480	440-480
Speed	[rpm]	3400	3400

¹⁾ Sound absorption in premises = 2153ft², Hemispherical sound propagation. For sound calculation concerning a specific room, contact us at Absolent or any of our dealers.

²⁾ The filter area varies for different applications.

Standard Equipment

- Colour  Red (RAL 3000)  Grey (RAL 7032)
- Pressure gauges for reading the pressure drop across the filter

Accessories

- Motor starter for fan. Either a manual or protective motor contactor (for automatic or external starting)
- Outlet hood
- Carbon filter
- Duct connections for steel or plastic ductwork

- Extension legs, (standard height 400 mm)
- Water trap for various connections of the return oil pipe
- Pump unit for pumping the return oil from the filter
- Sound insulation (-3 dB)
- Extra outlet silencers (-2 dB)
- Pressure monitor, for external alarm or alarm indications with LED
- Special colours

Sound level ODF 1000S, dB(A)¹⁾

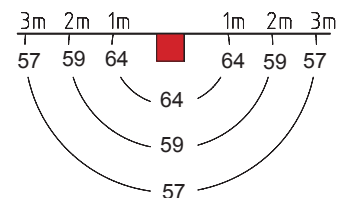

Sound level ODF 2000S, dB(A)¹⁾

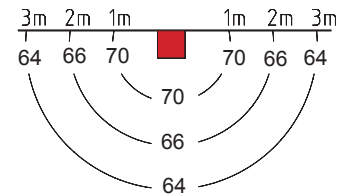

Unique filter cassettes



Absolent is one of few companies in this line of business that has specialized in the filtration of air containing wet particles. This has given us the opportunity to develop a filter cassette that offers a long useful life with consistently high collecting efficiency.



Absolent AB
Kartåsgatan 1
SE-531 40 Lidköping
Sweden
Phone: +46 (0)510-484000
Fax: +46 (0)510-484029
E-mail: info@absolent.se

Absolent Inc.
8601 Six Forks Road, Suite 400
Raleigh, NC 27615
USA
Phone: +1 (919) 562 0502
Fax: +1 (919) 882 2087
E-mail: info@absolent.com

Dealer: