



# ODF Tower Oil Mist Filters

The Absolent type ODF oil mist filter features one of the most effective systems in the world for cleaning oil mist.

This cut sheet includes ODF 1000 and ODF 2000 for air flows up to 590cfm respectively 1180cfm. The filter units are being placed adjacent to one or several machines.

### The highest possible collecting efficiency.

The filtered air becomes so clean that it usually can be returned to the premises. This means less loss of energy and a more balanced ventilation.

### Extremely low maintenance.

Absolent filter units can usually run for at least one year without requiring a filter change. Moreover, ODF filter cassettes can usually be washed.\* This results in a low total cost of ownership.

### A very reliable filter unit.

The fan, as the only moving component, is placed at the clean-side to minimize wear&tear.

**Extremely low noise level** for agreeable working conditions.

\*Does not apply for the HEPA filter.

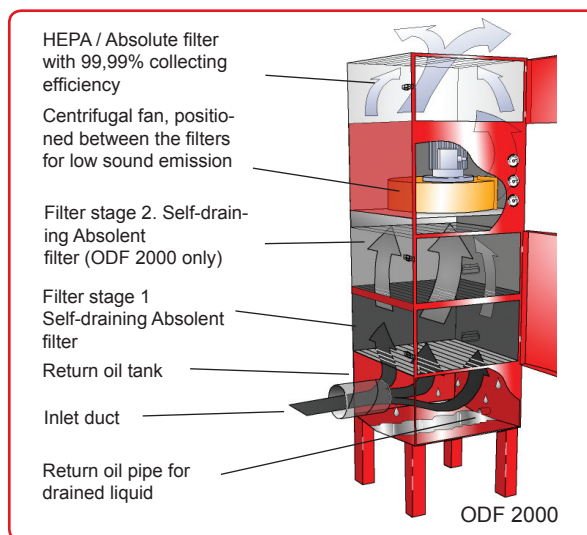

### Operation

The filtering process occurs in two (ODF 1000) respectively three (ODF 2000) stages. The process air passes first through the self-draining Absolent filter cassettes. Here, approximately 90% of the oil mist is arrested. The last stage consists of a HEPA filter, which has a guaranteed and consistent collecting efficiency of 99.99% arresting 0.3 µm dia. particles. Every filter stage has a pressure gauge that indicates when a filter change is necessary. Thanks to the continuous draining of the filter cassettes, the unit can be operated without interruptions. The return oil is collected at the bottom of the filter for recycling.

### Range of Application

The Absolent ODF is well suited for use in applications such as:

- Grinding (cutting fluid emulsion)
- Turning (cutting fluid emulsion)
- Milling (cutting fluid emulsion)
- Electrical discharge machining
- Machining, using straight oil and moderate loads

### Design

The ODF has a highly robust tower design that occupies a minimum of floor space. Its hinged access doors make service still more convenient. The filter is supplied with a baked powder painted finish that adds colour to the shop floor.



ODF 2000

## ODF 1000

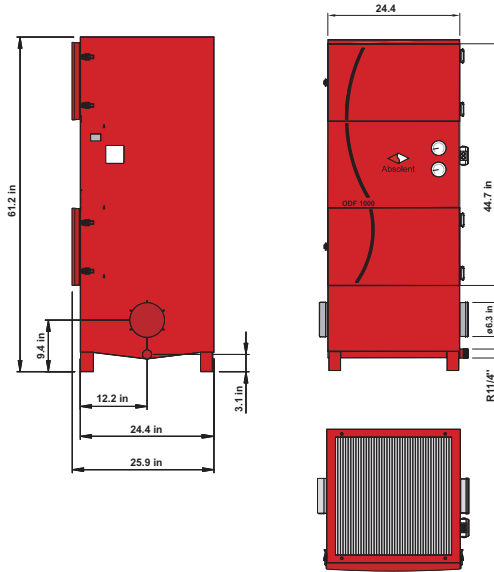

## ODF 2000

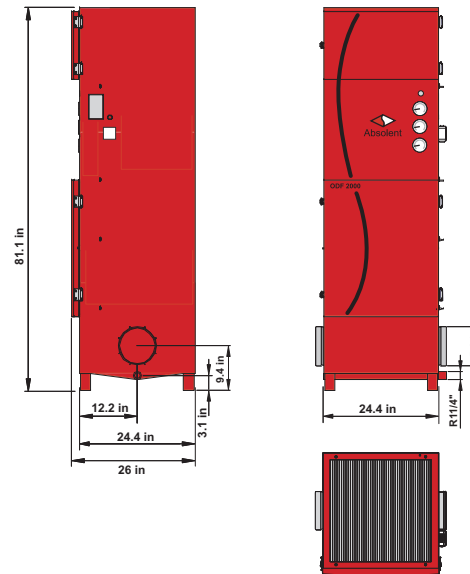

### Technical data

		ODF 1000	ODF 2000
Max permissible air volume	[cfm]	590	1180
Sound level, 1m in front of filter unit <sup>1)</sup>	[dB(A)]	64	70
Weight (dry filters)	[lbs]	253	474
Available dim. ext. pressure drop	[Pa]	125	500
Filter area, filter 1 (Absolent filter)	[ft <sup>2</sup> ]	138	154 <sup>2)</sup>
Filter area, filter 2 (Absolentfilter)	[ft <sup>2</sup> ]	-	138 <sup>2)</sup>
Filter area, filter 3 (HEPA-filter)	[ft <sup>2</sup> ]	219	219



### Fan Data

Motor output	[hp]	0.85	3.5
Rated current (3-Phase)	[A]	1.26	4.6
Power supply (3-Phase)	[V]	440-480	440-480
Speed	[rpm]	3400	3400

<sup>1)</sup> Sound absorption in premises = 2153ft<sup>2</sup>, Hemispherical sound propagation. For sound calculation concerning a specific room, contact us at Absolent or any of our dealers.

<sup>2)</sup> The filter area varies for different applications.

### Standard Equipment

- Colour  Red (RAL 3000)  Grey (RAL 7032)
- Pressure gauges for reading the pressure drop across the filter

### Accessories

- Motor starter for fan. Either a manual or protective motor contactor (for automatic or external starting)
- Outlet hood
- Carbon filter
- Duct connections for steel or plastic ductwork

- Extension legs, (standard height 15.7 in)
- Water trap for various connections of the return oil pipe
- Pump unit for pumping the return oil from the filter
- Sound insulation (-3 dB)
- Extra outlet silencers (-2 dB)
- Pressure monitor, for external alarm or alarm indications with LED
- Special colours

### Sound level ODF 1000, dB(A)<sup>1)</sup>

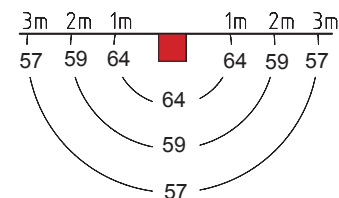

### Sound level ODF 2000, dB(A)<sup>1)</sup>

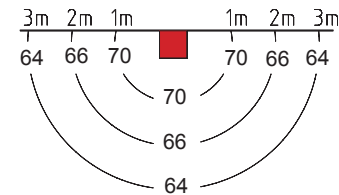

### Unique filter cassettes



Absolent is one of few companies in this line of business that has specialized in the filtration of air containing wet particles. This has given us the opportunity to develop a filter cassette that offers a long useful life with consistently high collecting efficiency.



**Absolent AB**  
Kartåsgatan 1  
SE-531 40 Lidköping  
Sweden  
Phone: +46 (0)510-484000  
Fax: +46 (0)510-484029  
E-mail: info@absolent.se

**Absolent Inc.**  
8601 Six Forks Road, Suite 400  
Raleigh, NC 27615  
USA  
Phone: +1 (919) 562 0502  
Fax: +1 (919) 882 2087  
E-mail: info@absolent.com

Dealer: